



- Cuts down fitting time from 25 to 5 minutes
- 100% accurate - with auto alignment
- Reduced number of tools required
- Minimal chiselling required
- Pre-assembled to fit 35mm doors
- Unique patented 'North-South' fixings
- Passage and Privacy packs available
- Easy push-fit levers

THE JIGTECH CLICK SYSTEM:



CLICK FITTING INSTRUCTION MANUAL

Only compatible with Jigtech tubular latch and door furniture.

FITS IN UNDER 5 MINUTES. 100% ACCURATE. PRECISION FITTING EVERY TIME.

THE SMART DOOR HANDLE FITTING SYSTEM

JIGTECH



01 Ensure door is hung and wedged securely.

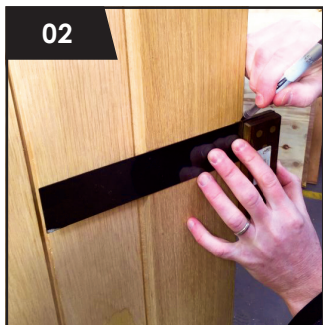

02 Measure and mark the door handle height. One metre from floor level is typical.



03 Adjust the backset on the jig to suit tubular latch specification – 45mm or 57mm.
For Jigtech latches, remove the green reducing sleeve from the latch bore hole on the Jig.
 Align the jig with the height mark. Clamp the jig to the door securely without over tightening.



04 Fit the 25mm hole saw and arbor. Ensuring the drill is level, bore out the latch hole.



05 Fit the 44mm hole saw and arbor. Ensuring the drill is level, drill through the guide side of the jig.
 Withdraw the holesaw to clear debris during drilling. Once the drill tip exits the door on the opposite face retract the drill and remove the jig.
TIP: reset the jig by clearing debris from the threads and winding it back to the fully closed position.



06 With the jig removed, ensuring the drill is level, drill through from the opposite side using the exit hole as a guide.
 Then clear the debris from the bore holes.





07

Using the 32mm Spade bit, place the point in the mark on the frame. Drill out the frame to the depth indicated on the spade bit.



08

Clear the debris from the hole.



09

Check the socket fits into the hole and allows 1mm depth for the striking plate to be fitted. Secure the socket in place with the screws provided.

Use pilot holes for hardwoods to prevent screws snapping.



13

Take the sprung cassette and find the small notch on the outer edge.

Make sure it's facing the floor (the sleeves should align vertically and the Jigtech logo should be in the upper left) and slide onto the spindle so the sleeves go through the spacer.



14

Secure the sprung cassette using the two machine screws provided.

TIP: Do not over tighten the screws or damage to the cassette could be caused.



15

Take the second lever and locate the gap in the rose.

Line this up with the notch on the sprung cassette and slide the lever onto the spindle.

Push the lever onto the cassette until it clicks into place.

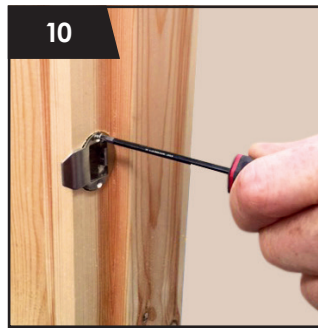

10

Mark and chisel out for the striking plate lip. Fit the striking plate. Close the door and adjust the anti-rattle plates and strike lip to ensure smooth closing action.



11

Place the spacer in the handle bore hole. Check for correct handing. Insert the latch into the latch bore hole. Using a piece of wood to protect the latch and door, cover the latch bolt and tap into the door until the face plate is flush with the door.

TIP: take care not to use excessive force to drive the latch in. If in doubt, re-drill the latch bore with the 25mm holesaw to increase the hole diameter to prevent timber splitting.



12

Select the lever with the spindle and sprung cassette already fitted and align the spindle with the latch follower.

Slide the push-fit sleeves through the spacer.

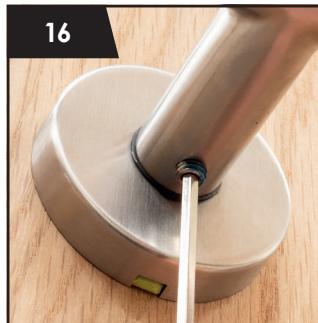

16

Make sure the roses on both levers are flush to the door and tighten the grub screw on the lever you just attached.

The grub screw needs to pierce the spindle so there will be some resistance that you need to tighten through.

TIP: the grub screw will become looser after it pierces the spindle and you can continue to tighten until secure.



17

To remove the handles, untighten the grub screw and use a flathead screwdriver between the rose and cassette to carefully prise off the lever.

