

# Creating a Linear Look

Fitting Application

# LINAPP01



## Raised worktop & split decor ends fitting application

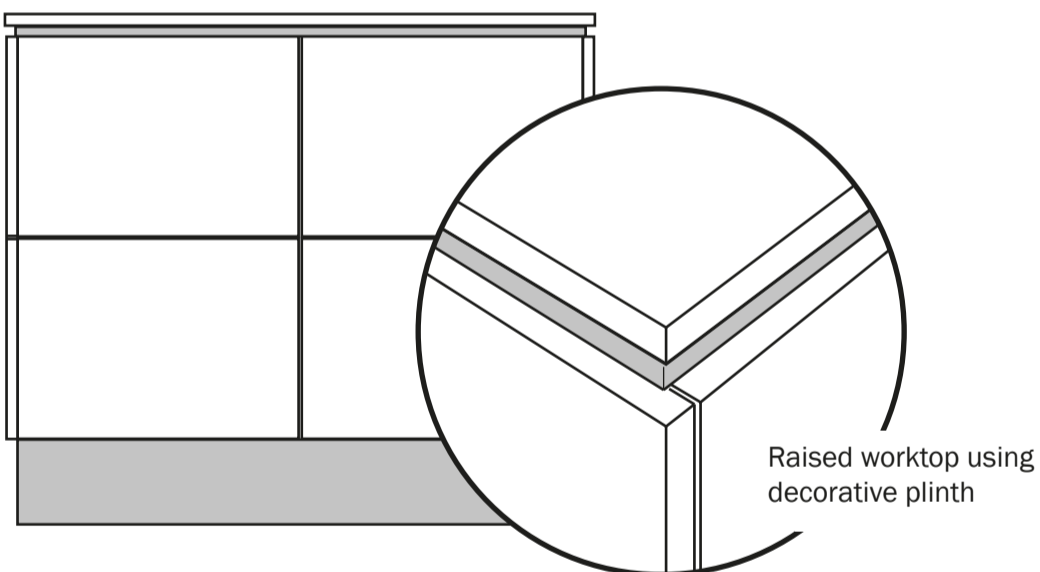

Use this leaflet in conjunction with the kitchen installation manual for cabinet installation.

Cabinets & decor ends should be fitted before cutting and securing the decorative plinth sections to the cabinet.

LED lighting strips can be fitted to the underside of the worktop overhang around the edges. These can be placed into a routed channel or applied direct to the surface.

Use silicone to seal any raw edges around sink and hob cut-outs.

1

Measure the length of the cabinet run (not including the decor panel at each end) adding a 3mm overhang at each end. Measure the return section adding a 3mm overhang at each end.

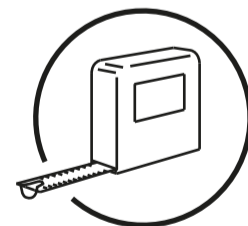
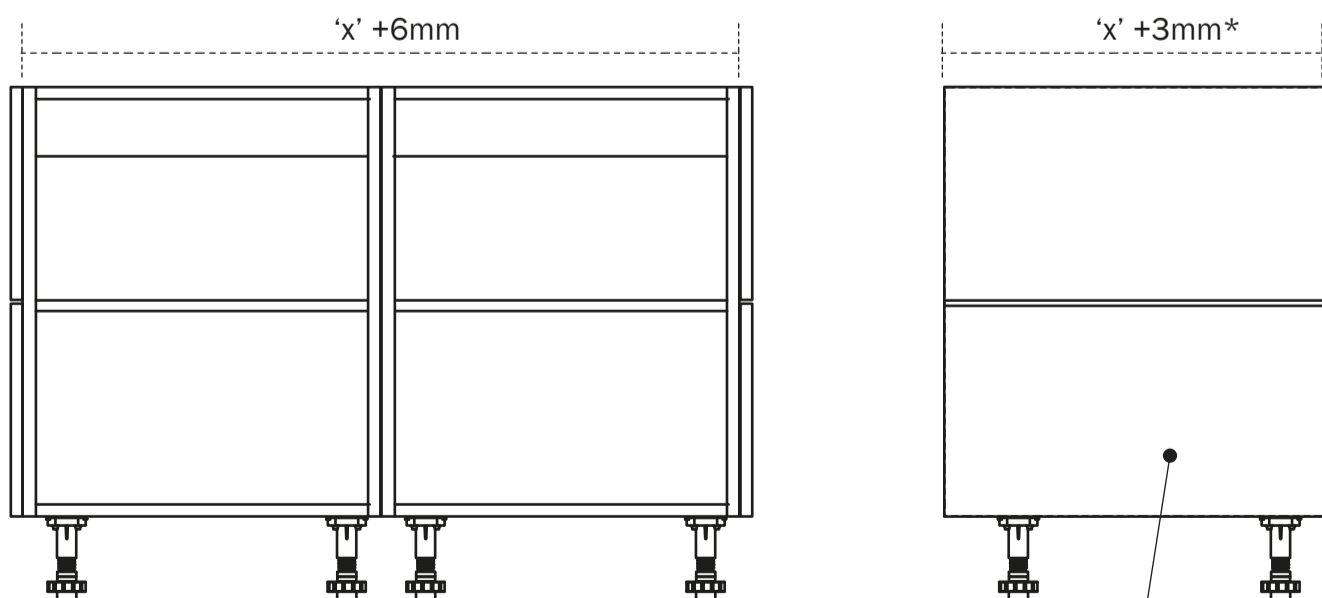

\*For an island application 3mm overhang at each end would be required

**NOTE:** Use 600 Half height frontals (as decor ends), for a split panel return to the wall and return a decorative plinth at the base. Base decor end panels can also be used by cutting and re-edging them for larger island applications. Level & secure the panels from inside the cabinets using 30mm screws.

2

Cut the decorative plinth section in half.

**Note:** Use the finished edge for the front and side of the cabinet. When fixing cabinets to the wall use a section for support at the back. For island application the finished edge will need to run all around.



3

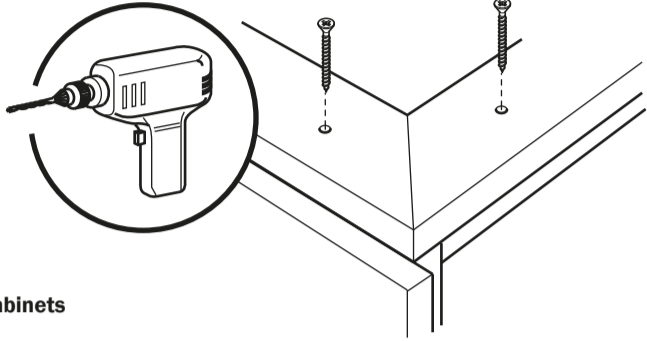

Using the dimensions measured in stage one (X), cut the finished side of the plinth to length, mitering the ends to join the return section. Drill through into the top of the cabinet side panel and front rail to secure using 30mm screws.

**Note:** Additional support under the worktop will be required using a section of the cut plinth. This should run front to back along the cabinet side panels as shown below. Central side to side support should also be used when installing Granite/Quartz worktops.

Back to wall cabinets

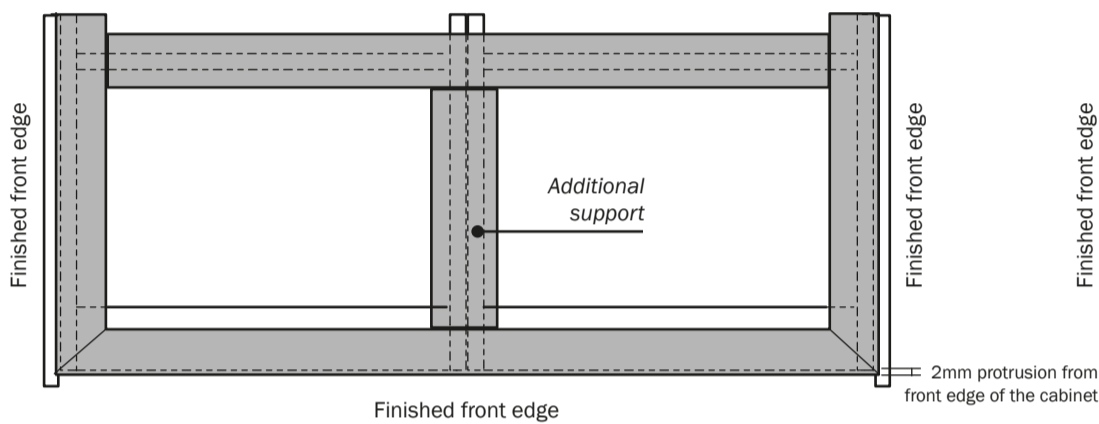

Island application

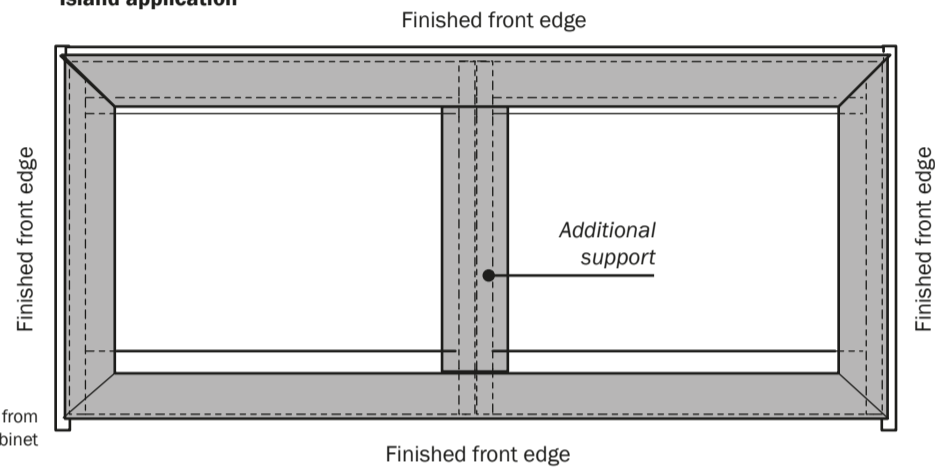

4

Cut and fit the worktop to the cabinet run, aligning the front edge with the frontal and side with decor end panels. A longer screw will be required (50mm) to secure up through the cabinet front rail, plinth and up into the worktop. For Granite/Quartz worktops, use silicone to secure the top.

## Tower cabinet spacing using decorative plinth

1

Cut the length of plinth to the height of the tower cabinet (1942mm or 2122mm). Cut the plinth in half (along the length - see step 2 above) and secure to the side of the cabinet front and back. The front finished edge section should protrude the cabinet by 3mm.

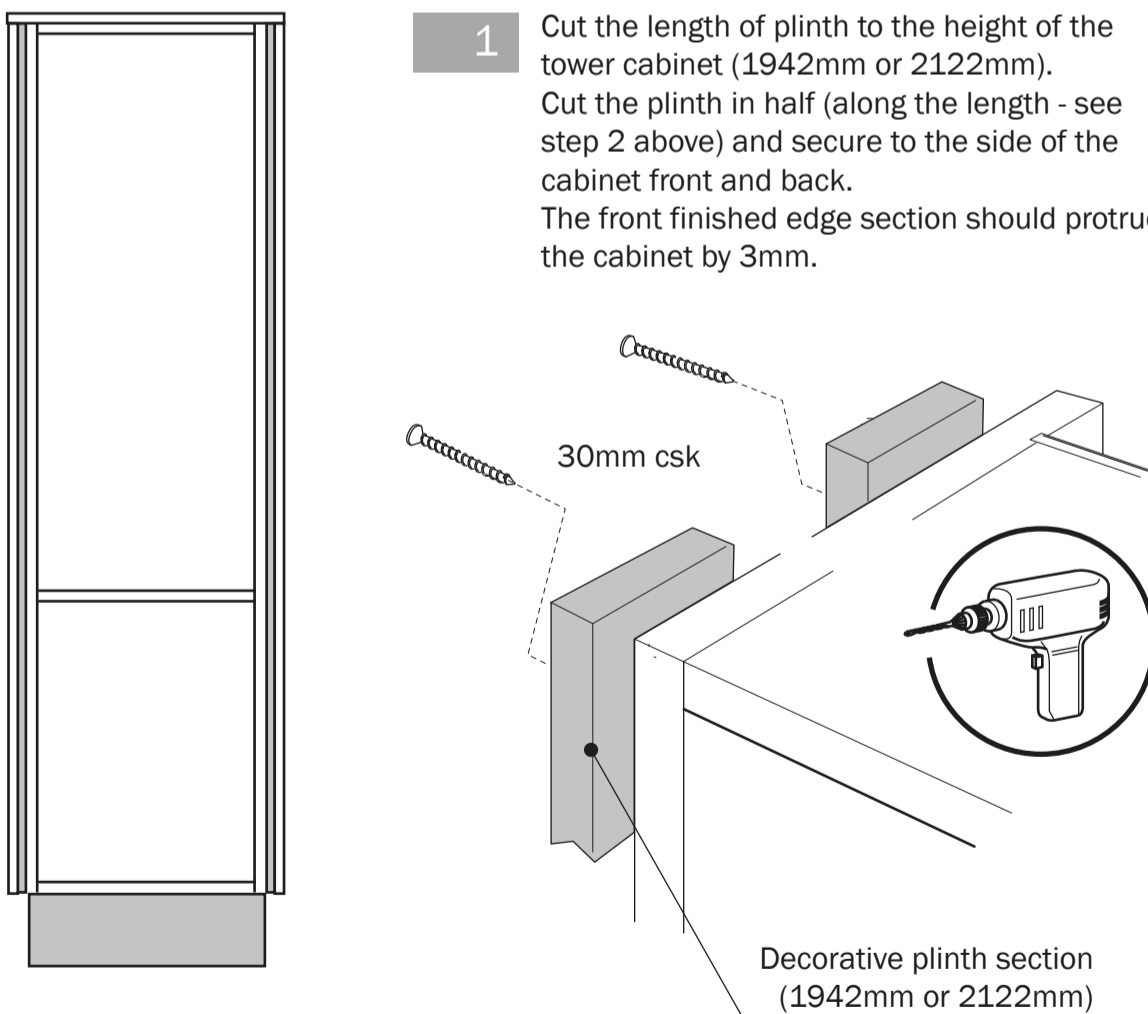

2

Cut & fit the decor end panel to the side of the fitted plinth sections, securing from inside the cabinet and through the plinth sections and into the decor end.

**Note:** Decor end should protrude the cabinet by the thickness of the frontal being fitted.

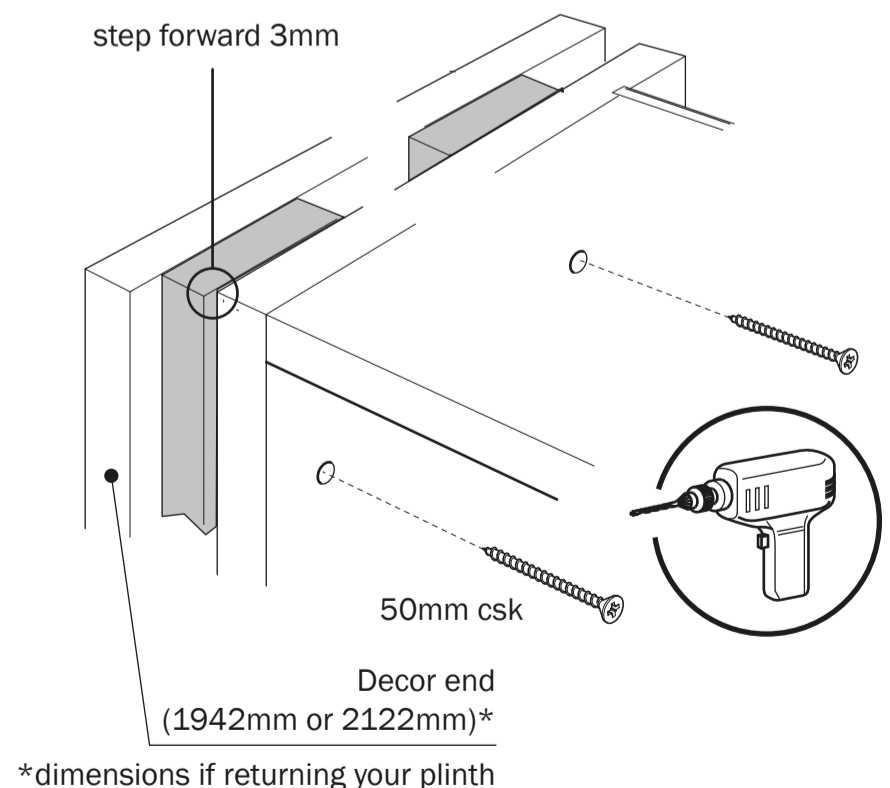

3

Fit the doors, thin handles (where applicable) and return plinths, following the information provided in the kitchen installation manual.

## Return plinth- re-positioning of legs

Cabinet legs at the side of the unit can be moved inwards if a deeper more 'stepped' overhang appearance of the decor end be required. Plastic location dowels at the top of the leg will need to be removed and screw fixings used. Follow the step below.

- 1 Remove the plastic location dowels.

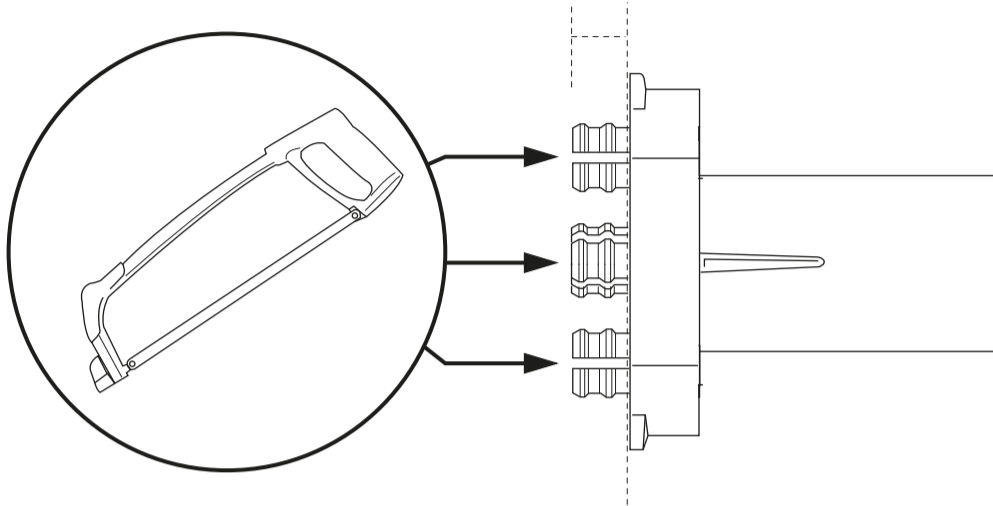

- 2 Position the legs in line with the other leg positions in your cabinet run and stepped in at the side.

Pilot drill and secure through the three fixing holes in the leg top with screws.

Fit the plinth to the cabinet legs following the information in the kitchen installation manual

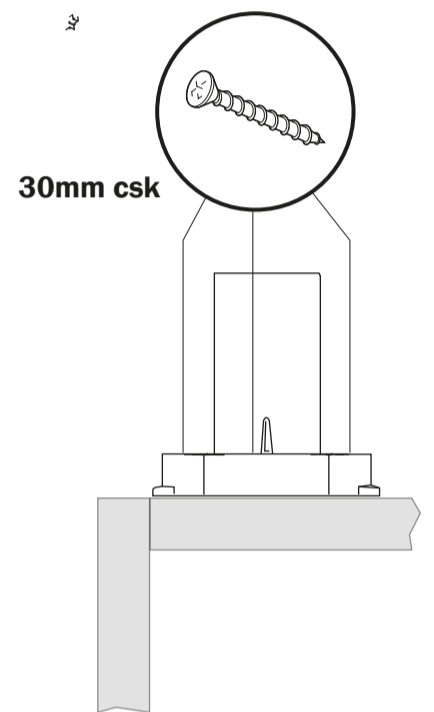
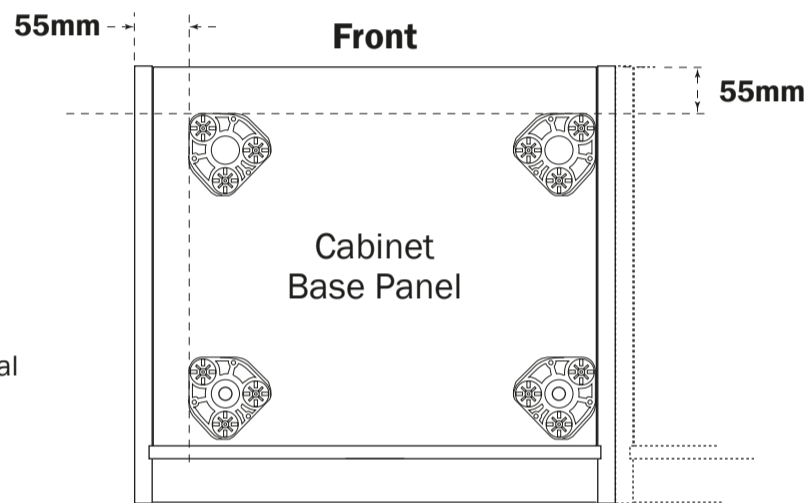

## External Corner Fillet

External corner fillets are available with certain ranges to enable a seamless return to an end panel or island application. Whilst the style of the corner fillets will differ from range to range, the fitting application is the same. The following sheet shows how the corner post is fitted and compliments a raised worktop through the use of profiles.



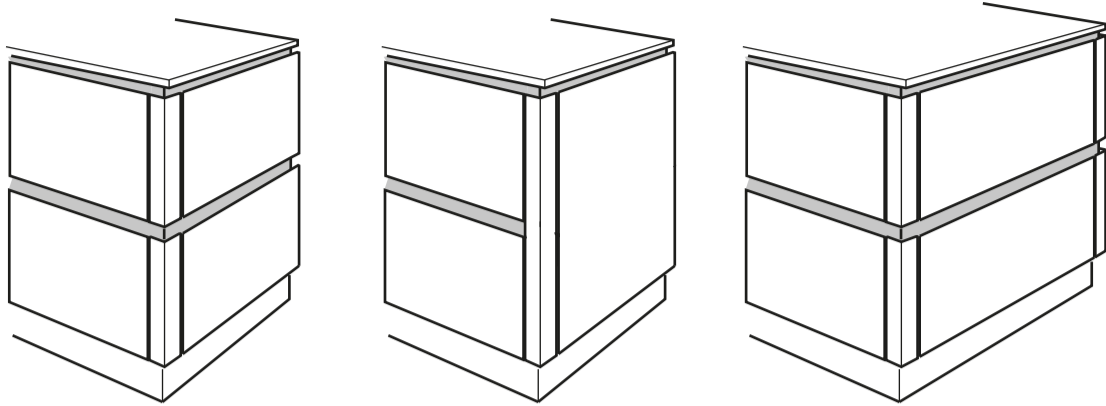

Return to wall

Return to wall  
(solid end)

Island Unit

Illustrations show a Balham kitchen application using the aluminium profiles

## Assembly

- 1 Cut the worktop support rail to size and secure to the cabinet side panel. These rails are to support the worktop and drawer line profiles.

**Side View  
Island application**  
(External fillet front & back edge)

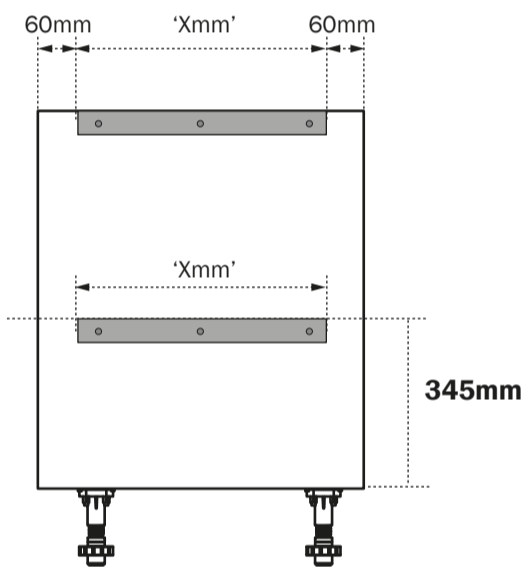

'X' = Dimension of the rail depending on length of island

**Side View  
Return to wall application**  
(External fillet front edge only)

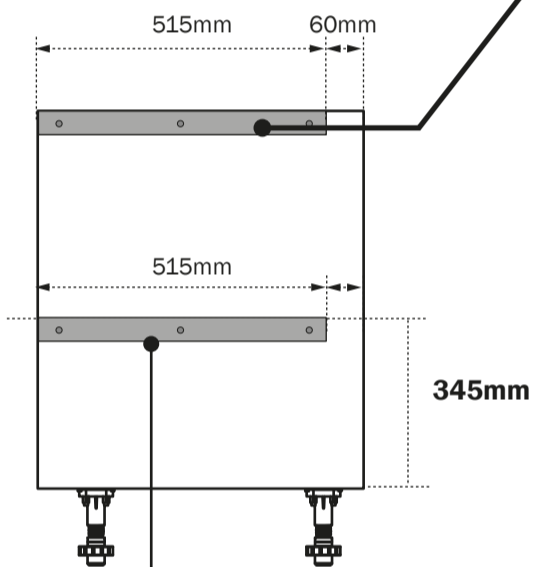

Rail not required if solid decor end being used

**Front of cabinet run**  
(image shown for context of rail/profile positioning)

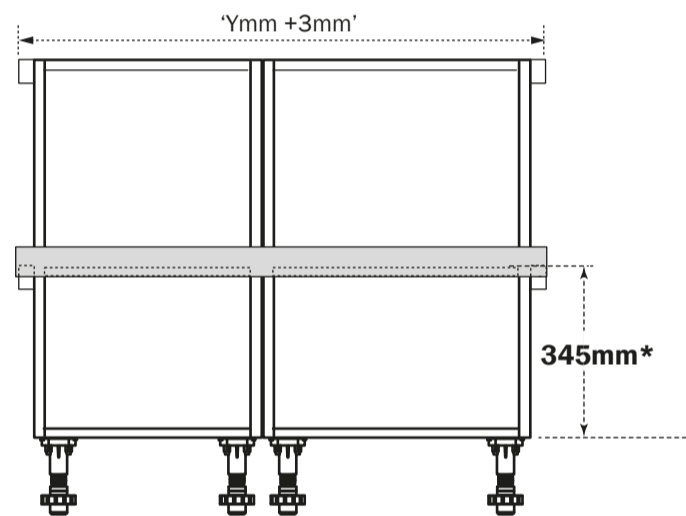

\*to the top of the support rail

**Note:** In an island application, a drawer support rail & worktop rail, may be required to secure to the back of the cabinet to run the profiles all around. This application will be if the island is only one base cabinet in depth.

- 2 Fit the front profile (and back if applicable) to the cabinet. Measure the length of the cabinet run including the worktop rail fitted to the side(s). See measurement 'Y' above. Add 3mm to this dimension. This measurement should be used for the internal mitre cut of your profile.

- 3 Secure the drawer and worktop profiles to the side of the cabinet, mitering with the front profile. For drawer profile fixing, secure through the support rail and into the profile fixing channel. For the worktop profile, drill through the metal and into the top of the support rail.

### Drawer Profile

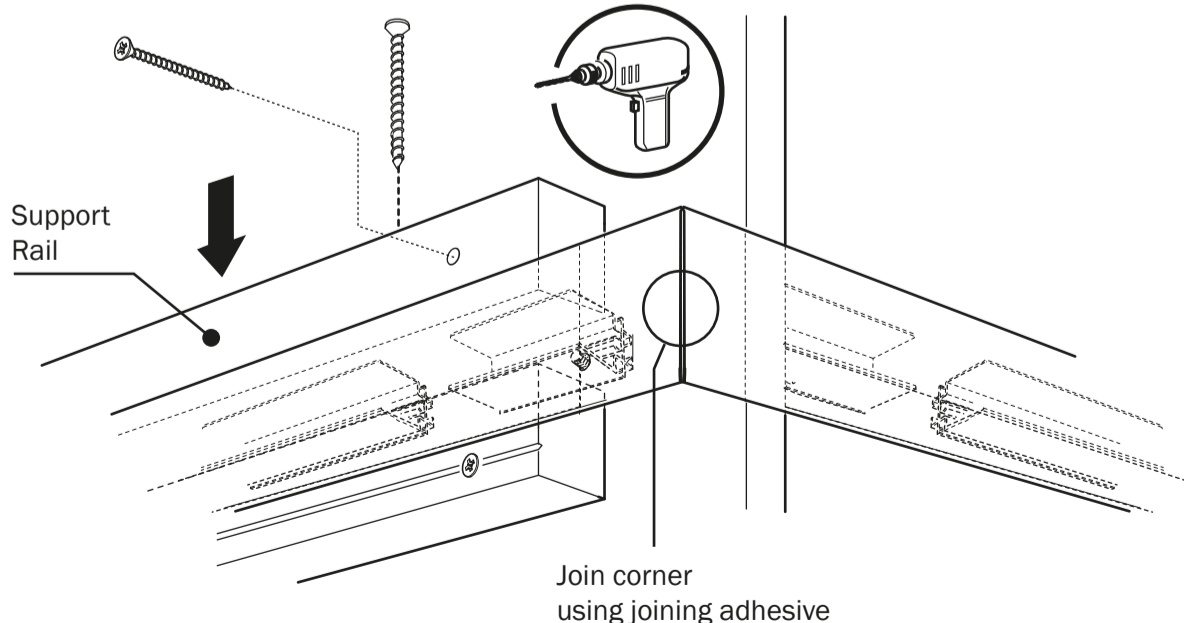

Join corner using joining adhesive

### Worktop Profile

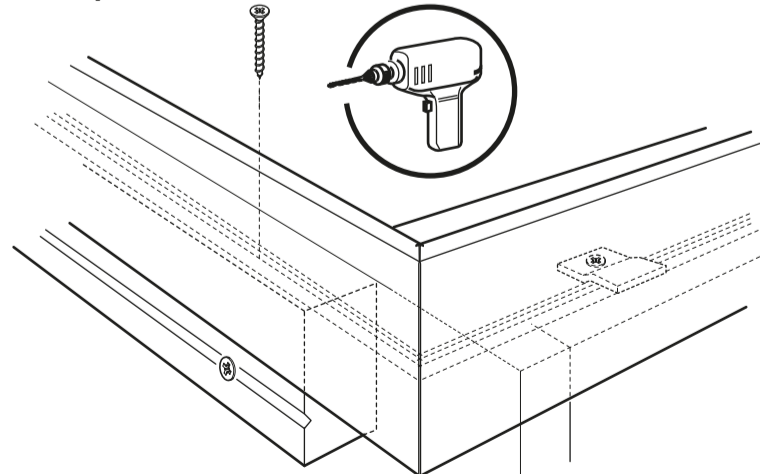

- 4 Fit the drawers and frontals to the cabinet. Having these in position will help determine size and alignment of the decor end/external corner post. Follow the installation manual for drawer and frontal fixing.



- 5 Cut the fixing rails to the dimensions shown. Fit the fixing rails to the fillet(s), using 40mm screws to secure.

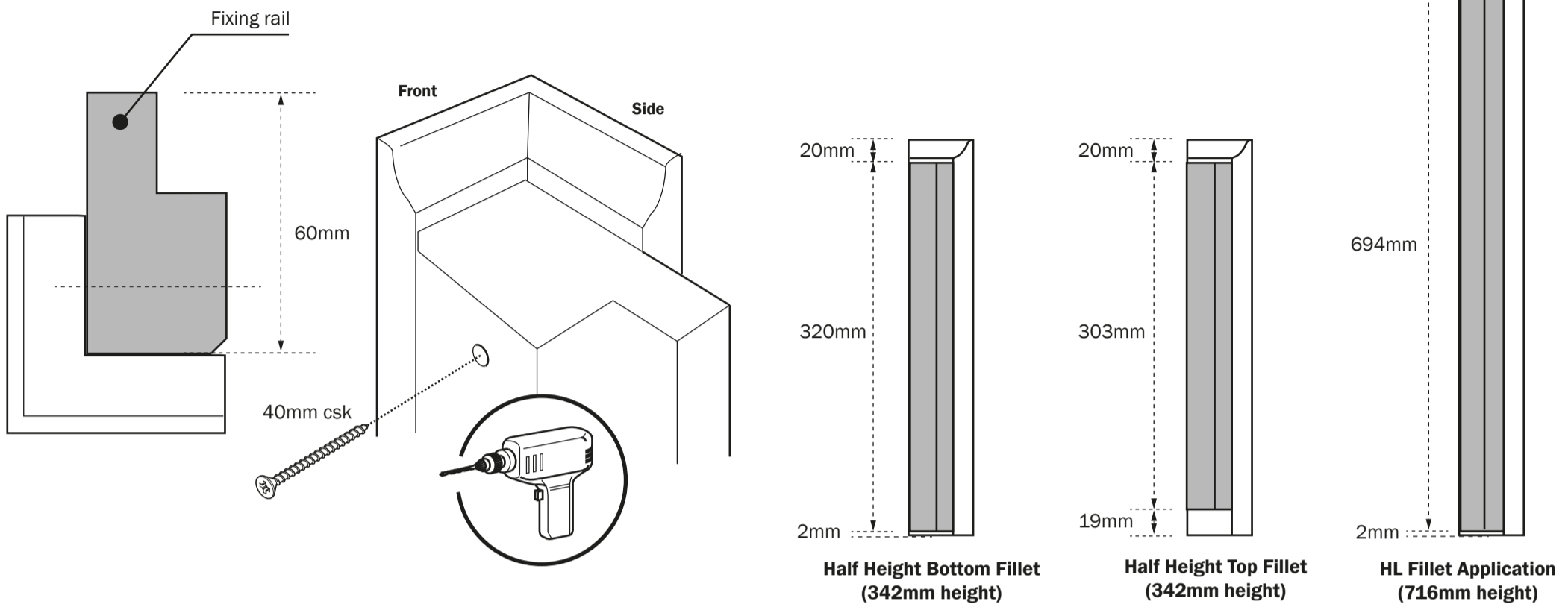

- 6 Measure the cabinet side to find dimension 'Z'. Minus 103mm from this dimension (this is the corner post dimension (51.5mm x2)). This dimension is the size of your decor end.

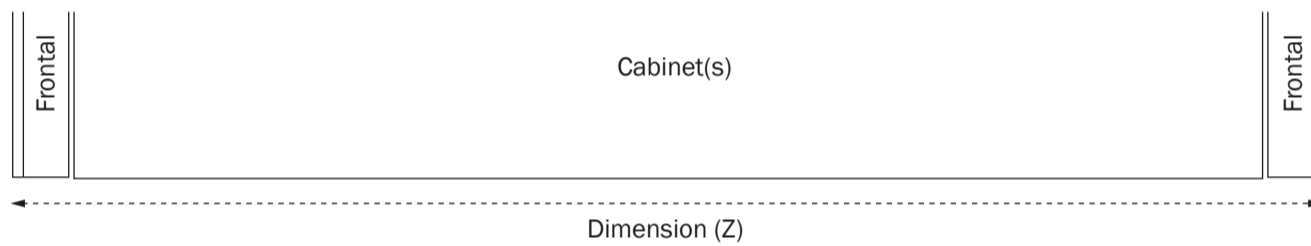

Assemble the decor/external corner fillet end panels, making sure measurements are checked before cutting panels. Secure the decor end panels to the external corner fillet assembly using 30mm screws to secure through the fixing rails.

**Note:** Make sure the decor end panel profile aligns with the corner fillet profile.

Fit additional fixing rails to the back of the decor end securing with 40mm screws. Only one fixing rail may be required.

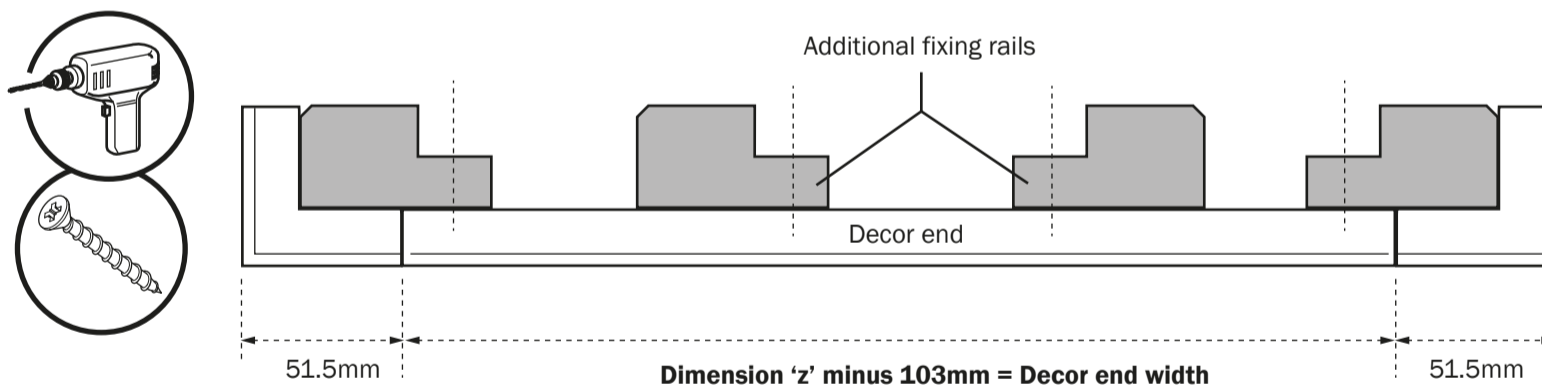

- 7 Fit the decor/external corner fillet assembly to the top and bottom of the cabinet side panels. Secure from the inside of the cabinet using 30mm screws. Drawers will need to be opened to secure decor end assembly. **Note:** We recommend that drawers/frontals are fitted to the cabinets before fitting the side panels to ensure alignment.

