

NOTE: Ensure packaging is disposed of in a safe environmentally friendly way

Separator plate may not allow use of internal storage drawer sets

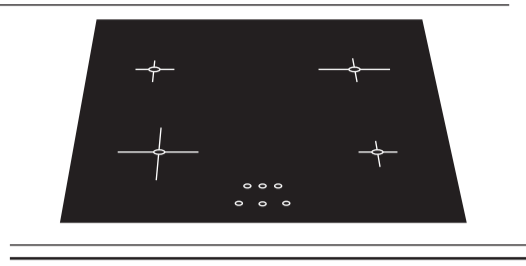

When fitting a hob into a worktop, a heat resistant separator plate is required to isolate the underside of the hob (unless above an oven).

Note: The plate must allow ventilation for the hob and be easily removed for any service needs. This assembly guide shows an example method of fitting a separator plate.

Assembly

Fitting depth depends upon worktop thickness and hob protrusion depth.

FRONT VIEW

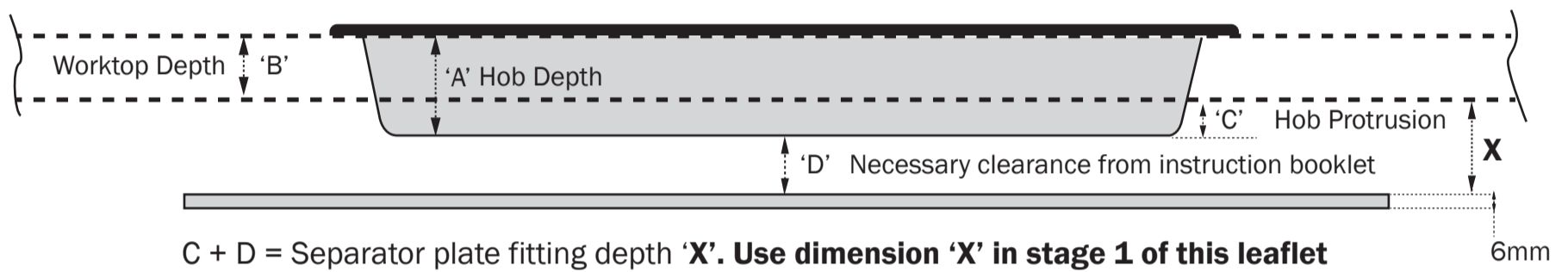

- 1 Mark cabinet depths **X** and cutout section. **X** +6mm for the bracket positions.

- 2 Cut the 6mm board supplied to the internal width of the cabinet. Fix the panel in place using brackets & screws (3.5 x 13mm) provided.

Note: Follow the diagram below for number of brackets and fixing locations.

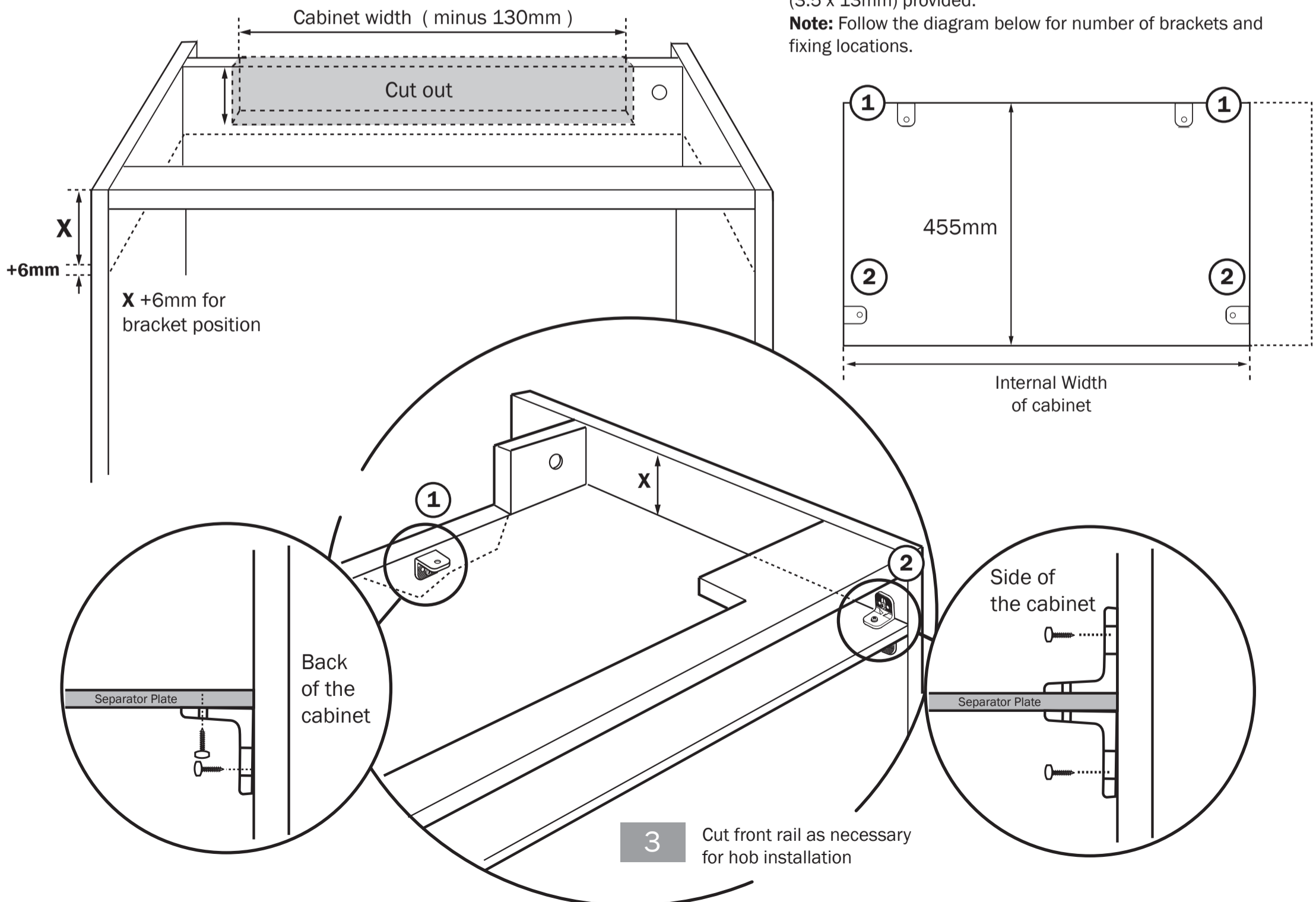

700mm, 800mm, 900mm, 1000mm High Line Cabinets

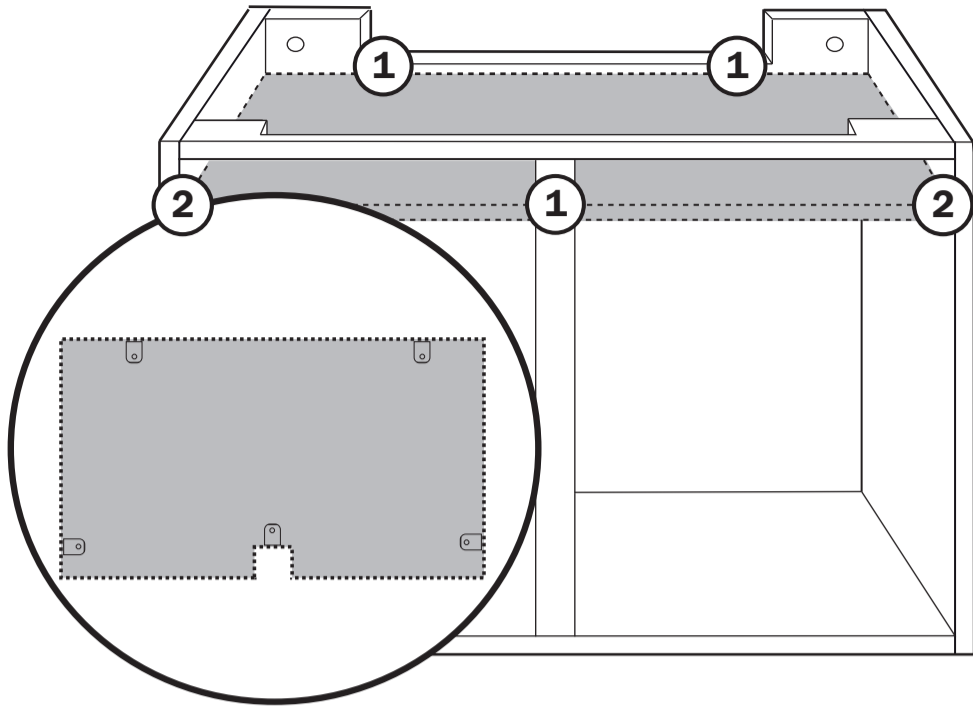

Notch out the plate around the centre rail.

800mm, 1000mm Double Drawerline Cabinets

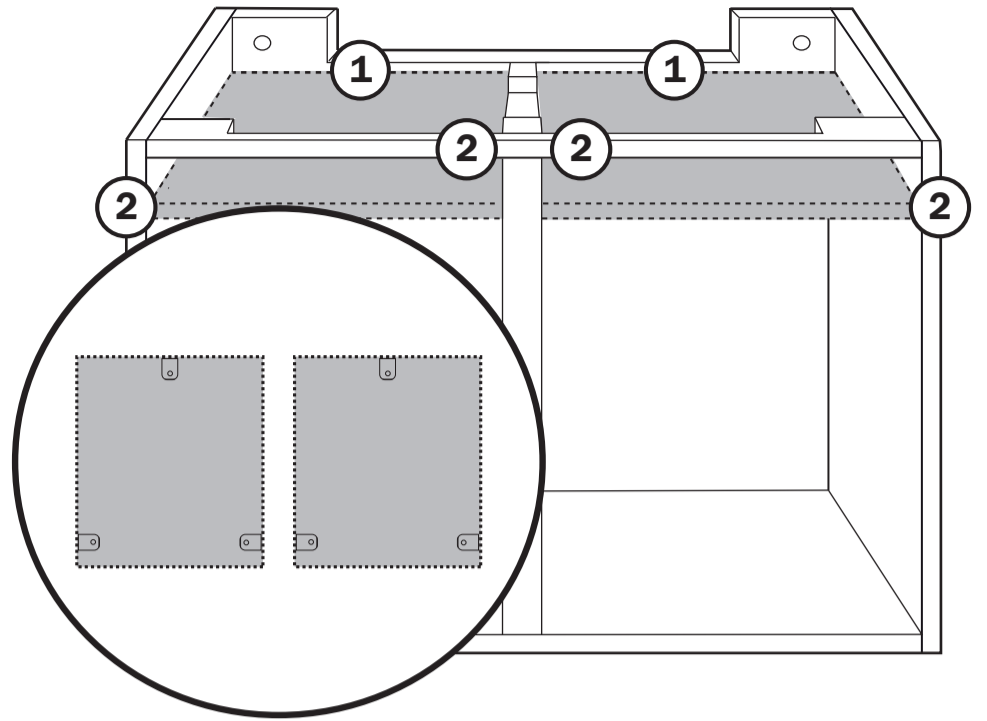

Two additional brackets are required to fix the plates in place.

Prepare cabinet and plate(s) → Remove plate(s) → Fit worktop and hob → Fit plate(s)

Induction Hobs Ventilation

**Induction hobs need ventilation channels
SIDE VIEW (Timber/Laminate worktop application)**

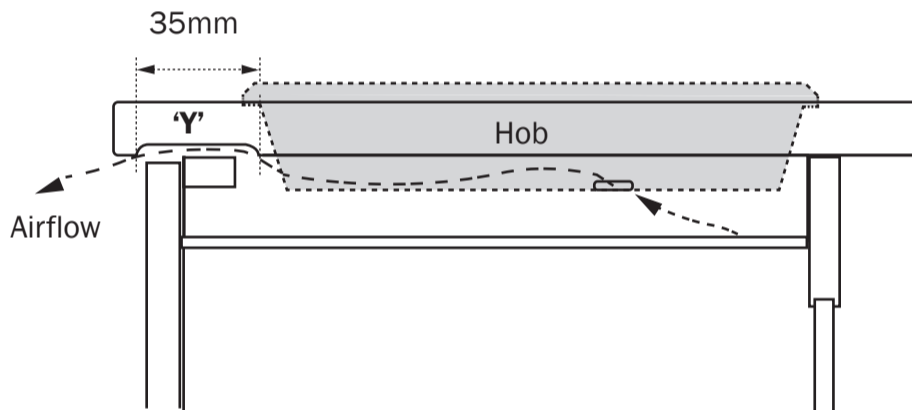

When fitting a timber or laminate worktop, router the underside as shown to a depth of 3mm.

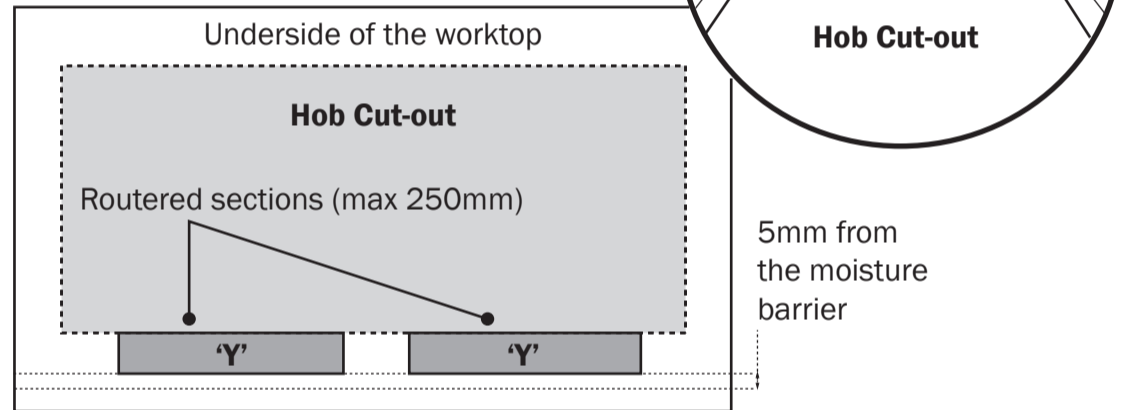

Induction Hob & Granite / Solid Surface

PLAN VIEW (Granite worktop application)

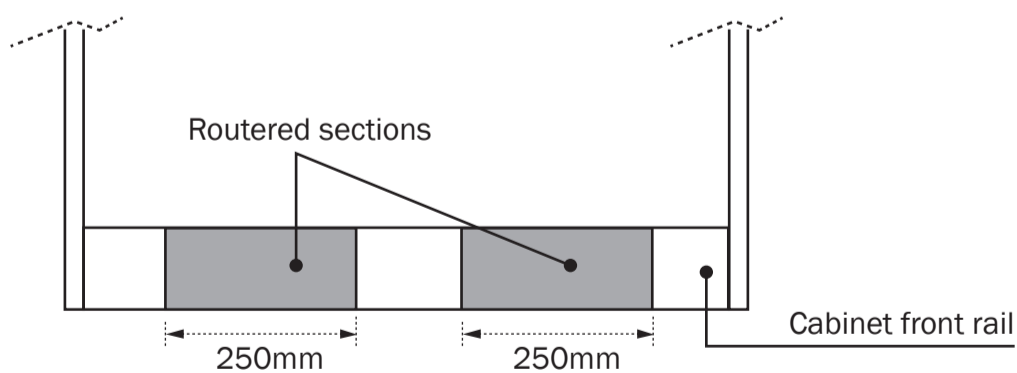

When fitting granite worktops, the front rail of the cabinet will need to be routed (3mm in depth) at set intervals to allow for airflow (as above timber / laminate worktop method is not possible).

Note: Do not router the full length of the front rail, as this is required as support for the granite worktop.

Depending upon application a granite support bar may need to be fitted if front rail is reduced in size (and strength) significantly.

Gas Hobs

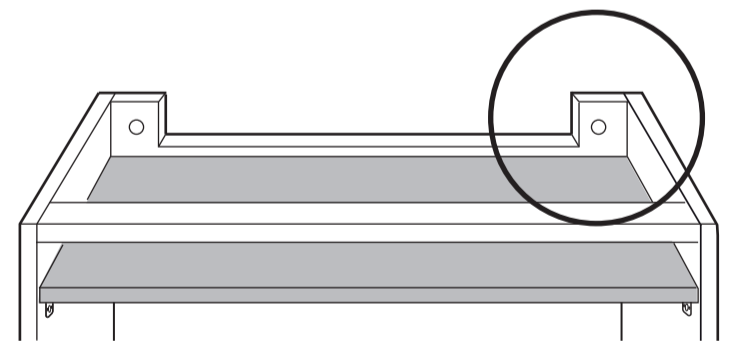

Cut out as necessary for gas pipe connection etc.