

# Corner Larder & Pantry Top Cabinet

Cabinet preparation & assembly options

# LEAF10LTC2

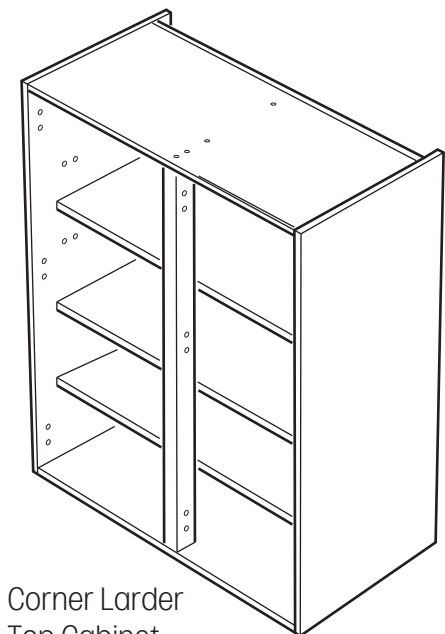

Corner Larder  
Top Cabinet  
(Separate shelving pack)

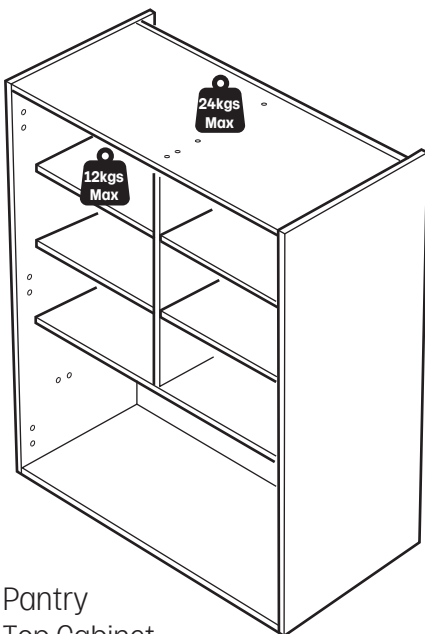

Pantry  
Top Cabinet  
(Separate shelving pack)

### Important Notes:

Ensure packaging is disposed of in a safe environmentally friendly way

Use this leaflet in conjunction with the kitchen installation manual and the individual leaflets supplied with the products where applicable.



Scan the QR code with your smart device to access a digital copy of the kitchen installation manual

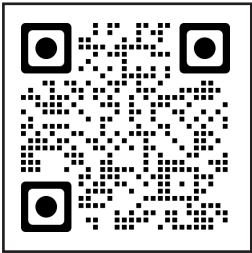

Fittings not used in the assembly of the product are supplied for installation of the unit and should not be discarded.

**The cabinet should be secured to the base cabinet once constructed. Ensure the cabinet is secured to the wall using the larder brackets.**

Internal shelves have a max load weight of 12kgs per shelf.  
The top of the cabinet max load weight is 24kgs.

## Assembly - Corner Larder Top Cabinet

1

**Remove the centre post from the cabinet.**  
**Note:** Retain larder brackets for fixing cabinet to the wall.

2

Fit the post to the cabinet, drilling through the top and bottom fixing holes. Secure with screws.

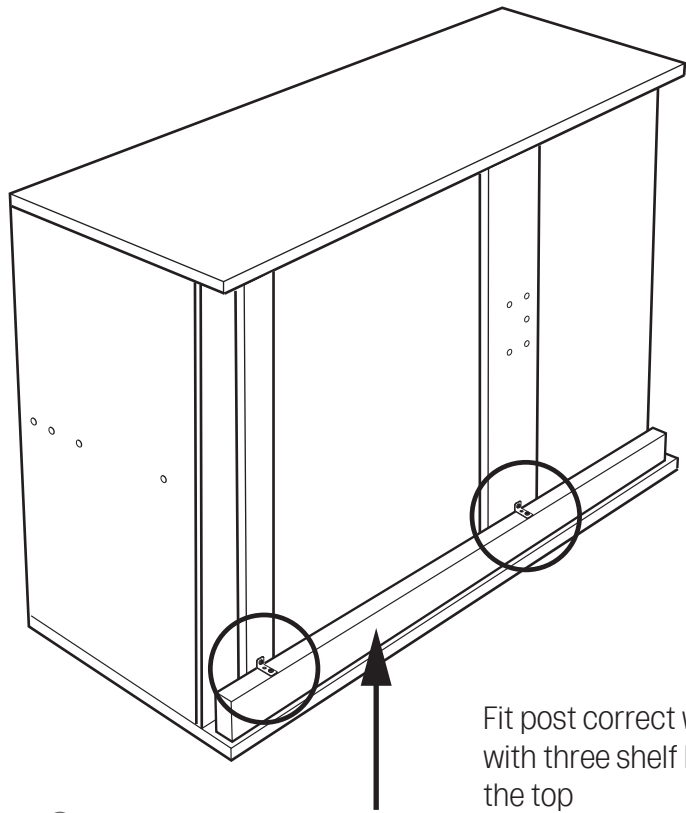
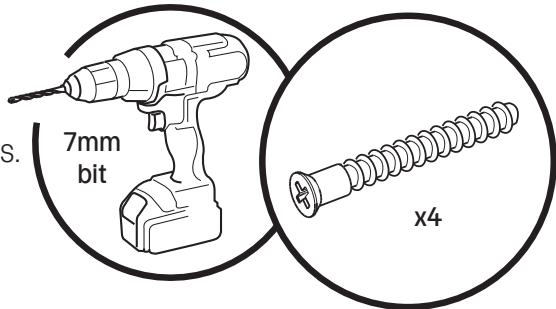

Fit post correct way up with three shelf holes towards the top



Centre post is stored at the back of the cabinet for transit

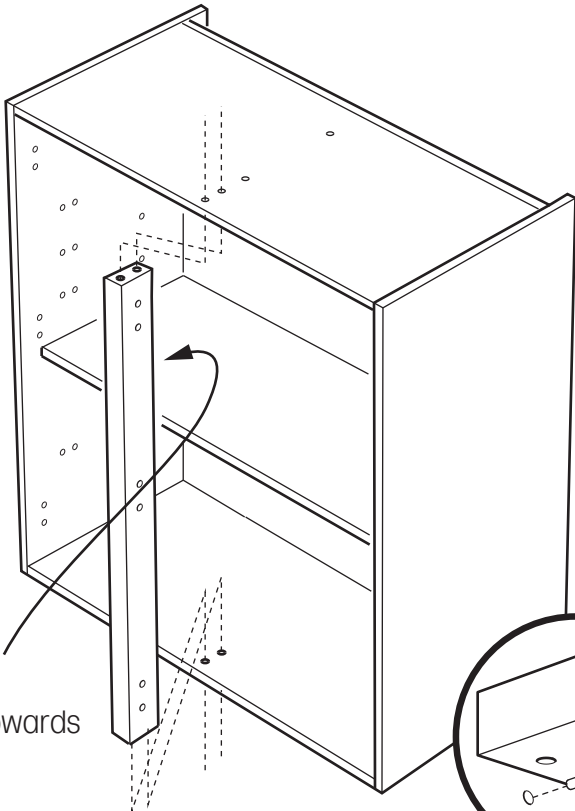

Fit mid shelves  
(Supplied separately)

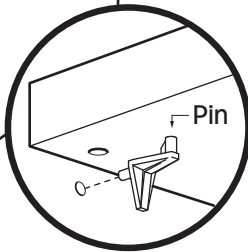
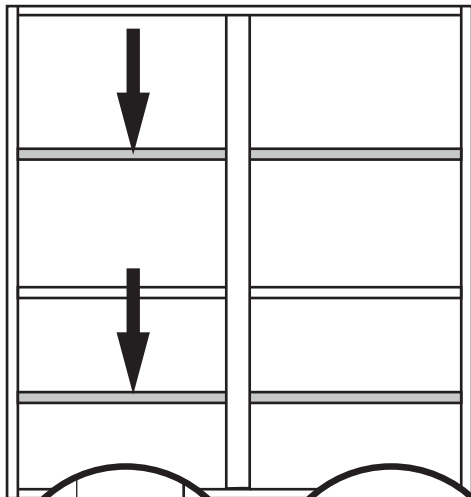

Shelf support x8  
(with location pin)

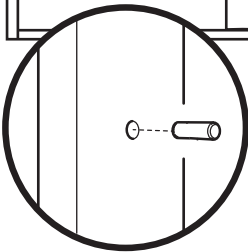

Centre post  
shelf support x3

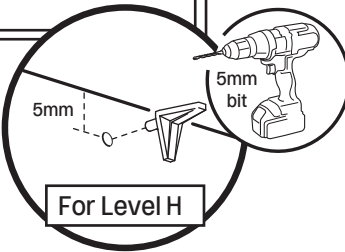

Back shelf  
support x3  
(no pin)

## Assembly - Pantry Top Cabinet

1

Remove mid shelf and studs from the side panels

2

Cut mid shelf to 402mm from front edge, then drill through fixing holes as shown.

3

Drill through fixing holes in the top of the cabinet.

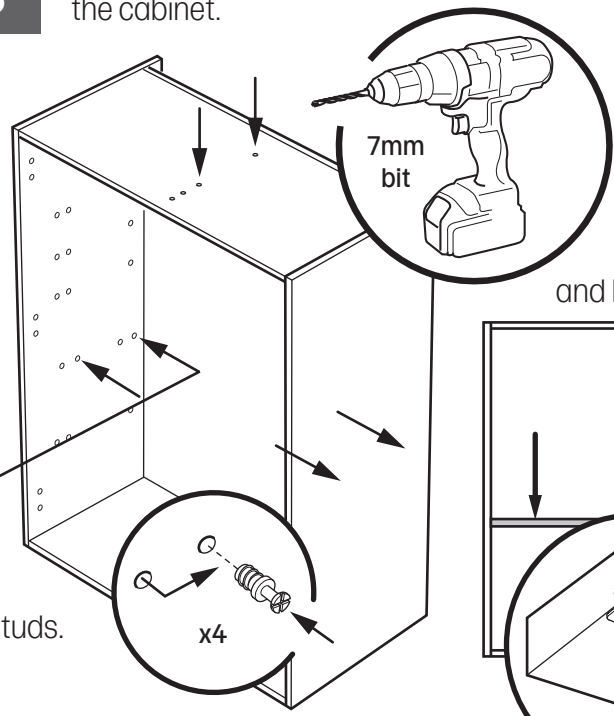
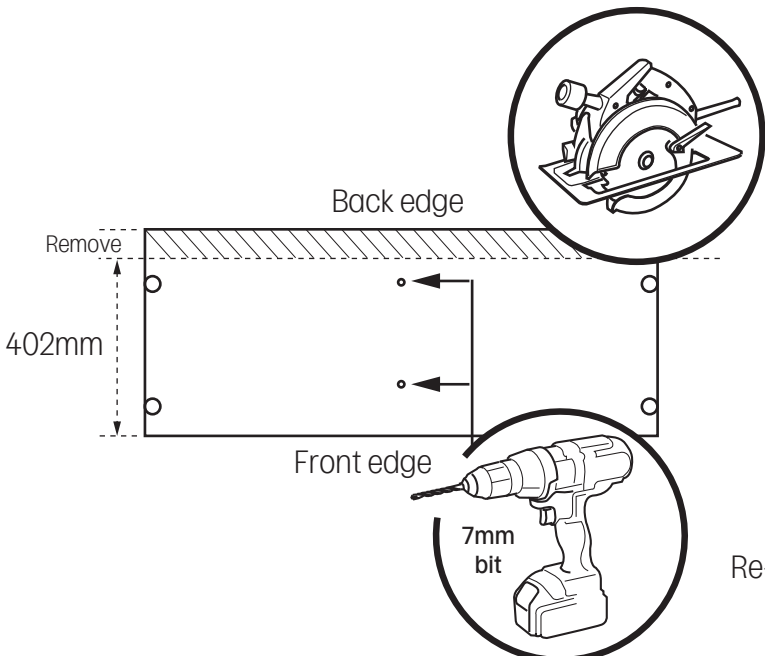
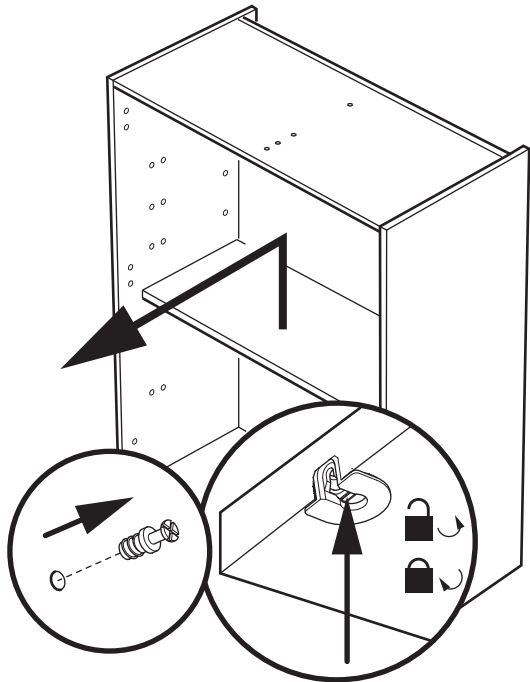

Fit mid shelf  
and lock in position.

## Shelf Pack Installation (Supplied separately)

- 4** Drill through the back rail central hole with a  $\varnothing 4\text{mm}$  drill bit, then back through from inside with a  $\varnothing 7\text{mm}$  drill bit.

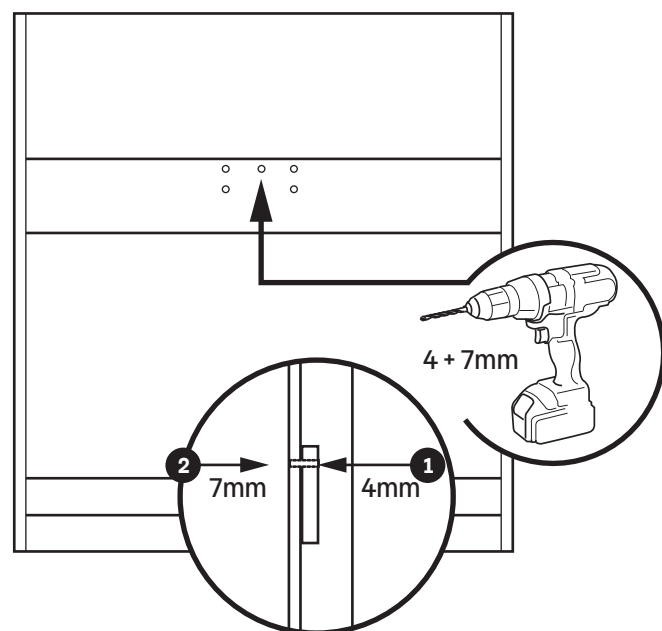

- 5** Fit and secure the central divider panel in place, using the screws top, bottom & through into the back.

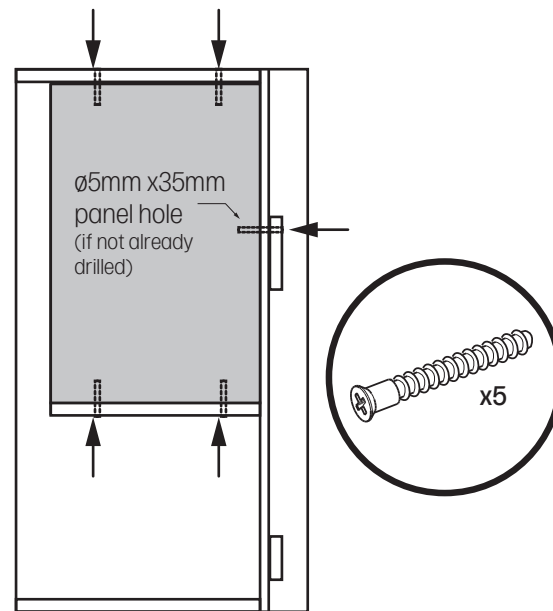

- 6** Locate the shelf pegs into the holes and fit the shelves.

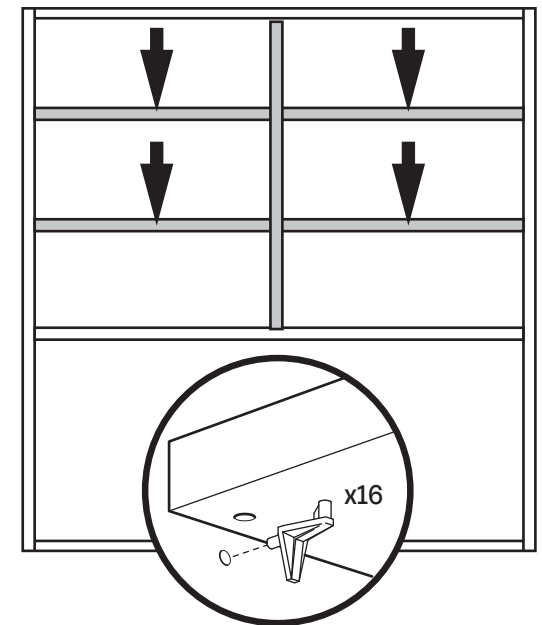

## Base Panel Removal

In order to create a pantry cabinet with a worktop as the base panel, follow the stages below for how to carefully remove and replace the base panel.

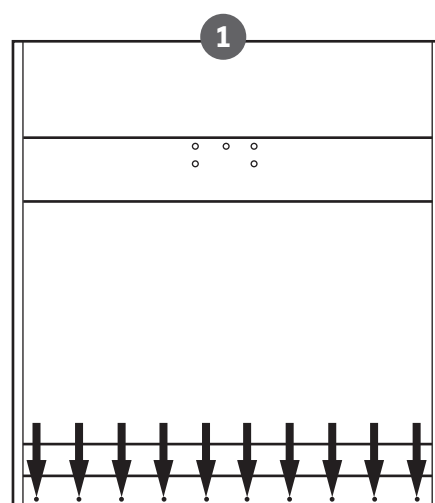

Carefully remove staples from the back of the cabinet at the base.

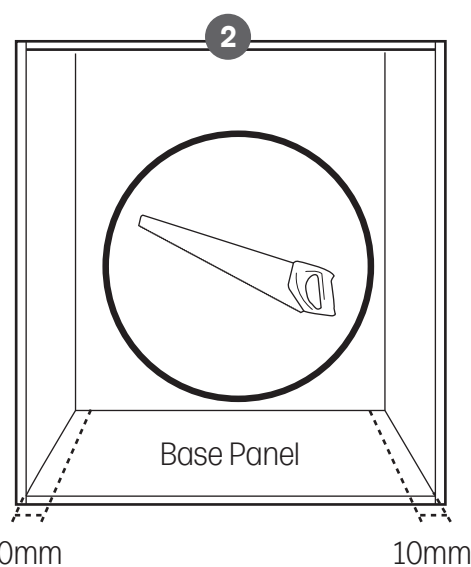

Cut base panel 10mm in from each side.  
**Note:** Be careful when cutting that the end and back panels are not damaged.

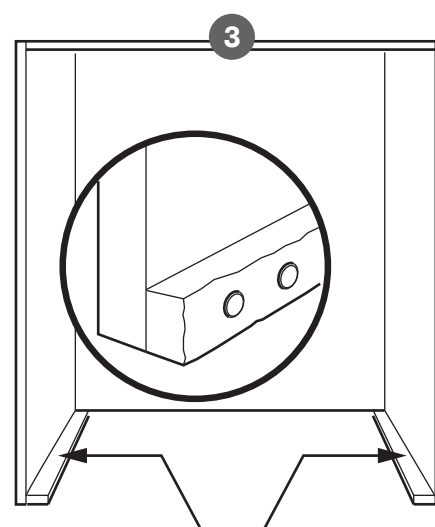

Carefully remove final sections of base panel and trim back dowels.  
Clean away any glue/dust.

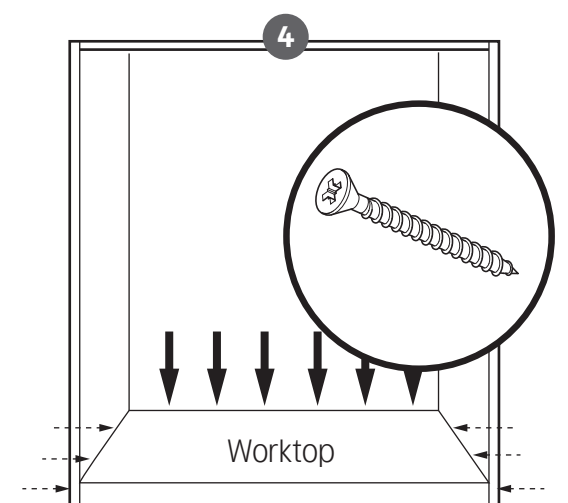

Measure, cut and fit required worktop panel, securing with screws or adhesive each side and back.

## Integrated Microwave/Coffee Maker housing option (1000mm unit only)

Additional panels will be required to create a suitable aperture. Drill 7mm diameter holes through shelves A & B then fix the vertical panel. Cut and re-drill the mid shelves (see dimensions).



**When fitting an appliance, ensure there is adequate ventilation as shown in your appliance installation booklet.**

