

# Appliance tower configurations for 60mm plinth height

## Fridge or freezer tower with drawer

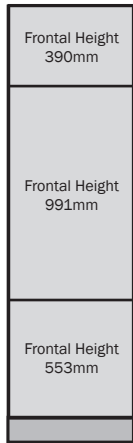

## Single oven tower with pull out worktop & drawer



x2 300 Doors Height - 716mm

115mm BUOH fascia rail (cut to suit appliance)

**Note:** The shelf positions shown on this page refer to the single oven tower only. Follow the appliance tower manual for the fridge or freezer tower configurations & all other aspects of tower modification and installation.

Back panel height 682mm

Back panel height 621mm

### Shelf Hole Positions

5 x 12mm  
Dimensions for the shelves are to the centre of the drilling positions.



1268mm (Shelf)

615mm (Shelf)

583mm (Runner)

533mm (Shelf)

When fitting the worktop to the runners, ensure the worktop is positioned 2mm forward from the cabinet to allow for the fitting of bumpers. Use a strong wood glue to secure dowels.

### Pull Out Shelf

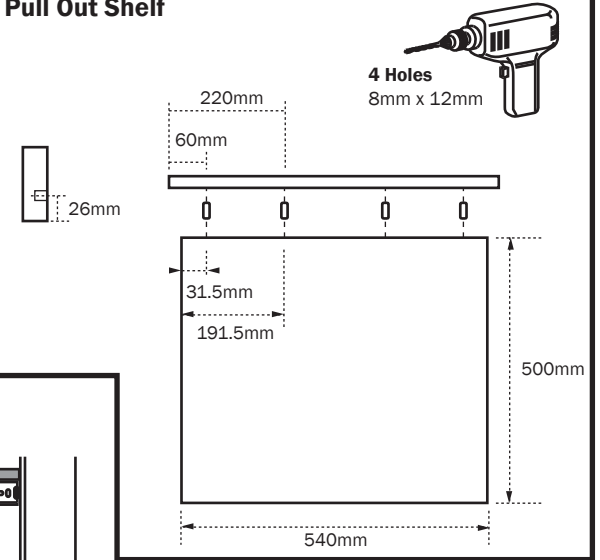

### Runner Fixing

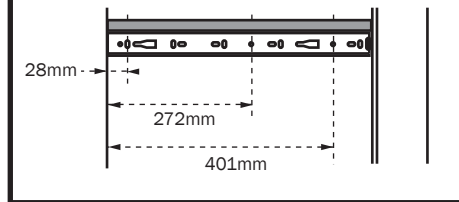

Follow the dimensions below for the positions of the drawer box fixing brackets. Follow the leaflet supplied with your drawer box for Pan drawer installation & adjustment.

### Drawer Front Drilling

600 Standard door used for the 600 Pan drawer box

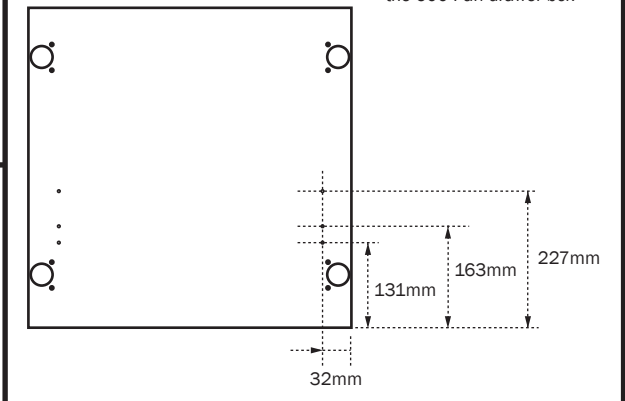

NOTE: The above drilling for the drawer front is also applicable for the 600 Fridge or Freezer tower.