

Bathroom Installation Manual



Version : E.J

Contents page

1. Introduction	Page 4
2. Tools required / key	Page 5
3. Fittings	Page 6
4. 600 cistern unit	Page 7
5. 600 vanity unit	Page 10
6. 600 wall mounted deep vanity unit	Page 12
7. 500/600 wall mounted shallow vanity unit	Page 14
8. 631 corner unit	Page 16
9. Worktop application	Page 18
10. Leg fixing	Page 19
11. Wall fixing & adjustment	Page 20
12. Connecting units together	Page 20
13. Decor ends	Page 21
14. Cornice & pelmet	Page 22
15. Plinth cutting & fixing	Page 23
16. Hinge fixing & door adjustment	Page 24
Notes section	Page 25

1. Introduction

This manual has been designed to instruct in the assembly & installation of Howdens Joinery bathroom cabinets. We strongly recommend that the installation of your bathroom be carried out by professional installers, who have the relevant qualifications and can complete the work to the recognised British and European standards. This will ensure your bathroom achieves the professional fitted look that you require.

During the cabinet installation you will be asked to refer to the manufacturers instructions for fitting your sanitary-ware, i.e. Basin & Toilet etc. These instructions have been supplied with your sanitary product.

This manual is laid out in sections which clearly show specific stages of cabinet modification & assembly in order to assist in the installation process.

Installation

- Install your Bathroom, carefully following the sections in this booklet which are relevant to the units & products you have purchased.
- Tools are shown which may be required in order to assemble your Bathroom.
- Do not fix drawer fronts & doors until your cabinet is fully installed.
- Check your service points - Whilst your room is empty, it is an ideal time to check the position of your utilities /services. Undertaking the task of installing new sockets and pipe work is not so easy once units have been positioned. Please read the important note section below.

Important Notes

- When making holes into walls, floors and ceilings, ensure that you do not puncture any concealed plumbing or wiring.
- Before fixing the units to the wall, please ensure the construction of the wall is capable of taking the weight of the unit and appropriate fixings used. If in any doubt consult an expert.
- Any exposed edges MUST be sealed using an appropriate sealant.

Care & Maintenance

Door & Cabinet Care

Usually regular cleaning with a clean damp cloth is sufficient. Never use strong detergents or abrasive cleaners as these may damage the surface finish of your furniture. We do not recommend spray polishes are used. Make sure all exposed edges of the cabinet carcass are finished using the edge banding supplied. Fitting of this is covered in this installation booklet.

Glass Care

When cleaning glass panels or mirrors, use a clean damp cloth or leather with washing up liquid or soft soap if necessary. Do not use washing powders or any other substance containing abrasives, as these will scratch the glass.

Sanitary-ware

Follow the manufacturers instructions for cleaning.

2. Tools required

Shown below are some of the tools you may require during the installation of your Bathroom.

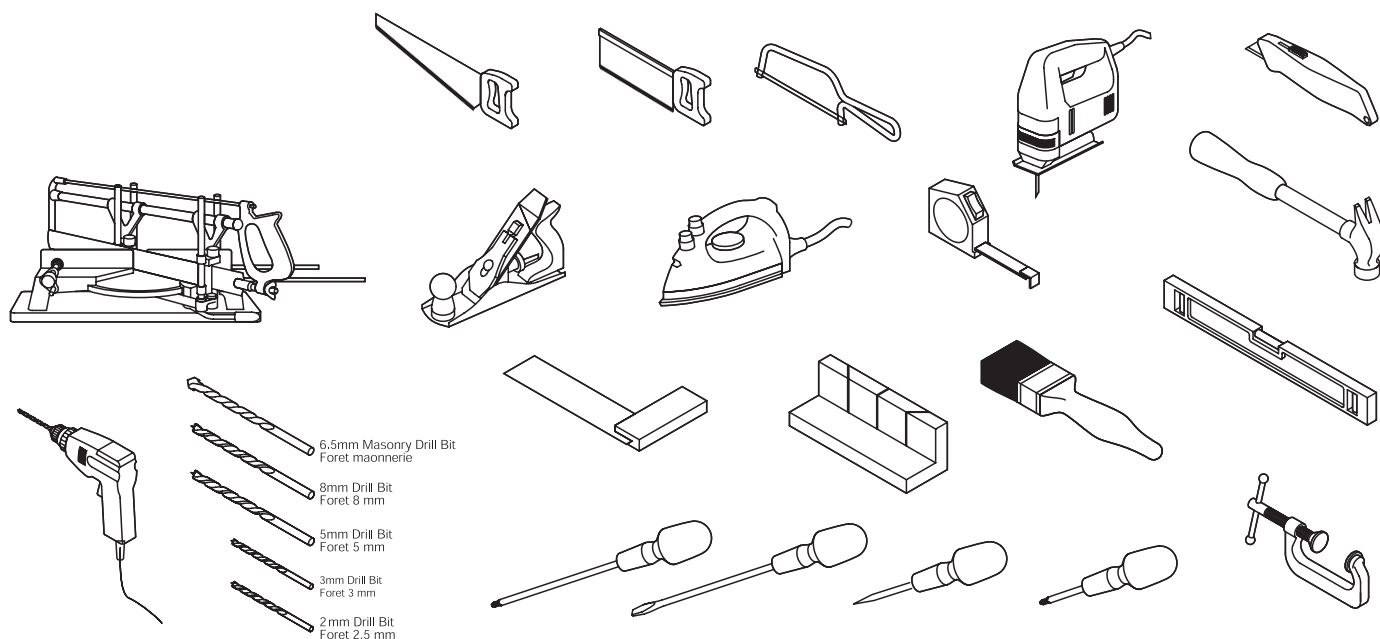

Below is a 'key' showing the meaning of some of the symbols contained within this manual.

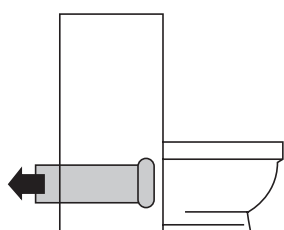

Rear Soil pipe outlet

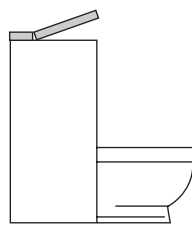

Top Cistern Access

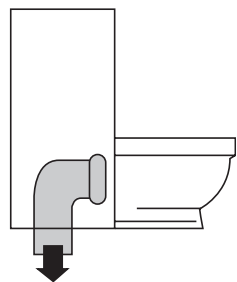

Bottom Soil pipe outlet

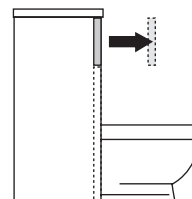

Front Cistern Access

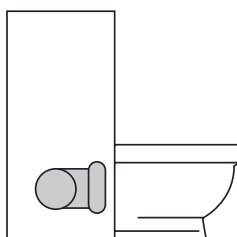

Side Soil pipe outlet

3. Fittings

Fittings are supplied with your cabinets and are shown visually, during the manual, where used. Separate fittings packs may have been provided for certain bathroom cabinet applications.



Screw - 50mm



Screw - 40mm

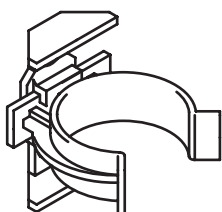

Plinth Clip



Screw - 20mm



Screw - 12mm



Screw - 13mm



Screw - 13mm

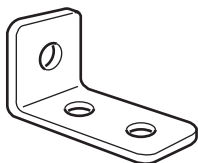

Bracket

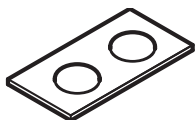

Door Bumpons

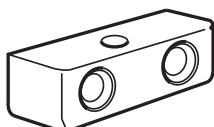

Fixing KD Block

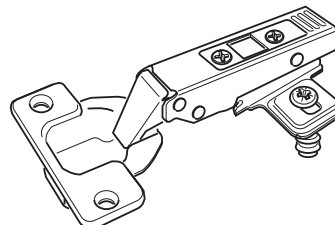

Hinge & Hinge Arm

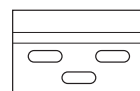

Wall Hanging Bracket Plate

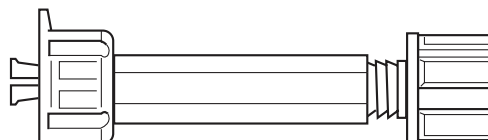

3 Part Leg



Screw - 13mm



Screw - 30mm



Cover Caps

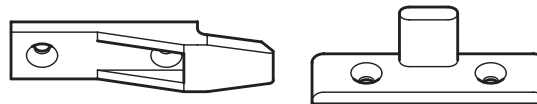

Cistern Unit Brackets

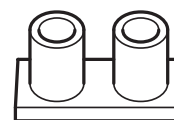

Cistern Unit Clip



Cistern Unit Bracket

4. Cabinets - 600 cistern unit

600 cistern unit

This section covers how to convert a 600 wall unit into a cistern base unit. During the step by step instructions you will need to refer to the common assembly stages section of the manual. These are highlighted in grey boxes.



Stage 1

Remove the shelves and back panel from the wall unit.

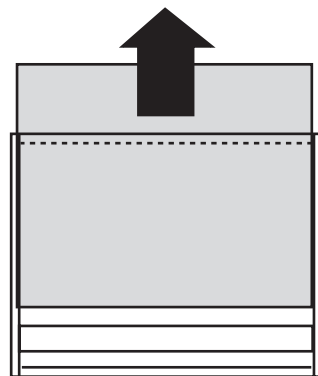
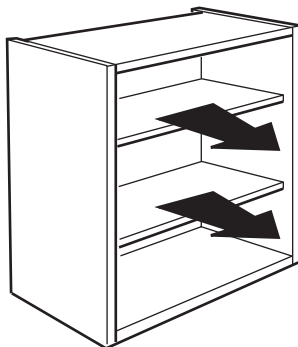

Stage 2 - (only for rear soil pipe outlet)

Lay the unit on its front edges and remove the back rail, using a small saw.

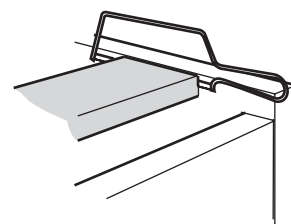
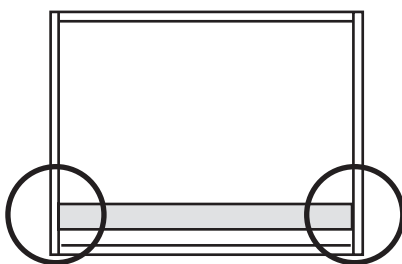

Stage 3

At this stage we recommend you fit the legs to your unit. Follow the detailed instructions for this operation on page 19.

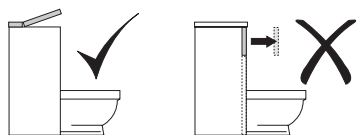

Stage 4 - (only for top access)

Using a jigsaw, cut the top of the unit as shown making sure you leave a minimum of 50mm around the side & 60mm at the front as shown. This is for worktop fixing.

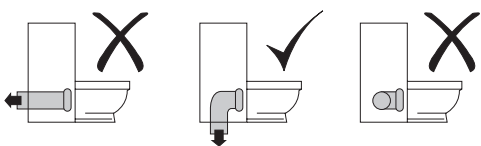
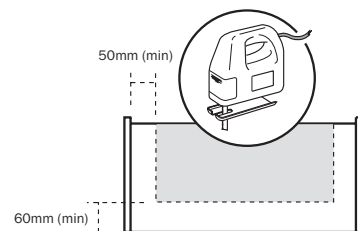
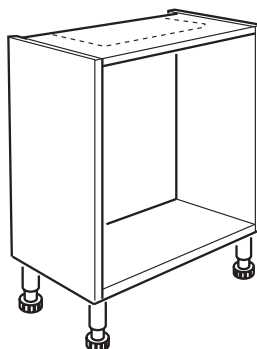

Stage 5 - (only for base soil pipe outlet)

Using a jigsaw, cut the base panel as shown according to the size of your soil pipe.

IMPORTANT: Make sure before cutting the base panel, that the position of your unit in relation to the position of the soil pipe has been determined.

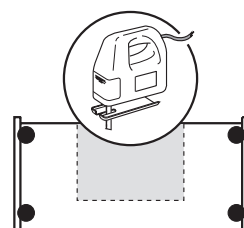
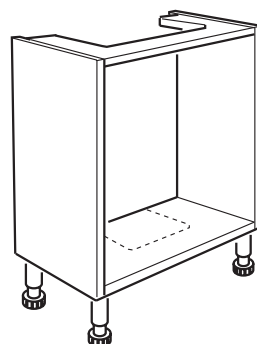

4. Cabinets - 600 cistern unit

Stage 6

Pilot drill the fixing positions for your clips to the LH & RH side panels using the dimensions shown.

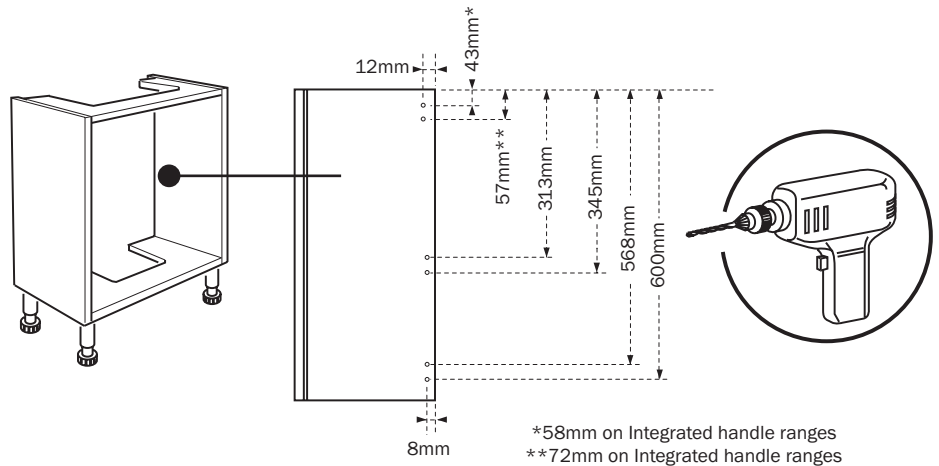

Stage 7

Fit the plastic clips & brackets to the LH & RH side panels using the screws to secure.

If you removed the back rail of your unit (see stage 2), you will need to fit a metal bracket to the back edge of each side panel as shown using screws. This is for wall fixing at a later stage.

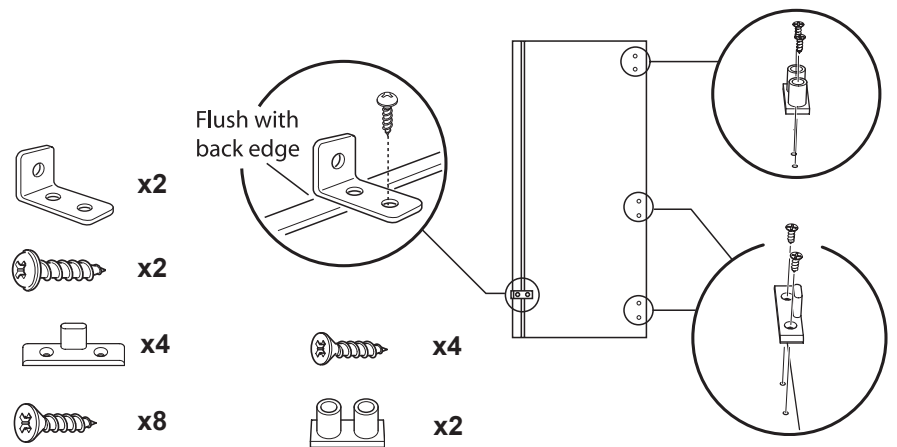

Stage 8

Pilot drill the fixing positions for your clips and brackets onto the inspection & bottom access panels (Drawer front & Door) using the dimensions shown.

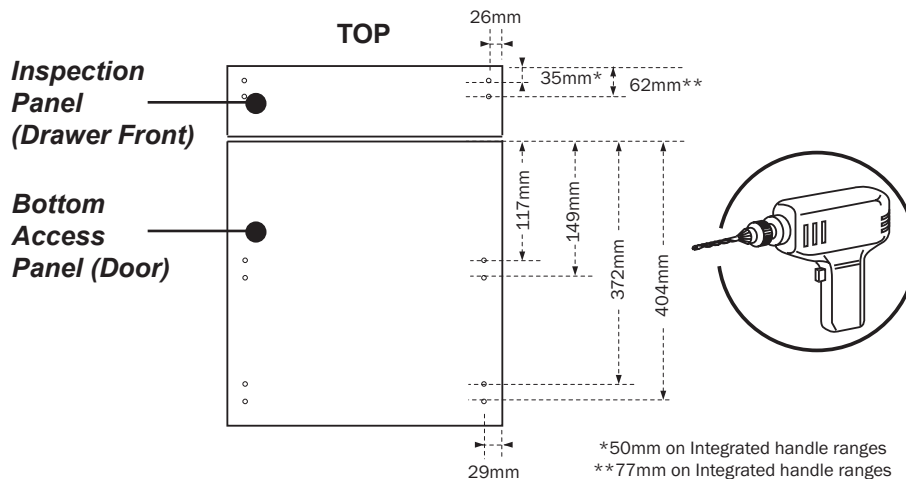

Stage 9

Fit the plastic clips & hooks to the inspection & bottom access panels (Drawer front & Door) using the screws to secure.

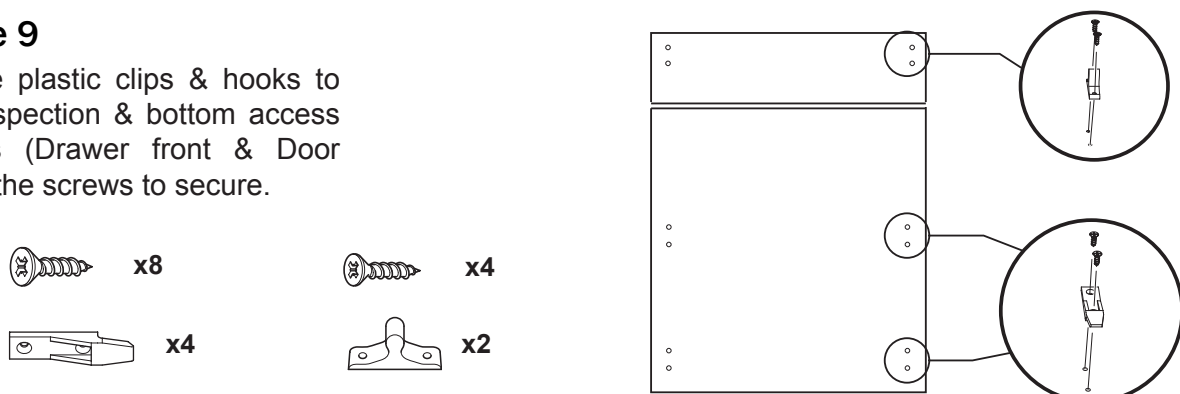

4. Cabinets - 600 cistern unit

Stage 10

At this stage we recommend you fit your unit to the wall. Follow the detailed instructions for this operation on page 20.

Stage 11

Fit your unit to the wall using the pre-fitted hanging brackets (see hanging bracket adjustment section).

If you removed the back rail, secure the unit at the base through the metal brackets using suitable wall fixings (not supplied).

If the back rail is still in place, use this for fixing to the wall.

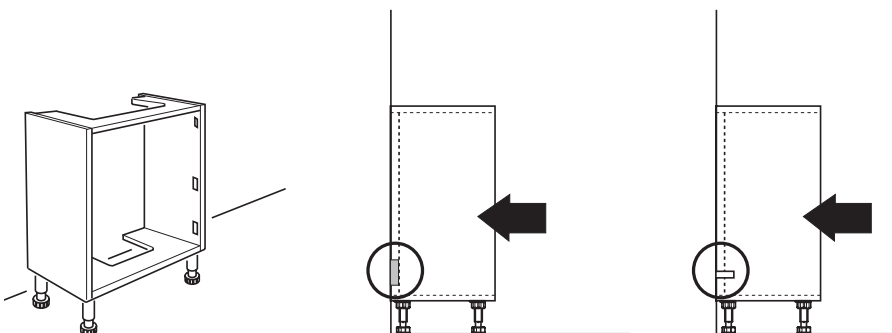

IF FITTING A RUN OF UNITS, ENSURE ALL ARE FITTED BEFORE FITTING WORKTOPS

Stage 12

At this stage we recommend you fit your worktop. Follow the detailed instructions for this operation on page 17.

Stage 13

Cut the inspection front panel (drawer front) for your cistern lever or push button, making sure its location will not be impeded by the WC seat as shown.

Cut the bottom access panel (door) for the inlet & outlet pipes.

All cut edges should be sealed using appropriate waterproof sealant.

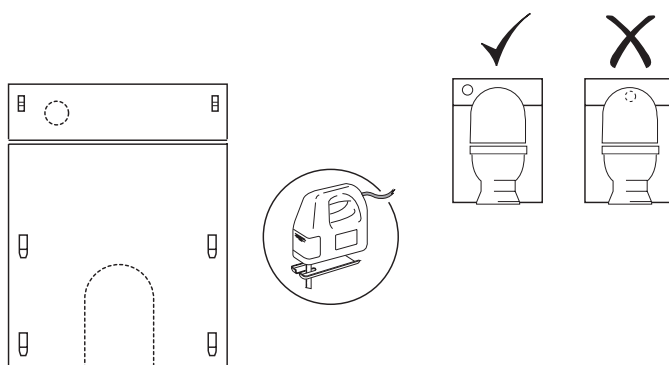

Stage 14

Fit the bottom access panel (door) to the unit, slotting down into place.

Fit the inspection panel (drawer front) to the unit, clipping into place.

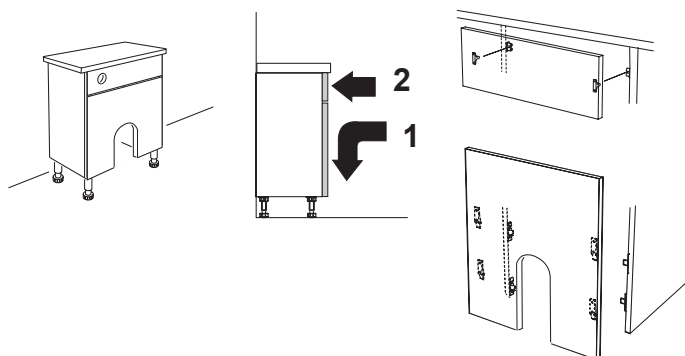

Stage 15

At this stage fit the cistern to the wall & flush bend. Follow the manufacturers guidelines ensuring the cistern is positioned just below the top panel.

Stage 16

Finally fit the WC to your unit following the manufacturers guidelines.

5. Cabinets - 600 vanity unit

600 vanity unit

This section shows how to convert a 600 wall unit into a vanity base unit. During the step by step instructions you will need to refer to other sections of the booklet for common assembly stages. These are highlighted in grey boxes.

Stage 1

Remove the top shelf from the unit.

The bottom door hinge positions are already drilled, but you will need to measure and drill for the top door hinge position following the dimensions shown.

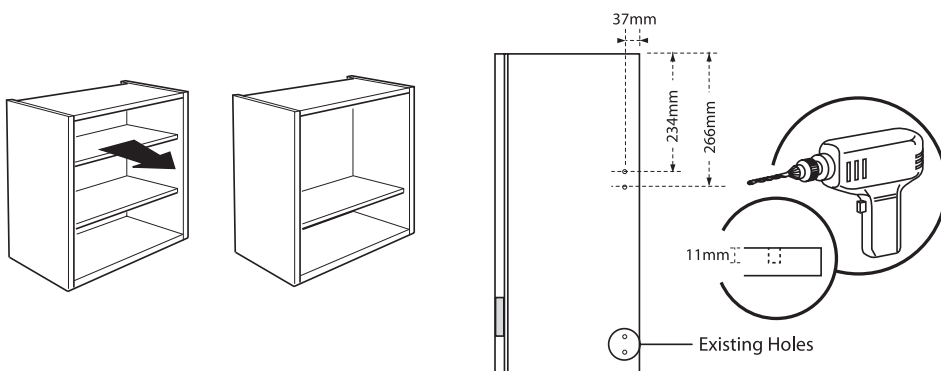

Stage 2

At this stage we recommend you fit the legs to your unit. Follow the detailed instructions for this operation on page 19.

Stage 3

At this stage we recommend you fit the hinge plates to your unit. Follow the detailed instructions for this operation on page 24.

Stage 4

Lay the vanity front panel (drawer front) on your work surface. Use a tape measure to mark the 564mm dimension leaving an equal gap in from each side as shown. Using this dimension as a guide, secure 4 brackets to the panel in the positions shown using the screws provided.

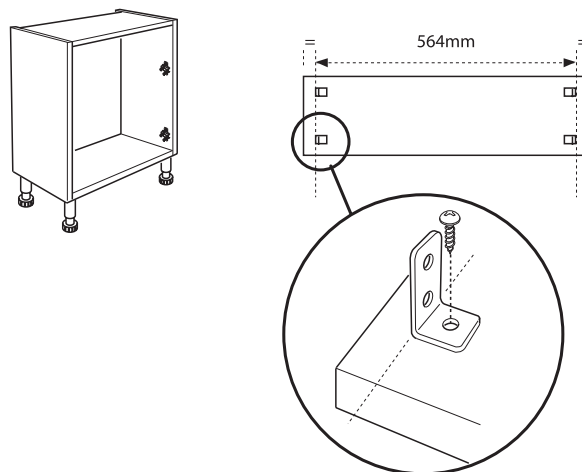
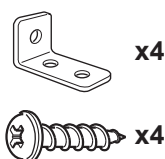

Stage 5

Fit two bumpons each side of the front, in line with the brackets as shown.

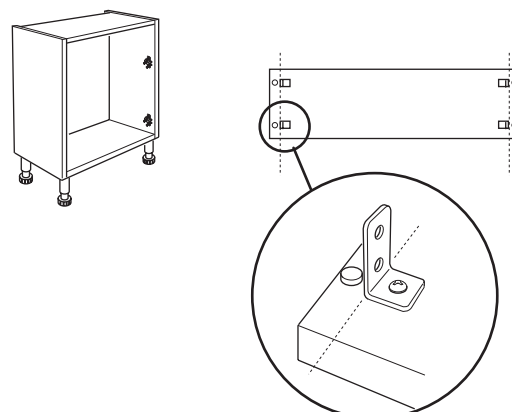

5. Cabinets - 600 vanity unit

Stage 6

Fit the front panel to the unit, and mark the bracket fixing positions on the side panels. Pilot drill these holes, then secure the front using the screws provided.

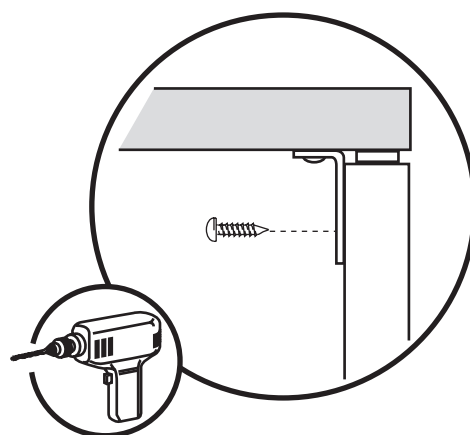
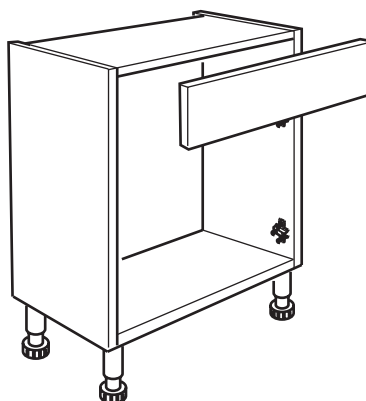

Stage 7

At this stage we recommend you fit your unit to the wall. Follow the detailed instructions for this operation on page 20.

IF FITTING A RUN OF UNITS, ENSURE ALL ARE FITTED BEFORE FITTING WORKTOPS

Stage 8

At this stage we recommend you fit your worktop. Follow the detailed instructions for this operation on page 17.

Stage 9

With your unit fitted to the wall, and worktop fitted, use the template supplied with your basin to mark and cut for your recessed basin.

NOTE: Follow the manufacturers guidelines for cutting for the recessed basin.

Drill through the back panel for any pipe work required.

All cut edges should be sealed using appropriate waterproof sealant.

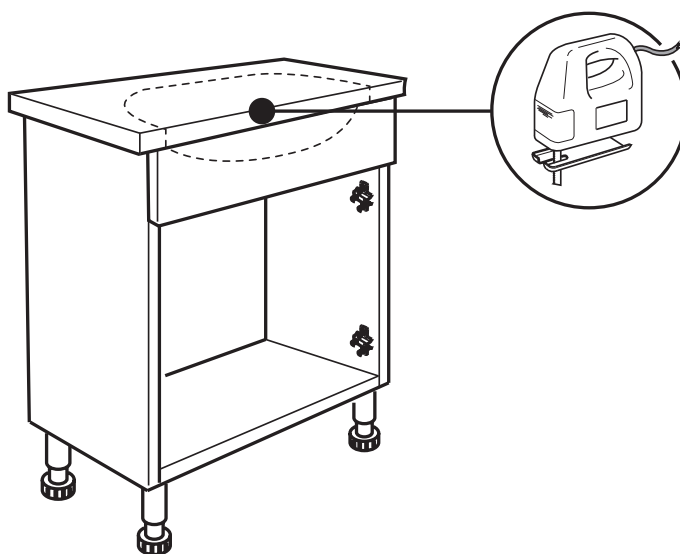

Stage 10

Fit the inset basin to the cabinet following the manufacturers instructions making sure an appropriate sealant is used around the basin.

Stage 11

Finally, fit the doors to the vanity cabinet. Follow the detailed instructions for this operation on page 24.

6. Cabinets - 600 wall mounted deep vanity unit

600 Wall Mounted Deep Vanity Unit

This section shows how to convert a 600 Belfast sink unit into a wall mounted vanity base unit. During the step by step instructions you will need to refer to other sections of the booklet for common assembly stages. These are highlighted in grey boxes.

Stage 1

Remove the back panel from the unit. This can be discarded.

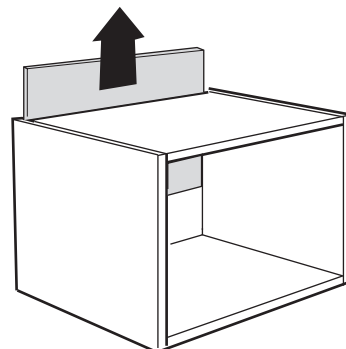

Stage 2

Cut a piece of custom fit panel to the dimensions shown and fit to the back of the unit using the 12 black carcase screws.

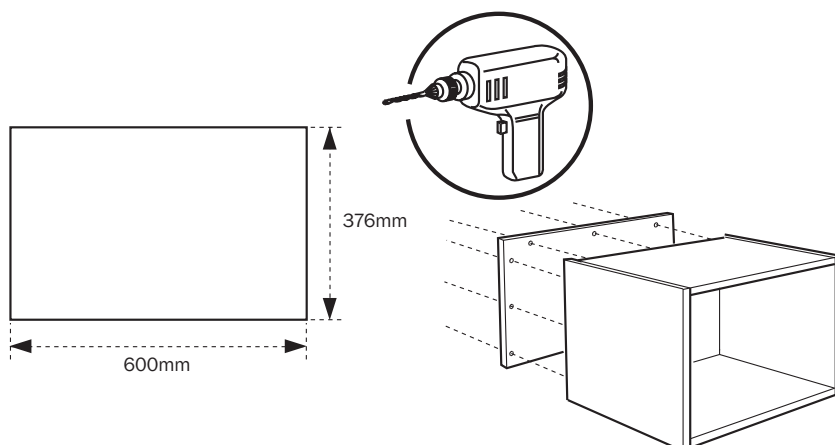

Stage 3

Using a piece of custom fit panel, cut a piece using the dimensions shown.

NOTE: Angle cut the ends as shown.

Fit the baton to the wall at the correct height in relation to the underside of the unit when fitted (wall fixings not provided). Secure the unit to the wall using 6 screws ensuring that it is at the correct height (wall fixings not provided).

Fix the baton to the underside of the unit using the KD blocks & screws.

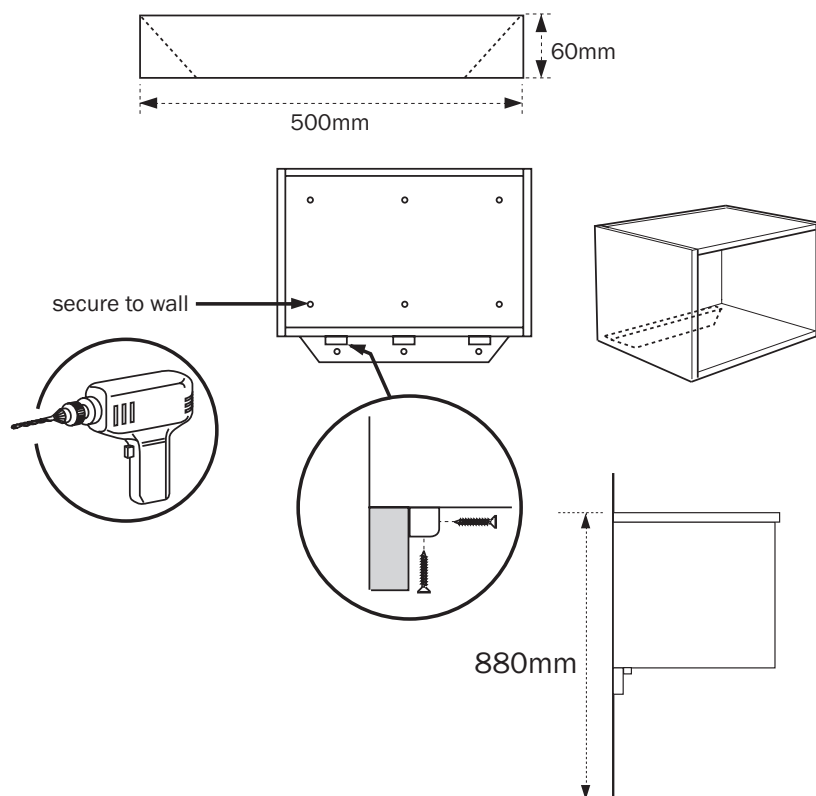

6. Cabinets - 600 wall mounted deep vanity unit

Stage 4

At this stage we recommend you fit your worktop. Follow the detailed instructions for this operation on page 17.

IF FITTING A RUN OF UNITS, ENSURE ALL ARE FITTED BEFORE FITTING WORKTOPS

Stage 5

With your unit fitted to the wall, and worktop fitted, use the template supplied with your basin to mark and cut for your inset basin.

NOTE: Follow the manufacturers guidelines for cutting for the inset basin.

All cut edges should be sealed using appropriate waterproof sealant.

For door frontal fixing follow the instructions on page 24.

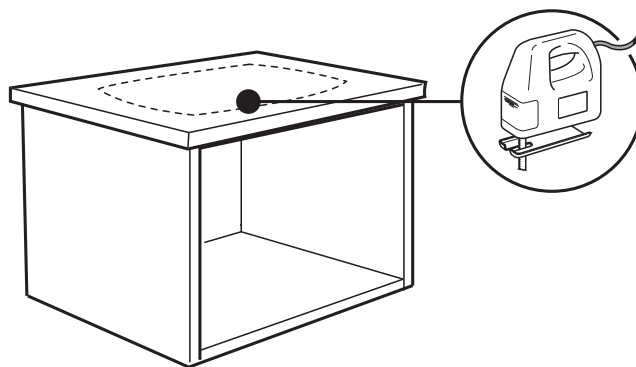

Stage 6

Fit the inset basin to the cabinet following the manufacturers instructions making sure an appropriate sealant is used around the basin.

7. Cabinets - 500/600 wall mounted shallow vanity unit

500/600 wall mounted shallow vanity unit

This section shows how to convert a 500/600 Hob wall unit into a wall mounted shallow vanity base unit. During the step by step instructions you will need to refer to other sections of the booklet for common assembly stages.

Stage 1

Using a jigsaw cut the base & back of the hob wall as shown, leaving 50mm gap around the edges.

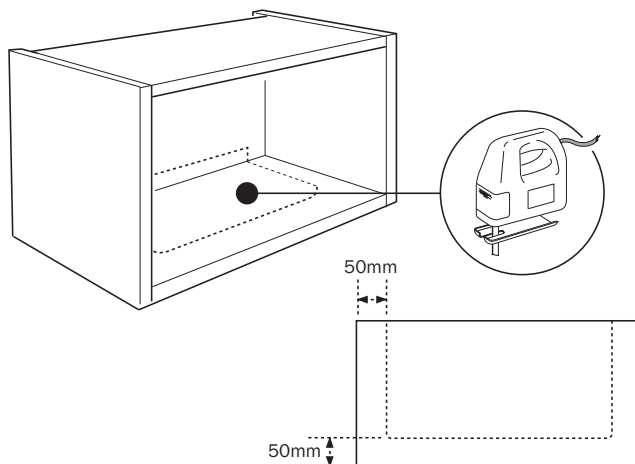

Stage 2

Measure the fixing positions for the fittings as shown each side of your unit.

Fit the plastic clips flush to the side of the unit as shown using the screws to secure.

Fit the clips to the unit as shown using the screws to secure.

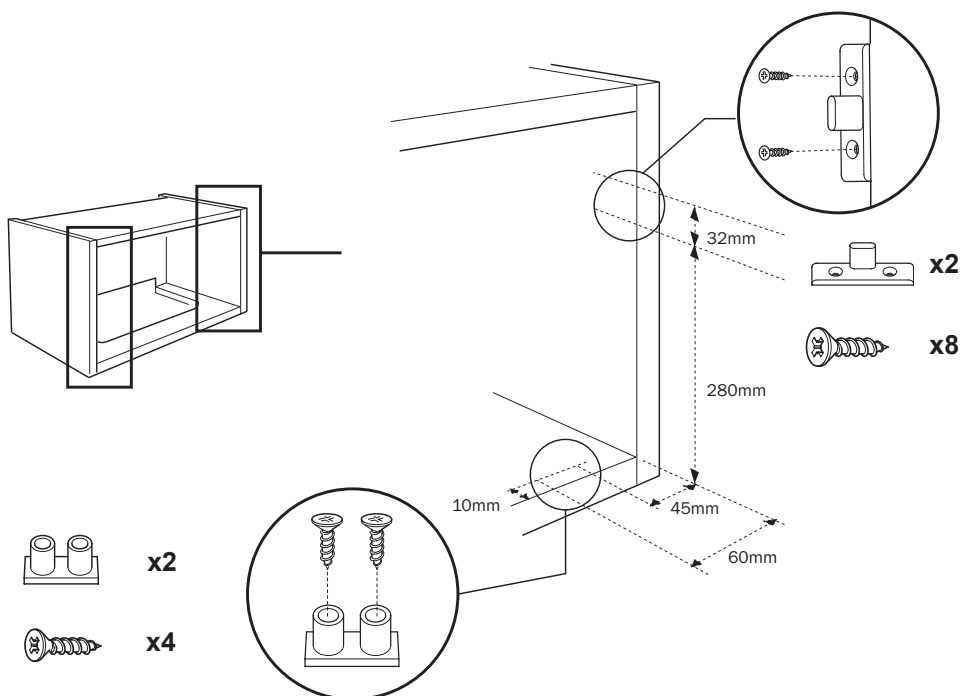

Stage 3

At this stage we recommend you fit your unit to the wall. Follow the detailed instructions for this operation on page 20.

IF FITTING A RUN OF UNITS, ENSURE ALL ARE FITTED BEFORE FITTING WORKTOPS

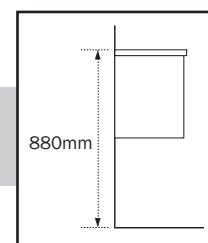

Stage 4

At this stage we recommend you fit your worktop. Follow the detailed instructions for this operation on page 17.

7. Cabinets - 500/600 wall mounted shallow vanity unit

Stage 5

Measure the fixing positions for the fittings on the back of the door as shown.

NOTE: Illustration shows the approximate basin 'cut out' for orientation purposes. This will not be marked on your door.

Fit the plastic clips to the door using the screws to secure.

Fit the clips to the door as shown using the screws to secure.

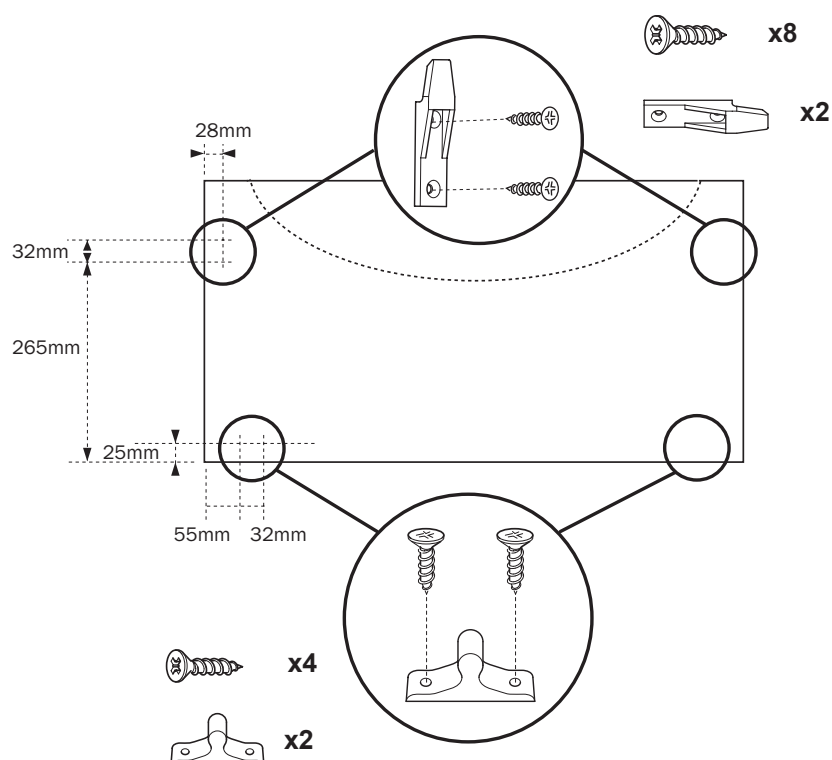

Stage 6

Fit the door to the unit clipping onto the unit as shown.

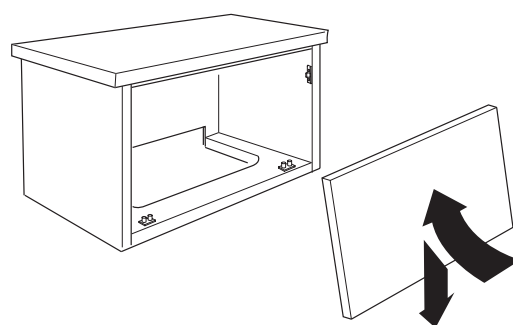

Stage 7

With your unit fitted to the wall, and worktop fitted, use the template supplied with your basin to mark and cut for your recessed basin.

NOTE: Follow the manufacturers guidelines for cutting for the recessed basin.

All cut edges should be sealed using appropriate waterproof sealant.

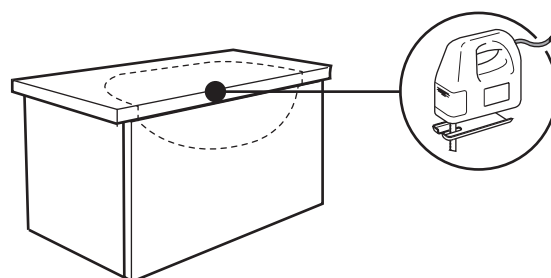

Stage 8

Fit the recessed basin to the cabinet following the manufacturers instructions making sure an appropriate sealant is used around the basin.

8. Cabinets - 631 corner unit

631 corner cabinet

Follow the details below for fitting a base or wall corner unit application.

NOTE: If a corner base unit is being fitted, follow the information on page 19 for leg fixing.

Stage 1

Measure and mark the position of the corner post as shown.

Once in place secure the post to the front of the cabinet using the fixing blocks and screws provided.

LH Applications Shown

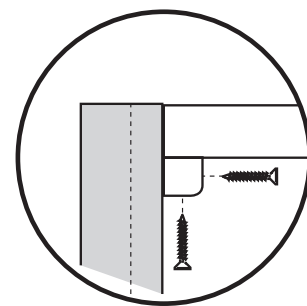
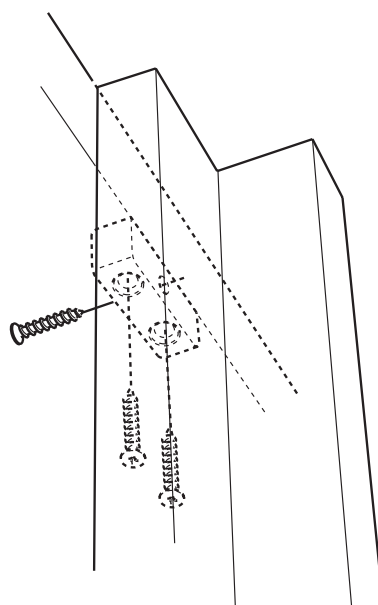
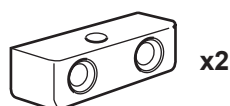
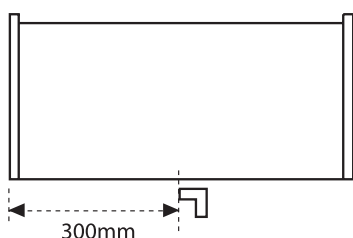
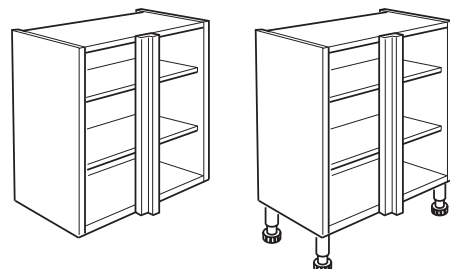

Stage 2

When fixing the corner unit to the wall, position the end 31mm away from the wall as shown. This allows for the adjoining unit to be fitted as shown using another two fixing blocks with screws.

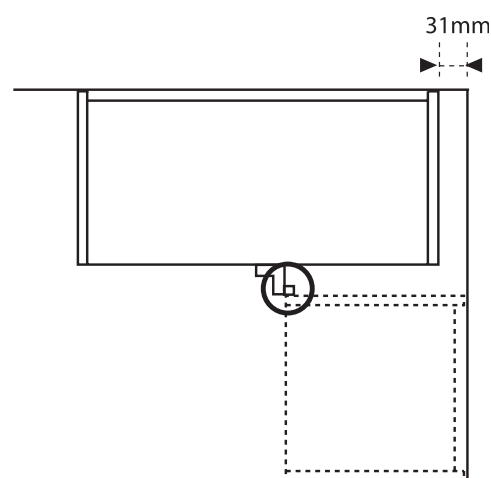
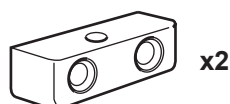

Stage 3

Follow the details on page 20 for wall fixing details.

9. Worktop application

Worktops

Worktops will need to be cut to the correct depth using the dimension shown below as a guide.

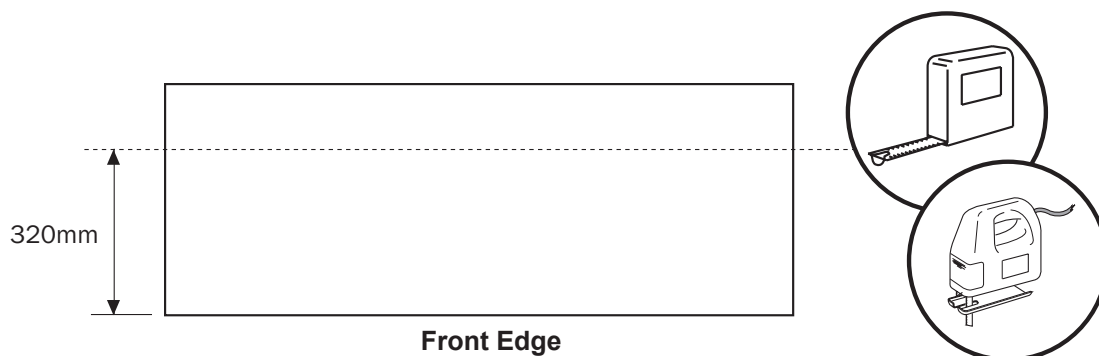

General Worktop Application

Your worktop has been supplied at a standard length and will need to be cut according to your installation.

NOTE: When measuring your worktop make sure you take into consideration any overhang required including clad on ends.

Secure worktops by drilling through the top panel of the unit using a 5mm bit, and up into the underside of the worktop. Then secure using the screws provided.

Flush

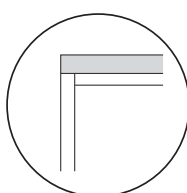

overhang

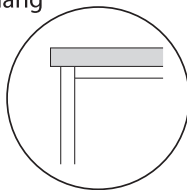

with clad on panel

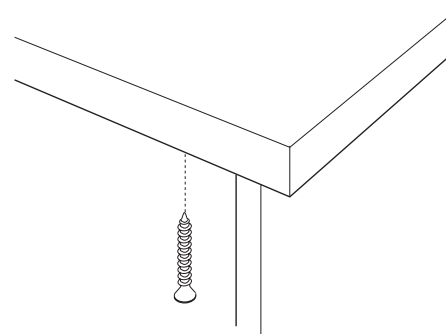
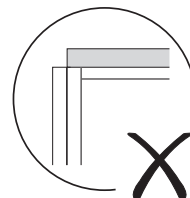
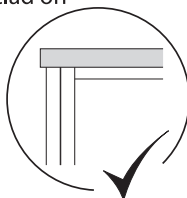

Cistern Unit Worktop Application

Stage 1

Cut the worktop to the correct depth as shown above.

Cut the work top to the correct size for the cistern unit, using the dimension shown below*. Once at the correct width, cut the section into two pieces following the dimensions shown.

NOTE: Apply edge banding to any visible cut edges. Any exposed cut edges that are not being edged should be sealed.

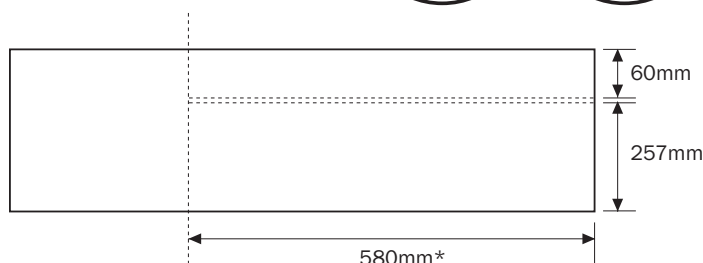
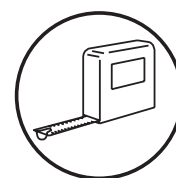

580mm (in a run)

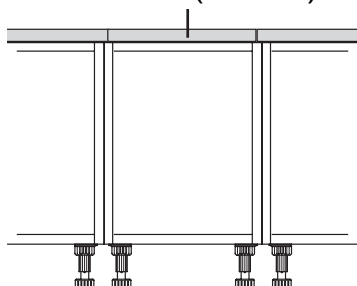

*Please note that this dimension is for fitting within a run of units.

For a stand alone cistern unit the dimension would be the full width of the unit plus any overhang required taking into account clad on end panels.

9. Worktop application

Stage 2

Your piano hinge will need to be cut to the correct length. Using the worktop as a guide, measure and cut the hinge.

NOTE: The hinge should be cut 6mm shorter than the total width of the worktop so when fitted it sits 3mm in from each end.

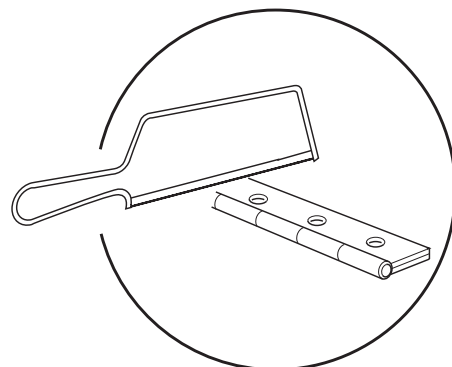
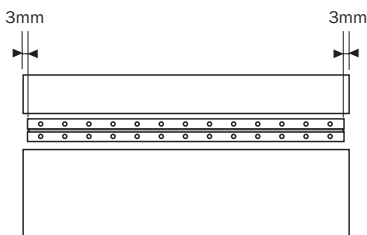

Stage 3

Fit the hinge to the front edge of the back section of worktop & the back edge of the front worktop, using a bradawl to mark the fixing positions. Secure using suitable screws (not supplied).

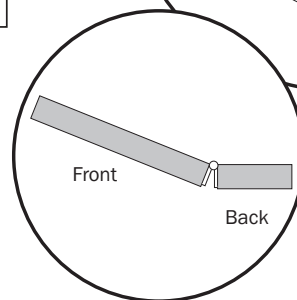
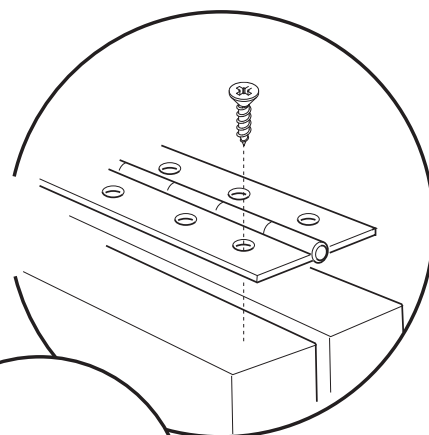
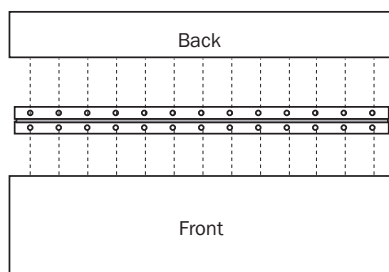

Stage 4

Finally, fit the worktop to the top of the cistern unit.

Secure the back part of the worktop to the unit using a drill to make a 5mm fixing hole. Secure the top using the screws supplied.

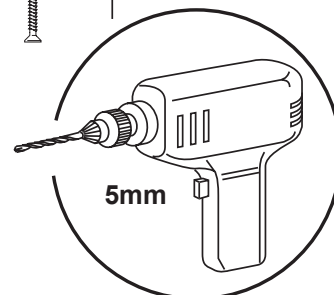
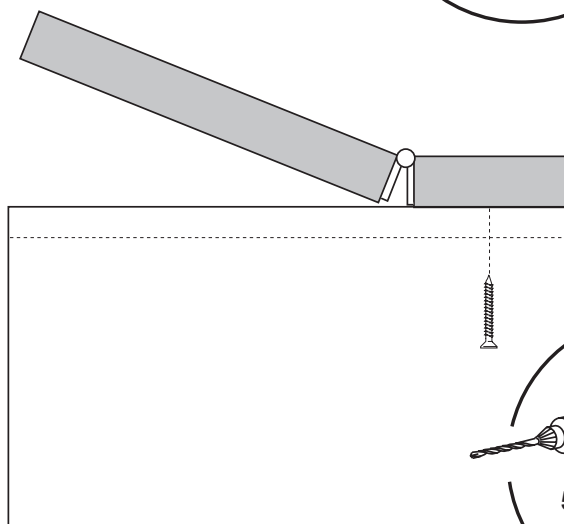

10. Leg fixing

Leg Fixing

Before the legs can be fitted to your unit, they will need to be cut to size. Follow the instructions below for cutting & fitting the 3 part legs.

Stage 1

Remove the plastic dowel at the end of the leg boss using a fine saw.
Once complete, sand the top until smooth.

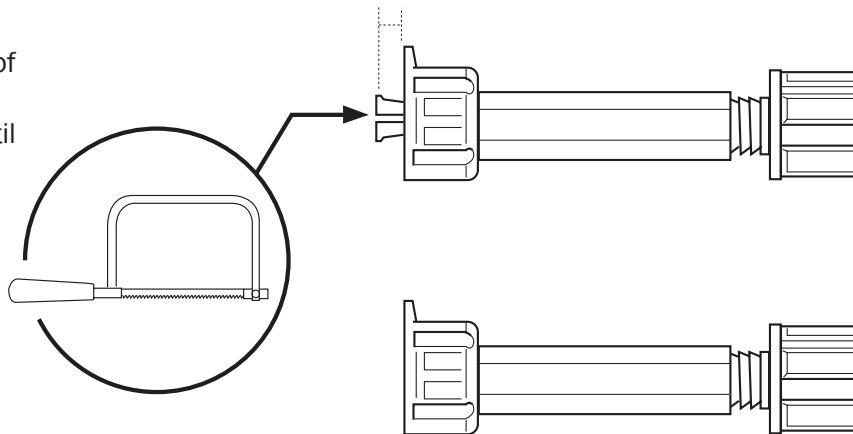

Stage 2

Measure and cut the leg sections following the dimensions shown.

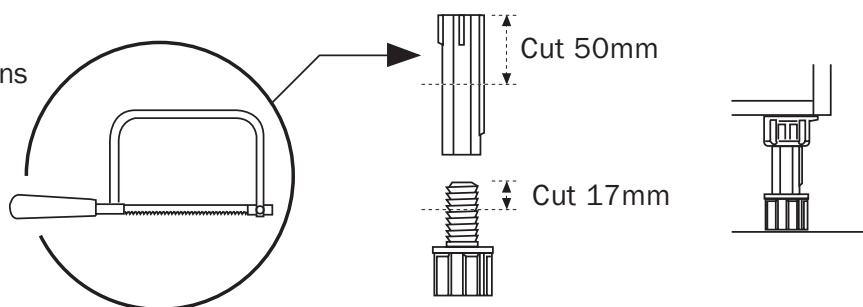

Stage 3

Using a tape measure, mark the underside of your unit following the dimensions shown.
Secure the legs to the underside of the unit using the screws provided.

NOTE: The rear legs are optional if your unit is wall hung.

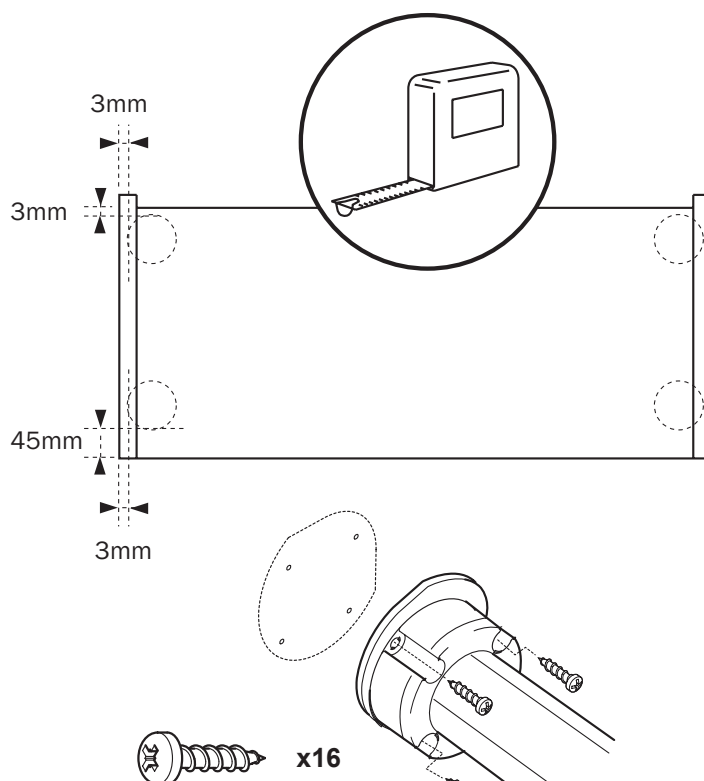
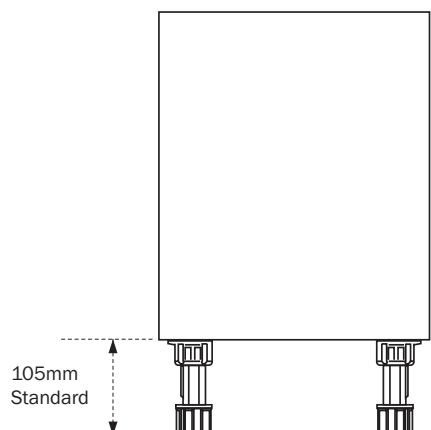

11. Wall fixing & adjustment

Mark the outline of the unit on the wall, then using the dimensions below secure the hanging brackets to the wall.

The optimum height to the top of the wall cabinet is 2000mm.

NOTE: Use suitable wall fixings to secure the brackets to the wall. Fittings have not been supplied for this operation as different wall constructions require different fixings.

Once brackets are fitted locate the unit to the wall aligning the hanging brackets with the wall brackets. See adjustment details (Right).

NOTE: If your unit still has the back rail fitted, secure the bottom of the unit through the rail.

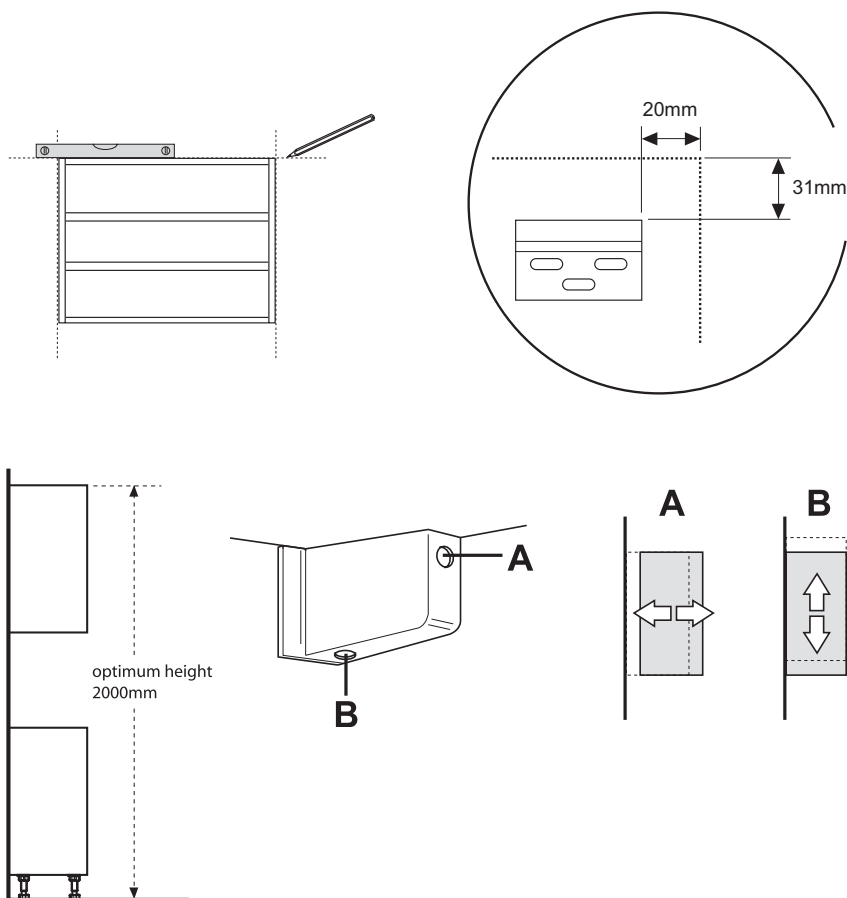

12. Connecting units

Secure the units together, drilling a pilot hole through the cabinet side panel. Use a bradawl to mark through the hole to the adjacent panel then secure using the screws provided.

NOTE: Ensure the units are securely clamped in place before drilling taking care not to force the units out of line.

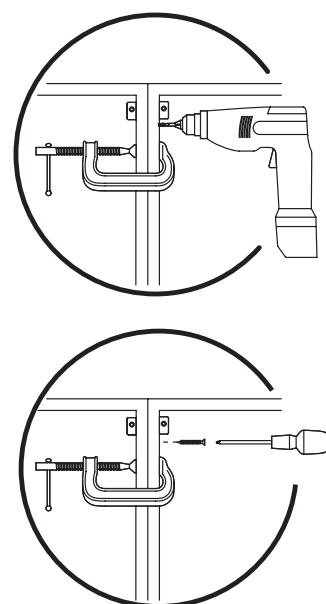
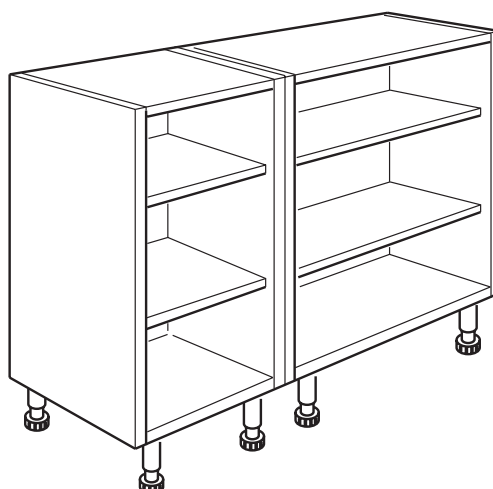

13. Decor ends

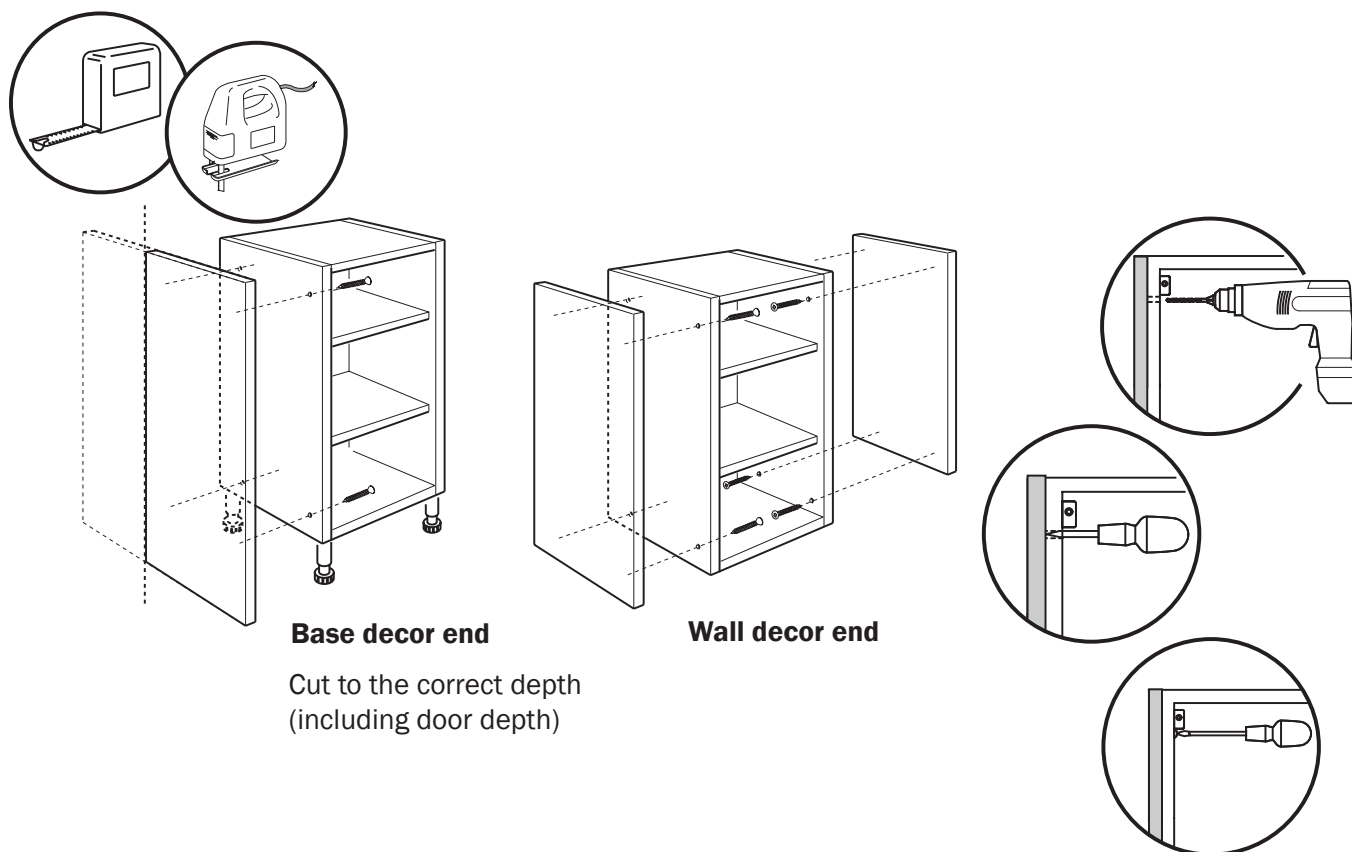

In some installations the fitting of decor end panels may be required. Wall decor end panels are supplied cut to size.

If you are fitting a decor end to a base unit that runs to the floor, the panel supplied will need to be cut to make it the same depth as the unit.

NOTE: If you want your wall decor end to run below the cabinet so a pelmet can be fitted in between, use a tall decor end (see cornice and pelmet fixing on page 22).

Position panels to the side of your unit and from the inside of the unit drill a 5mm hole.

Use a bradawl to spike the clad on end from inside the hole, then secure using the screws provided.

14. Cornice & pelmet

Carefully measure the cornice/pelmets and cut to the required lengths. Mitre any corners as appropriate if a return cornice/pelmet is required. Secure using the screws provided.

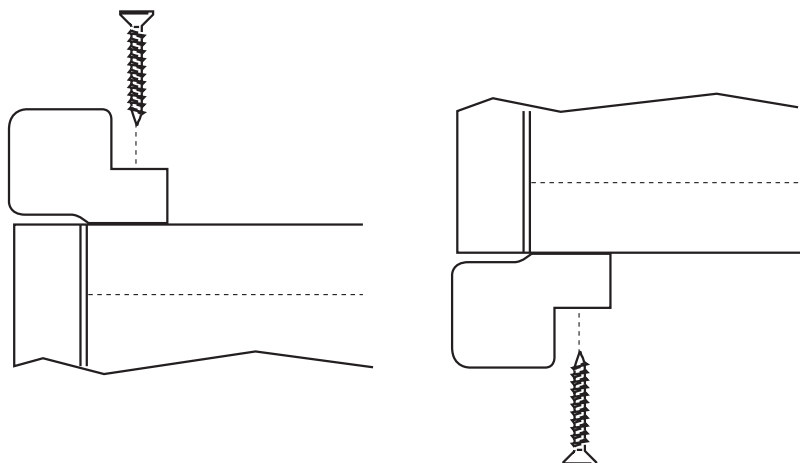

Alternative Cornice Fixing Method

Position a small piece of cornice on top of the cabinet to determine the position of the fitting. Secure the fitting onto the cabinet using the screws provided. Gently tighten and check that the cornice is correctly positioned.

Position the fittings on all wall cabinets as required, see installation example below.

Once cabinets are secured to the wall, position the mitre bonded cornice sections and gently tighten all the fittings by hand, just enough to hold the cornice securely.

We recommend one fitting is used above each door on a run of cabinets as shown below.

NOTE: All corners must be mitre bonded.

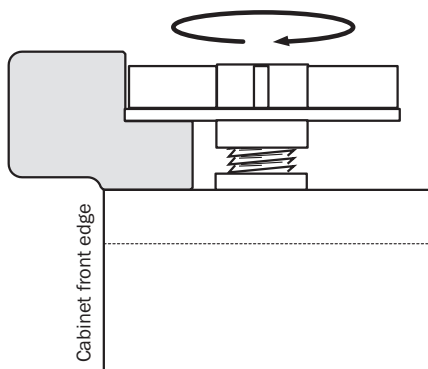
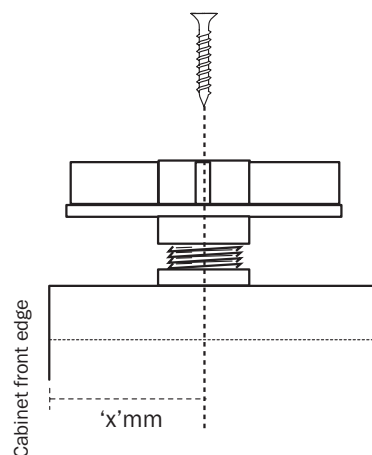
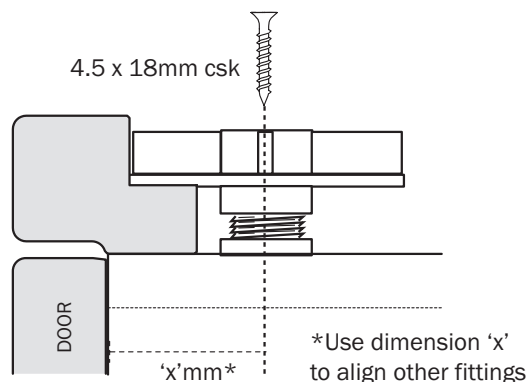

15. Plinth cutting & fixing

Once all units are fitted & level, measure the distance from the underside unit to the floor.

Use this dimension to scribe & cut the plinth to the correct height, removing an additional 5mm to allow for the sealing strip (see below).

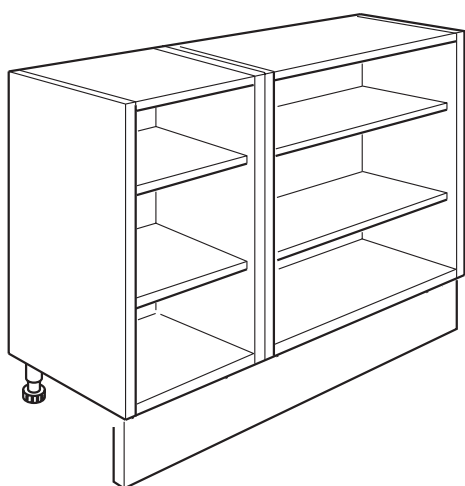
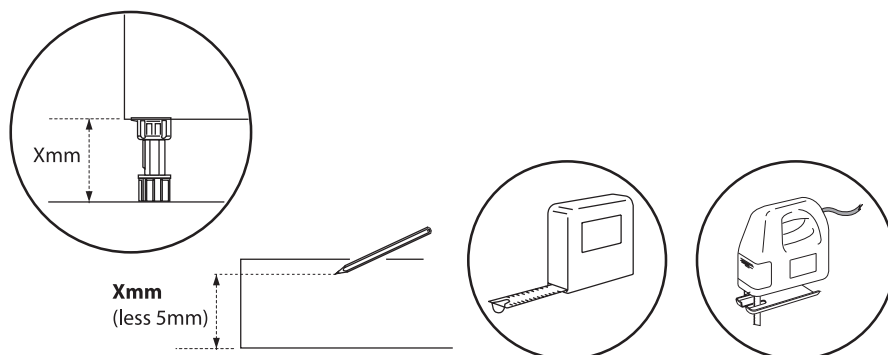

Measure and cut the plinth to the correct length, making sure the plinth finishes level with the outside edge of the run of units.

Straight Run

Lay the plinth face down and mark the centre of the leg location on the back. Fix the plastic plinth clip brackets screws provided. Slide the clip into the bracket as shown.

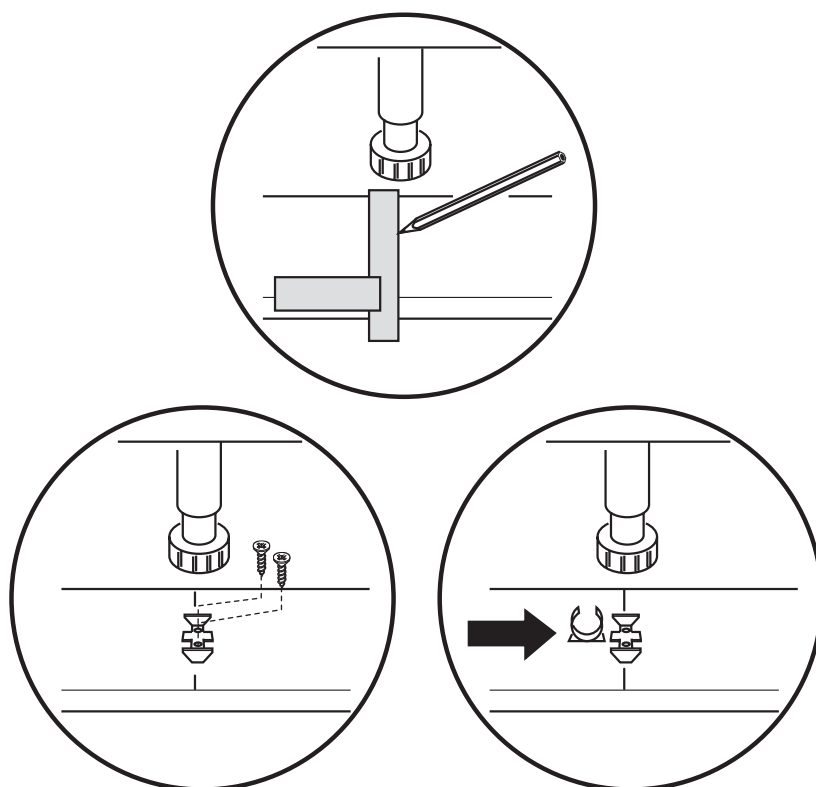

NOTE: Edge banding has been provided to finish exposed ends. Cut to length and apply using adhesive.

A sealing strip has been provided to fit to the bottom edge of the plinth as shown.

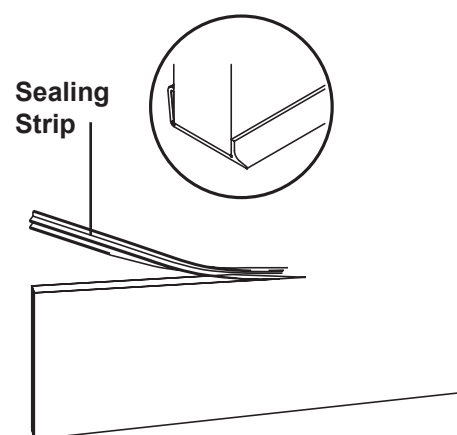

16. Hinge fixing & door adjustment

Hinge Fixing

Fit the door to the cabinet, aligning the plastic pegs on the hinge plate with the holes in the cabinet. Firmly push into place. Tighten screws on the hinge plate, expanding the pegs to secure.

Step 1 - Fit hinge to door

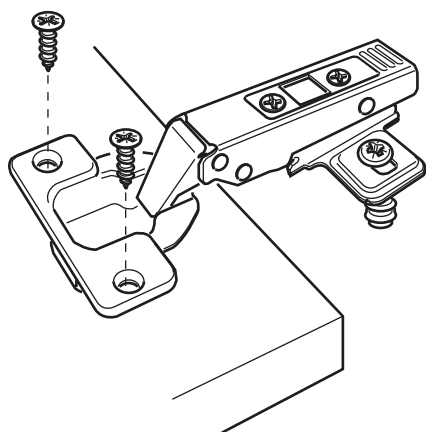

Step 2 - Fit door aligning plate

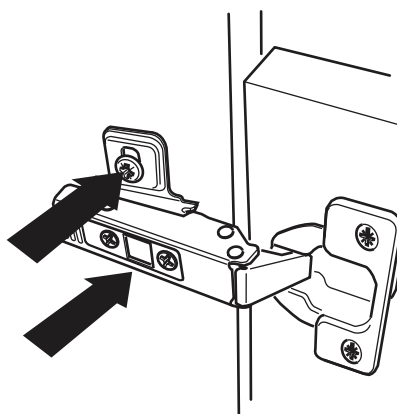

Step 3 - Tighten

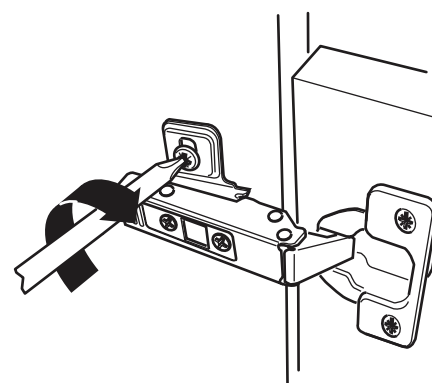

Door Adjustment

Once you have fitted your door, use the diagrams below for adjustment of the hinge.

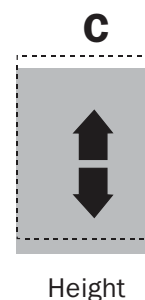
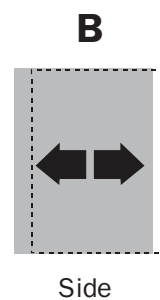
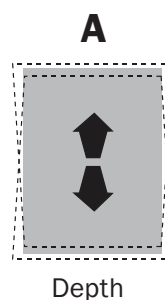
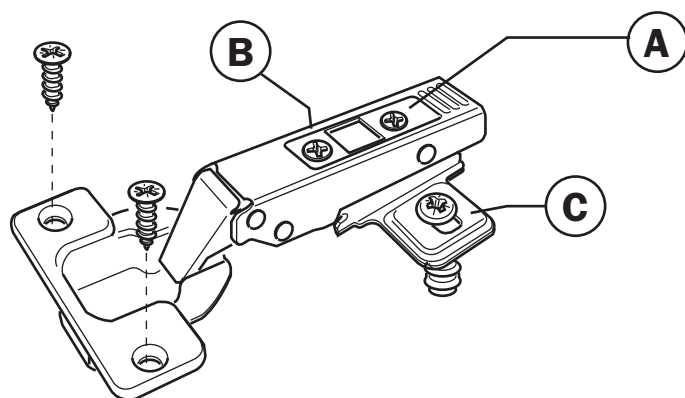

Notes

Notes

