

INSTALLATION MANUAL

LAMONA WASHING MACHINE LAM8702/03/20/40 HJA8901



Generic instructions, (To be used in conjunction with User Instructions).

- Please read the Installation Manual to ensure safe fitting and use of the appliance.
- The appliance should be fitted by a suitably competent and qualified person.
- Please keep these instructions in a safe place for future reference.
- Danger of suffocation keep packaging material away from children.

LAMONA

EXCLUSIVE TO HOWDENS

WWW.HOWDENS.COM

Safety Information



Two person lift.



Washing machine must be fixed securely and level.



Risk of injury: Beware of sharp metal edges. Use gloves when handling.



This appliance is not designed for stacking with other appliances.



DO NOT PUSH against the washing machine fascia panel.



NOTE: If the electricity cable is damaged it must be replaced by a competent person.



Ensure that all packing and transit protectors have been removed from the appliance before positioning.



Risk of damage to property: Take care of surrounding area when moving the appliance to prevent damage to flooring, wall coverings, pipes etc..



DO NOT KINK HOSES BEHIND MACHINE!
Machine will not work properly.

Throughout this manual the following symbols are used.

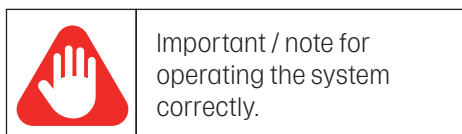
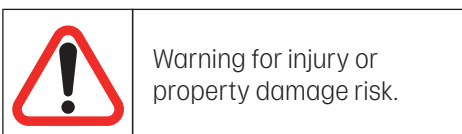
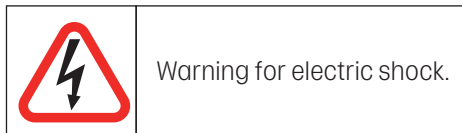

Installation overview guide

- | | |
|--|--|
| 1. REMOVE TRANSIT POLY BLOCK.....p.4 | 8. Positioning the washing machine.....p.9 |
| 2. REMOVE TRANSIT BOLTS.....p.4 | 9. Check machine fills and empties.....p.10 |
| 3. Dimensions.....p.5 | 10. Fit decor door and magnetic catches.....p.10 |
| 4. Fit fascia fillet and anti-tilt support.....p.5 | 11. Raise and level the machine.....p.11 |
| 5. Prepare the decor door.....p.6 | 12. Drain hose and filter.....p.12 |
| 6. Washing machine connections.....p.7 | 13. Plinth.....p.12 |
| 7. Connecting water hose.....p.8 | |

Tools required

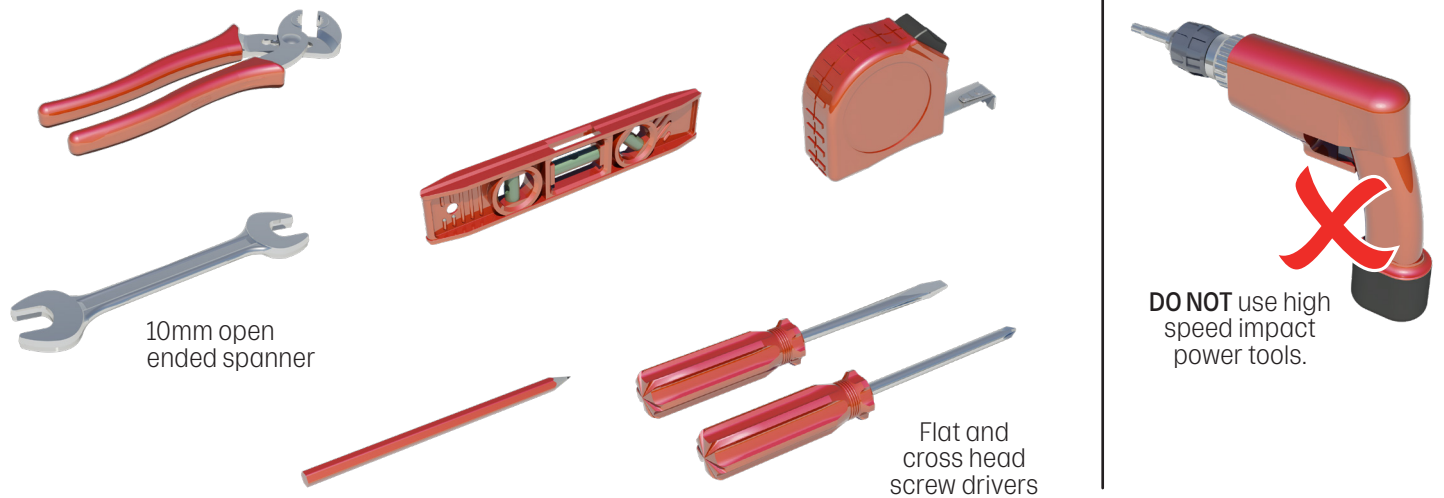

Installation

Parts supplied



1 - Remove transit item



**IMPORTANT:
REMOVE POLY BLOCK.**



2 - Remove transit bolts

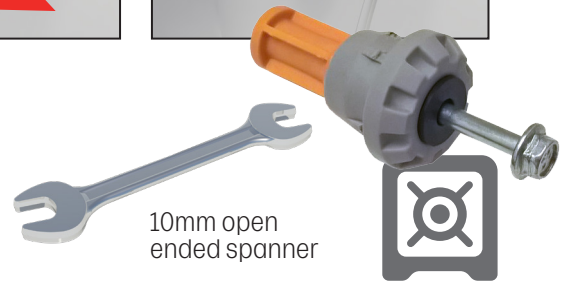
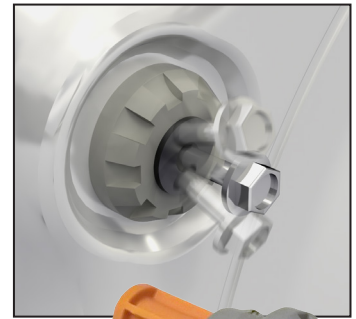
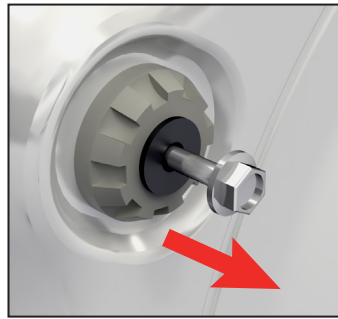
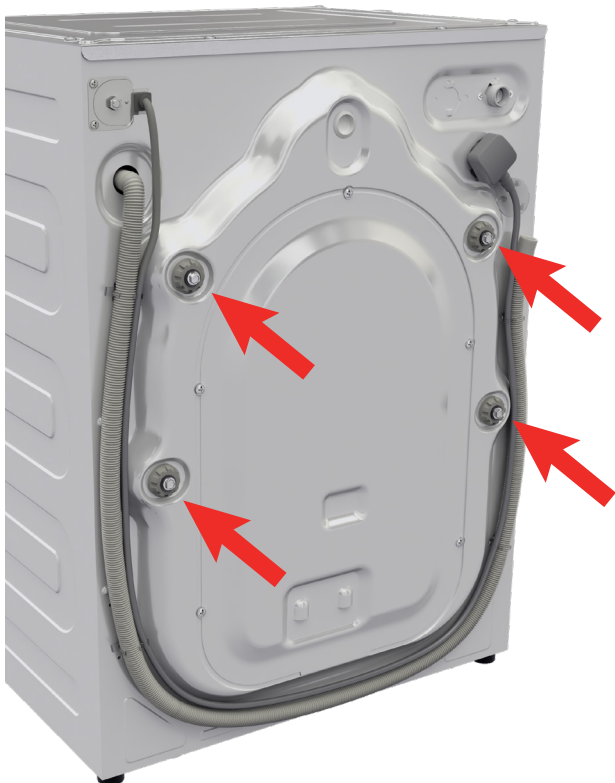

10mm open ended spanner

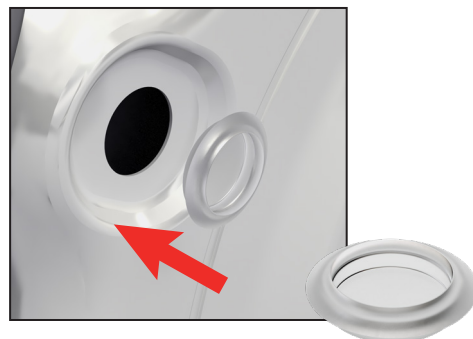

3 - Dimensions

Position the washing machine relative to service connections.

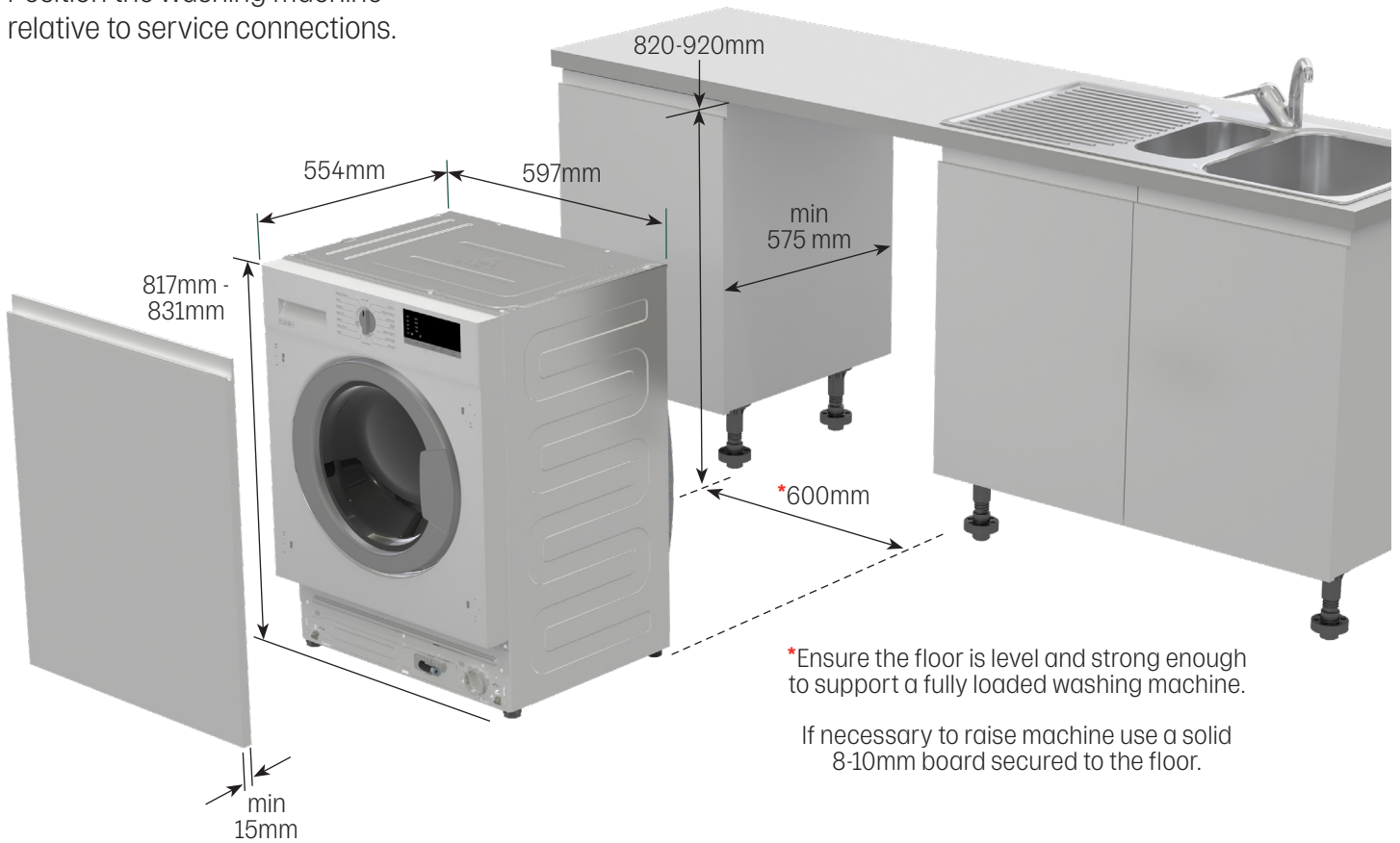

4 - Fit decor fillet and anti-tilt block

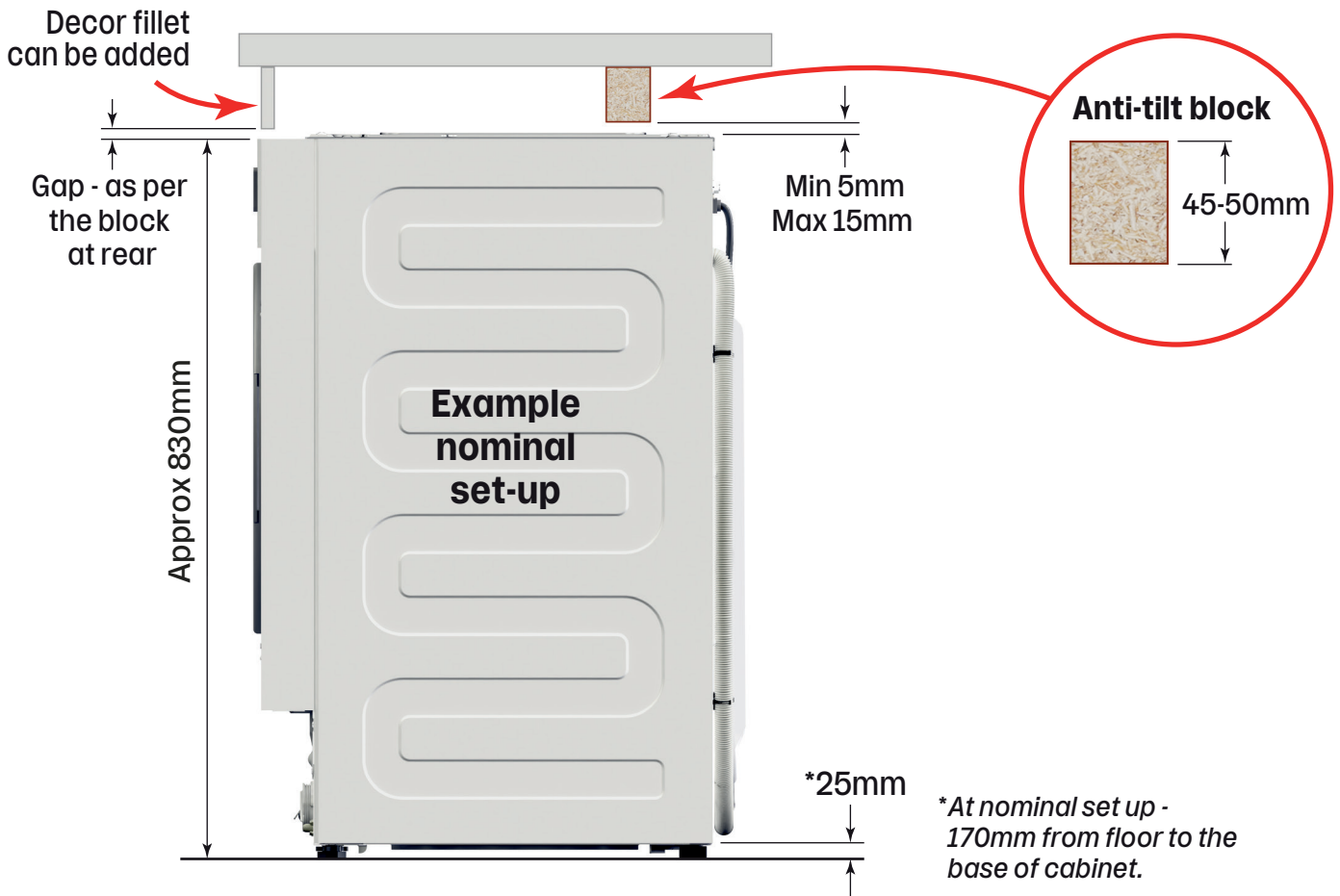

5 - Prepare the decor door

Left hand hinged door opening shown, (right hand opposite).

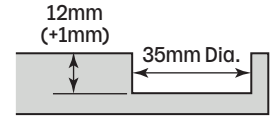
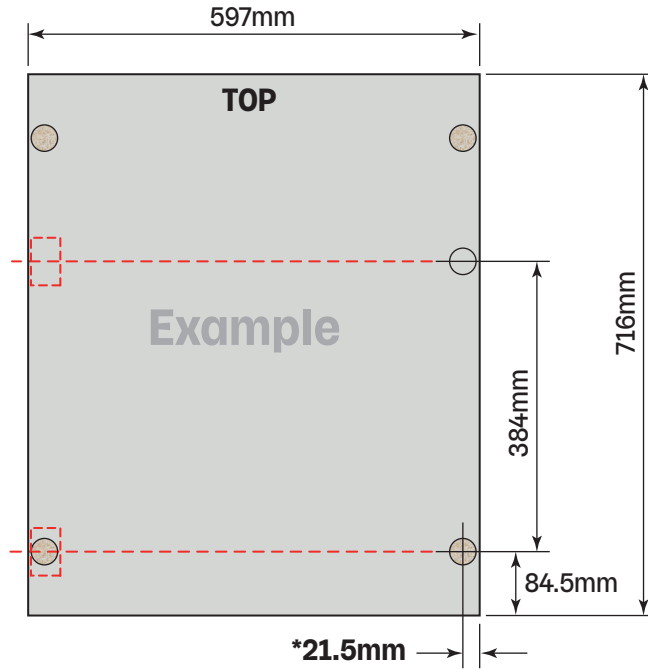

***Check and drill hole according to the actual hole drilling position of door frontal range being used.**

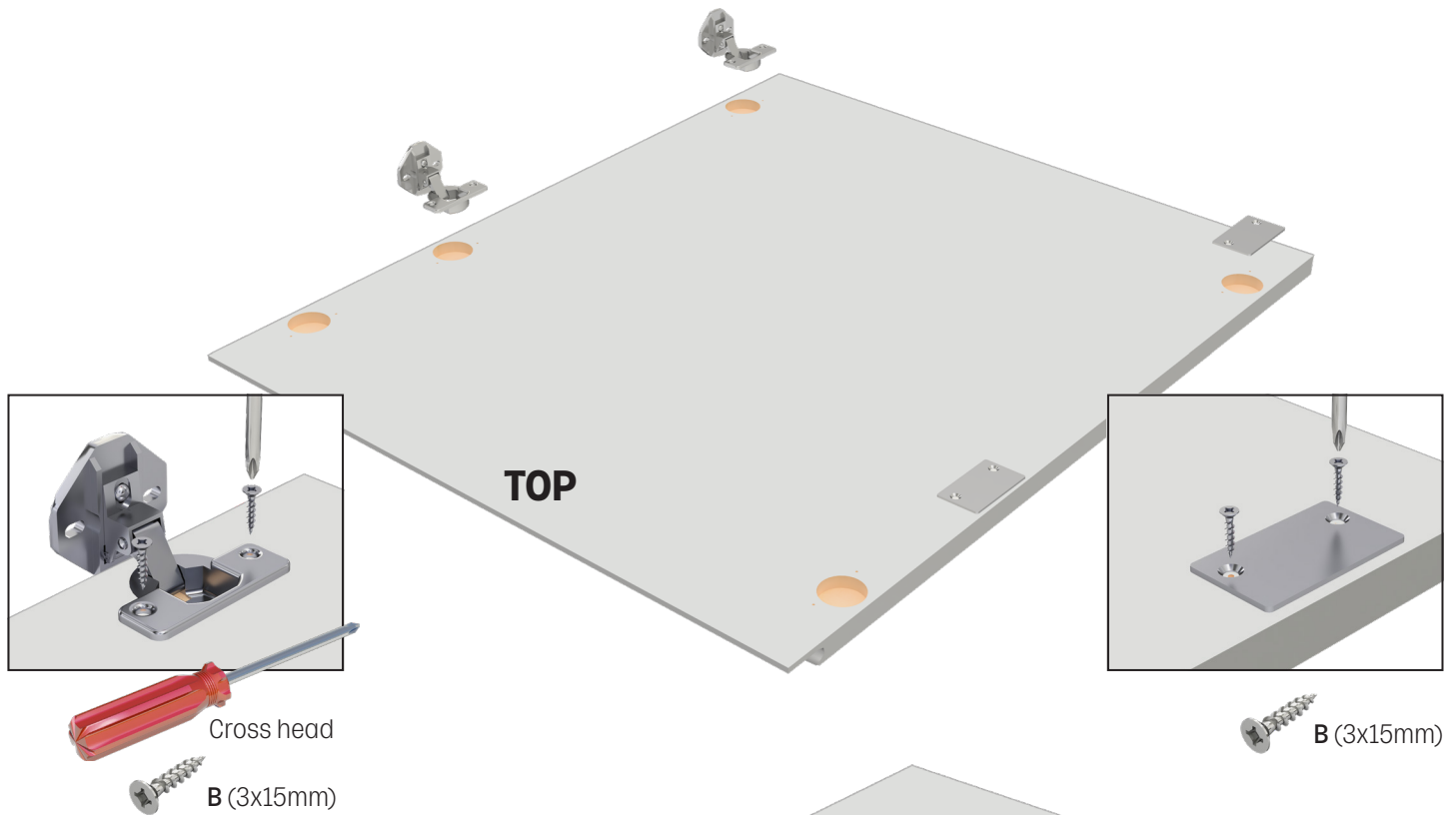

If required, fit handles at this stage, (screws may need countersinking and sealing).

6 - Washing machine connections

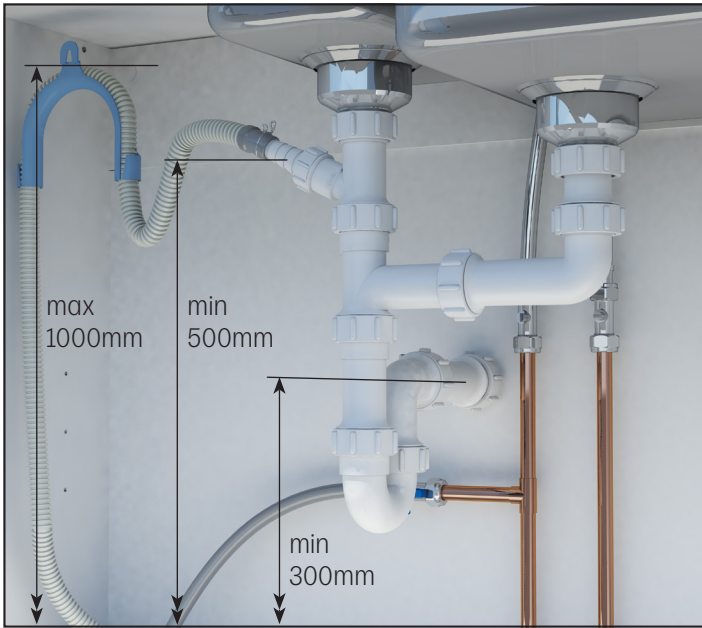

All dimensions are to the floor.

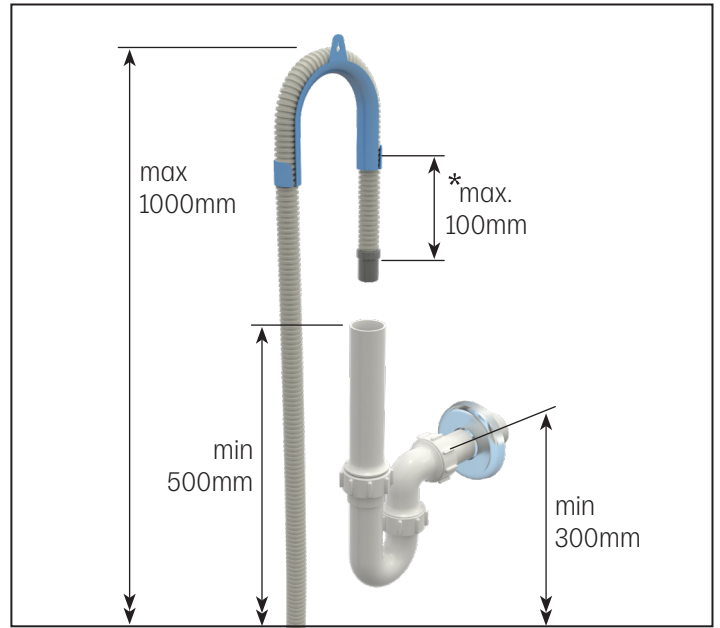

***DO NOT** insert the hose too deep into the waste pipe, (Maximum hose length, 3.2 metres).



**DO NOT KINK HOSES
BEHIND MACHINE!**

Machine will not work properly.

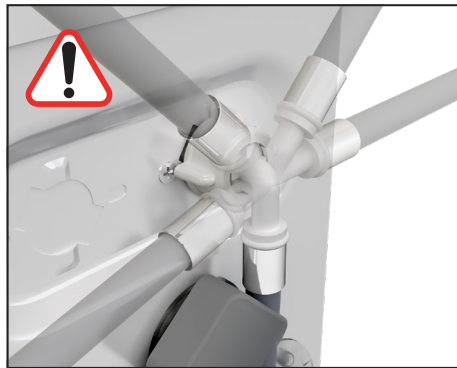

NOTE: If necessary loosen and rotate the water hose towards the water supply and re-tighten. (Always use the new hose supplied with the washing machine).

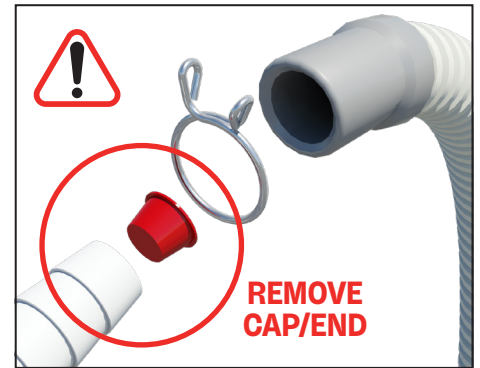

Ensure cap/end is removed from waste pipe spigot.

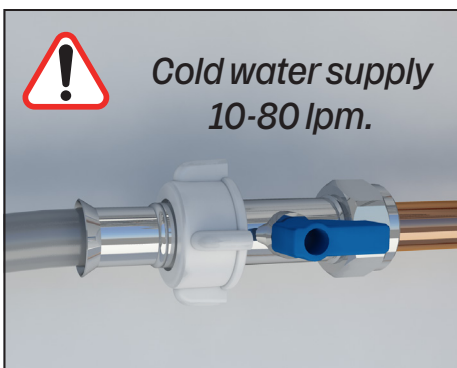

Ensure water is turned on and the isolator valve is **accessible after fitting.**

Hose connection - 3/4".
Cold water pressure -
0.3 -10 bar (0.03-1.0 Mpa)

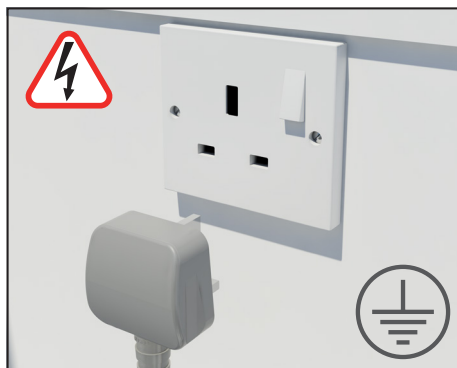

WARNING! This appliance must be earthed. (Socket must be accessible after fitting).

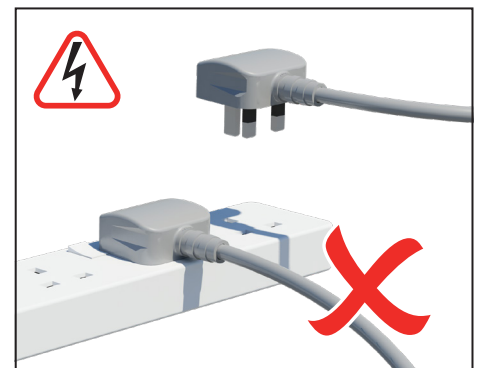

WARNING! Do not use extension cables / adapters.



Incorrect waste pipe configuration.

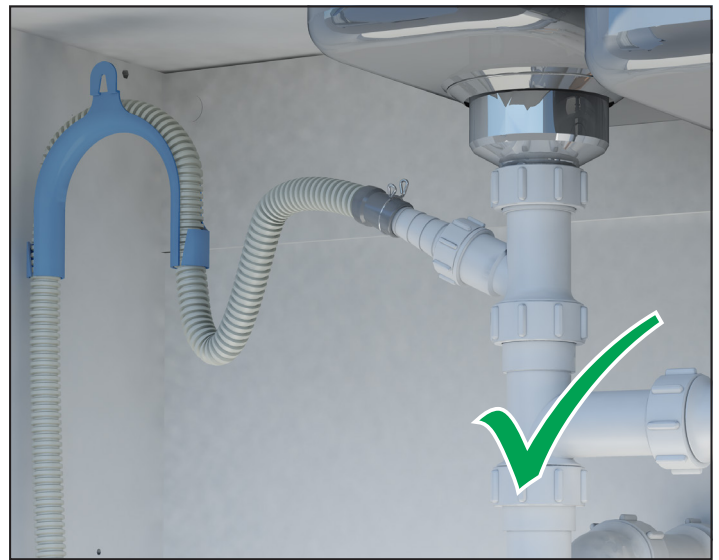

Correct waste pipe configuration.

7 - Connect water hose (cold water supply only)

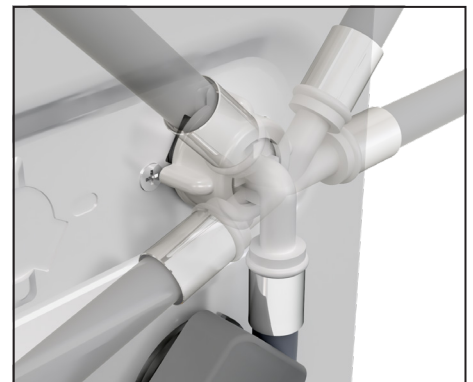

NOTE: Rotate the water hose towards the water supply and hand tighten. *(Always use the new hose supplied with the washing machine).*

8 - Positioning the washing machine

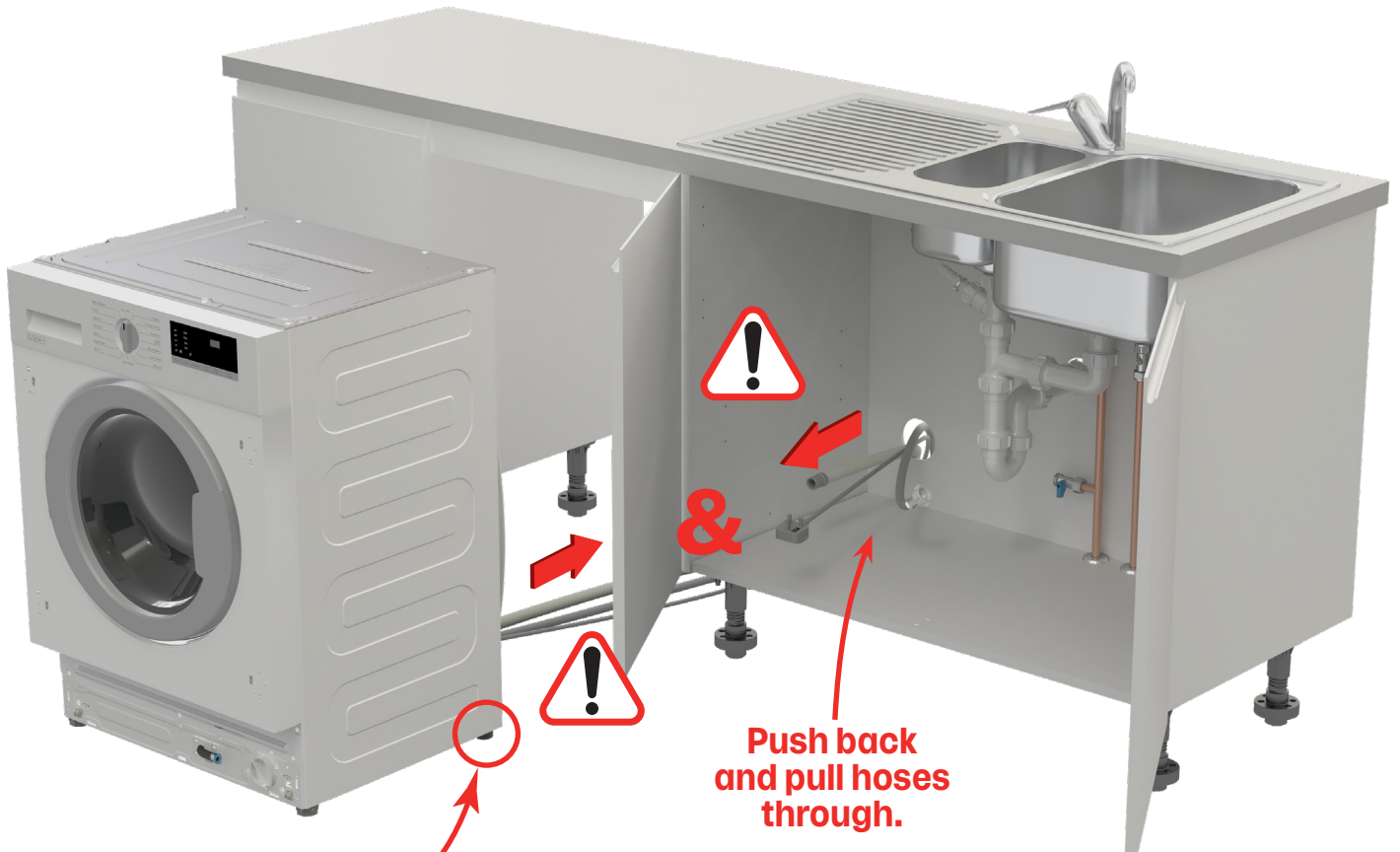

DO NOT adjust the rear feet until in final position, (NEVER move the washing machine with the rear feet extended).



DO NOT KINK HOSES BEHIND MACHINE!
Machine will not work properly.



DO NOT PUSH against the washing machine fascia panel display area.

9 - Check machine fills and empties without problem.

Select rinse program and check machine fills and empties without problem. Check for leaks.

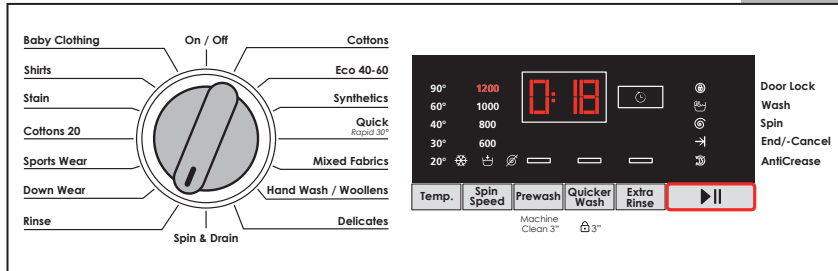

10 - Fit decor door and magnetic catches

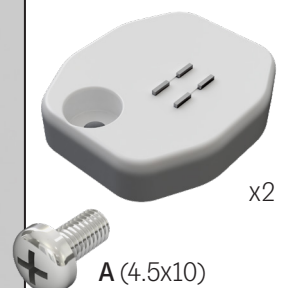
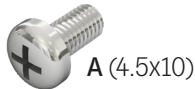

11 - Raise and level the machine

Raise and level the washing machine using the front and rear feet.

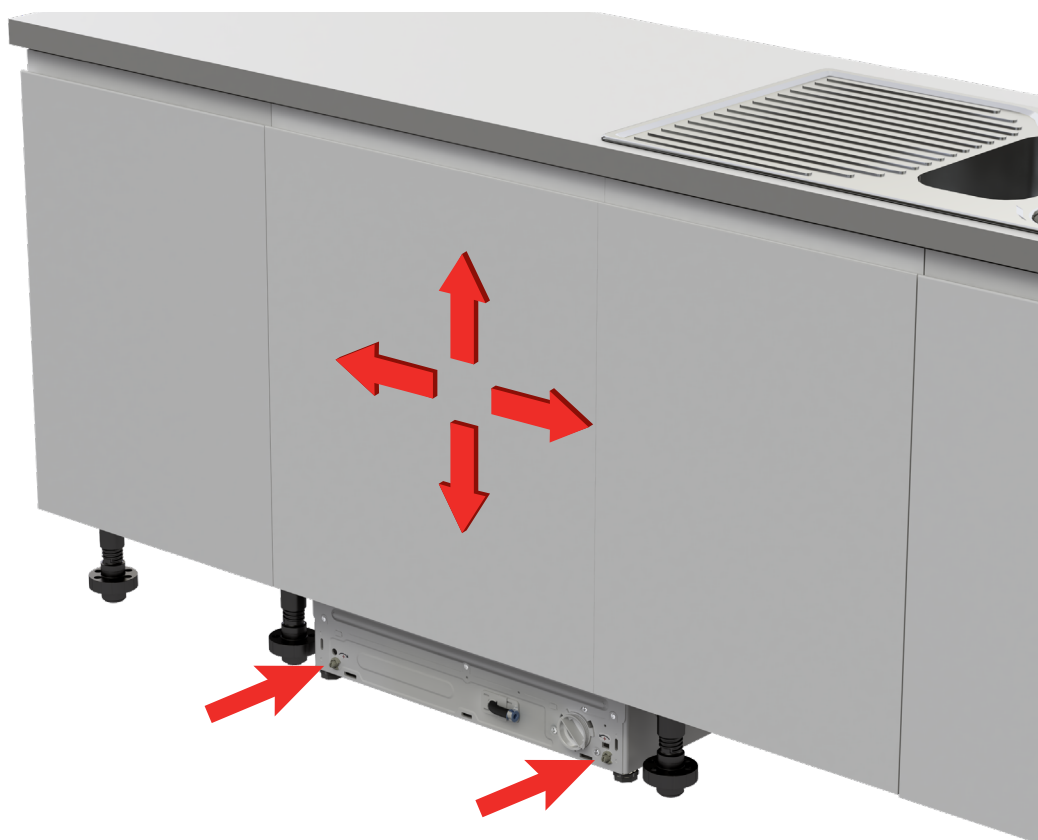

Adjust front feet by hand.

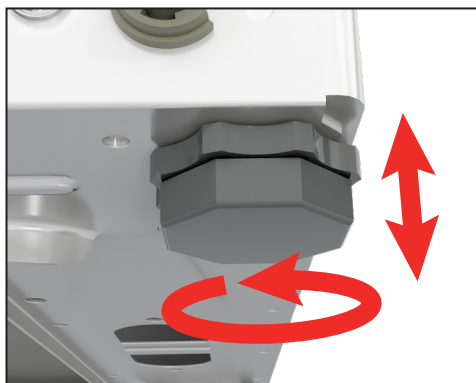

Loosen the locknut(s) and adjust the front feet.

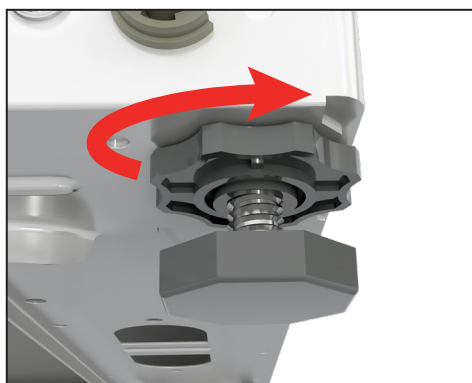

Tighten locknut(s) by hand only.



DO NOT use high speed impact power tools.

DO NOT damage the plastic screw heads.

Adjust rear feet by using front screws.

NOTE: The rear feet screw adjustment is handed.

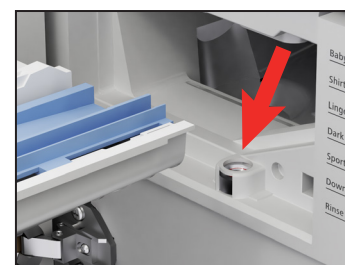
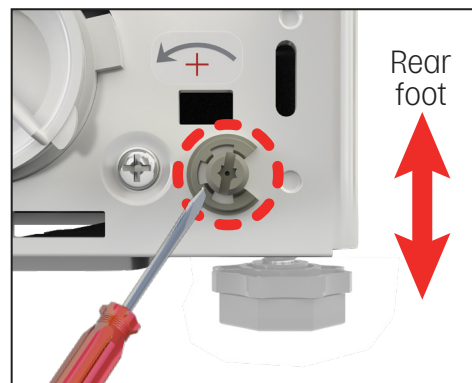
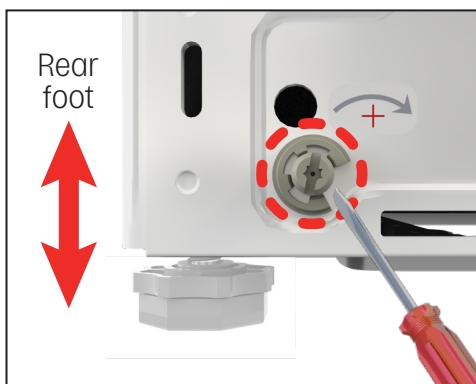

Final check for level, remove the detergent drawer and view the spirit level.

If machine needs to be raised further to align frontal etc; use a solid 8-10mm board firmly secured to the floor

12 - Drain hose and filter

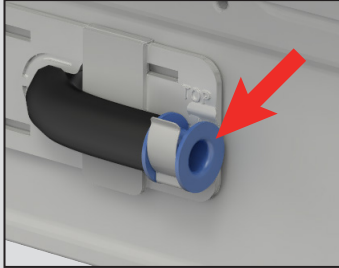
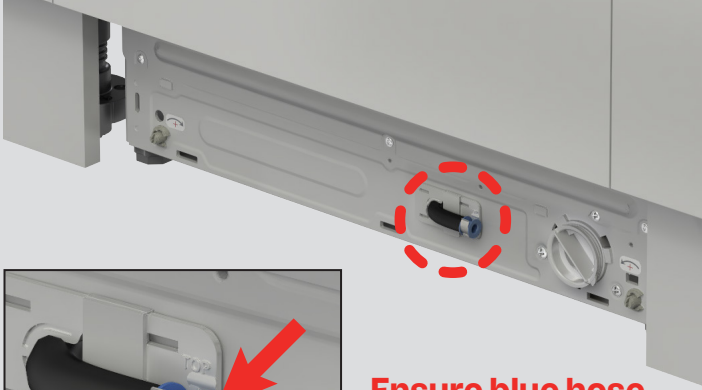

Ensure blue hose cap is present - DO NOT turn water on if cap is missing.

13 - Plinth

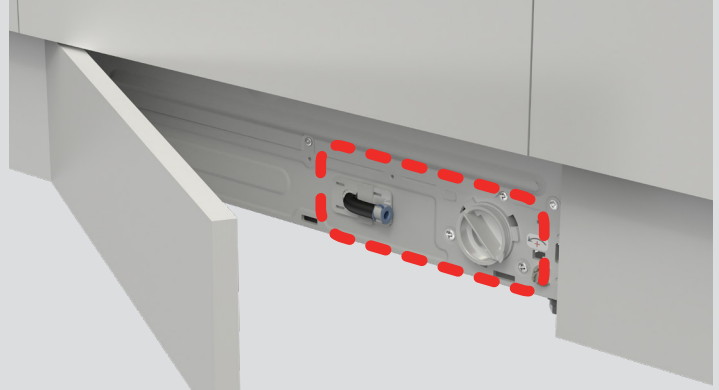

We recommend the length of plinth in front of the washing machine is easily removable for easy access to drain hose and filter.

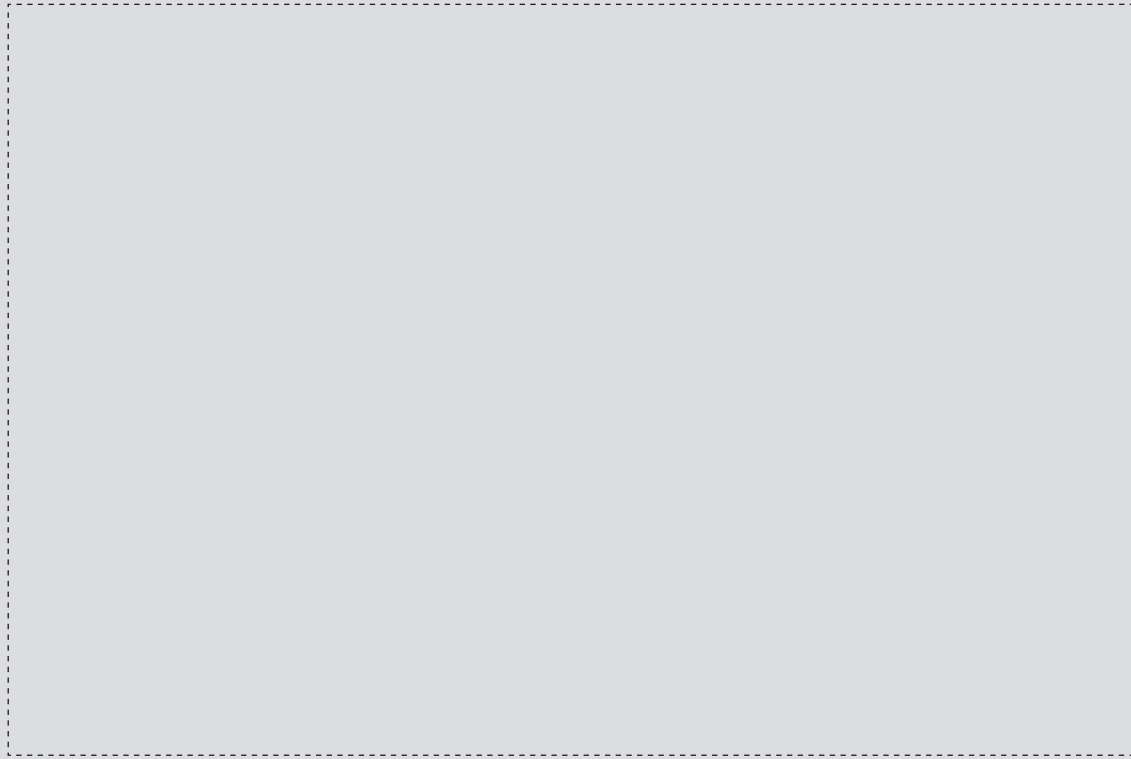

Product serial number



Howden Joinery Ltd, Thorpe Road, Howden, East Yorkshire, DN14 7PA

Product information correct at the time of publication in February 2020. The company has a policy of continuous product development and reserves the right to change any products and specifications given in this manual. Subject to the Terms and Conditions of Trading, a copy of the Howdens Terms and Conditions is available upon request.

Copyright © 2020 Howden Joinery Ltd. All rights reserved.



2820529142_V1

029010AA