

LAMONA

At the heart of the kitchen

Built-In Coffee Machine

LAM9100



- Please read the Installation Manual to ensure safe fitting and use of the appliance.
- The appliance should be fitted by a suitably competent and qualified person.
- Please keep these instructions in a safe place for future reference.
- Danger of suffocation. Keep packaging material away from children.

Installation Instructions

ISSUE v1.0 14-03-23

Register
my appliance

www.howdens.com/appliance-registration

Warning & Safety Information

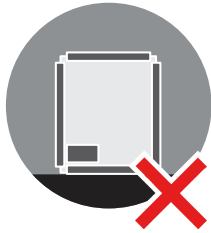

Ensure packaging & transit protectors have been removed before positioning



2 Person lift



Beware of sharp glass / metal edges. Use gloves when handling

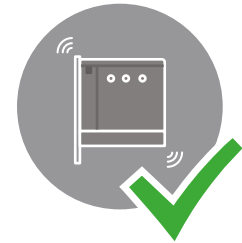

Be aware of the instability of the appliance prior to being fitted into position



If the electricity cable is damaged, it must be repaired by a competent person



Ensure all doors are shut and water tank firmly in position before installing



Do not push against the coffee dispenser, service door / water tank

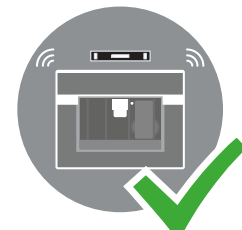

Appliance must be securely installed and be level

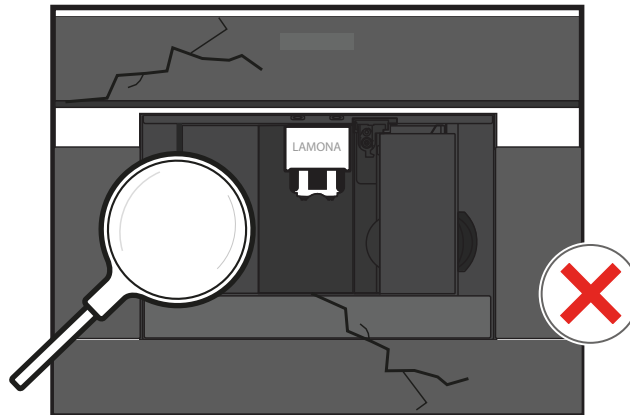

Check for visual damage. If damaged, do not use.
See guarantee: What to do if you need to report a problem.

Throughout this manual the following warning symbols are used.



Warning for serious injury or death risk



Important / note for operating the system



Warning for electric shock



Warning for injury or property damage risk



Warning & Safety Information (continued)

 Please read these instructions carefully, observing the technical data and specifications. The manufacturer is not responsible if an incorrect installation and use causes injuries and/or damage. Please take appropriate care when installing. This appliance complies with all relevant E.U. Directives.

Electrical Connection

Before connecting this appliance, ensure that the connection data on the data plate (fuse rating, voltage and frequency) match the mains electricity supply. If in any doubt, consult a qualified electrician.

Reliable and safe operation of this appliance can only be assured if it has been connected to the mains electricity supply.

 **WARNING:** The electrical safety of this coffee machine can only be guaranteed when correctly earthed. It is essential that this standard safety requirement is met. Socket outlet and plug must be of the same type.

If in any doubt, please have the wiring system of the building tested by a qualified electrician. **LAMONA cannot be held liable for the consequences of an inadequate earthing system (e.g. electric shock).**

 Do not connect the appliance to the mains electricity supply via...

- a multi-socket adapter,
 - multiple connectors
 - an extension lead or similar
 - an external switching device (such as a timer)
 - Do not connect to a circuit that is regularly switched on and off by a utility
- These do not guarantee the required safety of the machine (fire hazard due to the risk of overheating).

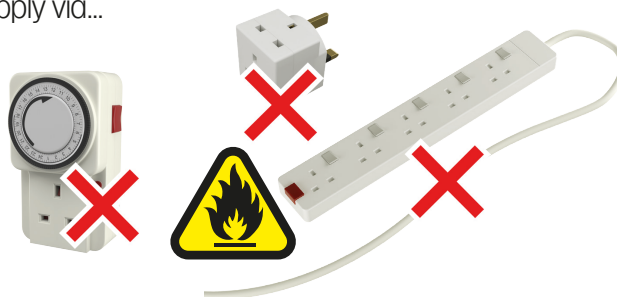

 **The electrical socket must be easily accessible after installation so that the machine can be disconnected from the electricity supply if necessary.**

In the event of a fault, the appliance must be isolated from the electrical supply.

 Do not touch the appliance when hands or feet are damp or wet.

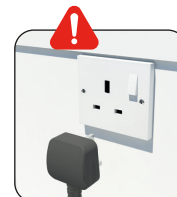

 Avoid damaging the mains plug and cable. If a replacement is required, contact a **LAMONA** authorised service agent, or a suitably qualified person.



Do not power on until correctly installed

Operating voltage: 220 - 240V, 50/60Hz Single Phase.

Supply circuit rating should be rated to at least 10A.

Caring for the environment

Disposal of the packing material

 The environmentally friendly, recyclable packaging is designed to protect the appliance from damage during transportation. All packaging materials should be recycled. Recycling reduces the use of raw materials in the manufacturing process and also reduces the amount of waste in landfill sites.

Packaging of this appliance is recyclable and may include

- Cardboard
- Paper
- Polythene foil (PE)
- CFC-free polystyrene (PS hard foam)
- Polypropylene tape (PP)

 This appliance carries the symbol of a crossed-out dustbin to state that segregated processing is compulsory to avoid any negative effects on the environment and public health. At the end of its life it must be disposed of at a special refuse centre run by your local authority or dealer.

Segregated processing enables the recovery of the materials used in the production of this appliance, thus saving considerably in the terms of raw materials and energy.

Installation overview guide

Installation considerationsp.6

Safe operating temperatures.....p.6

Ventilation and access.....p.6

Dimensions and minimum clearancesp.7

External dimensions.....p.7

Minimum cabinet clearance.....p.7

Installationp.8

Components.....p.8

Preparing the spacers and fixing the runnersp.8

Fixing the coffee machine to the runners.....p.9

Cable management.....p.9

Final alignment.....p.10



Declaration of conformity

We declare that our products meet the applicable European Directives, Decisions and Regulations and the requirements listed in the standards referenced.

EC Regulation 1275/2008 for standby.
UK / EU.

Installation Considerations

! Safe operating temperatures

This appliance is designed to work at temperatures between 10 - 35°C.

DO NOT install in rooms where temperatures may reach 4°C or lower.

The appliance may be damaged if the water freezes.

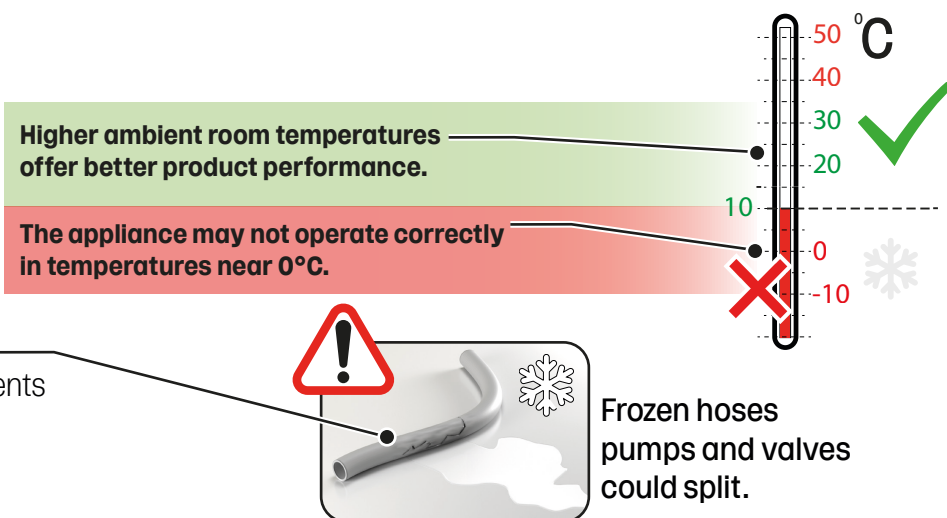

There is risk of damage to valves, pumps, hoses and electrical components if water is allowed to freeze.

! Ventilation and access

- Make sure the socket used is freely accessible at all times, enabling the appliance to be unplugged when necessary.

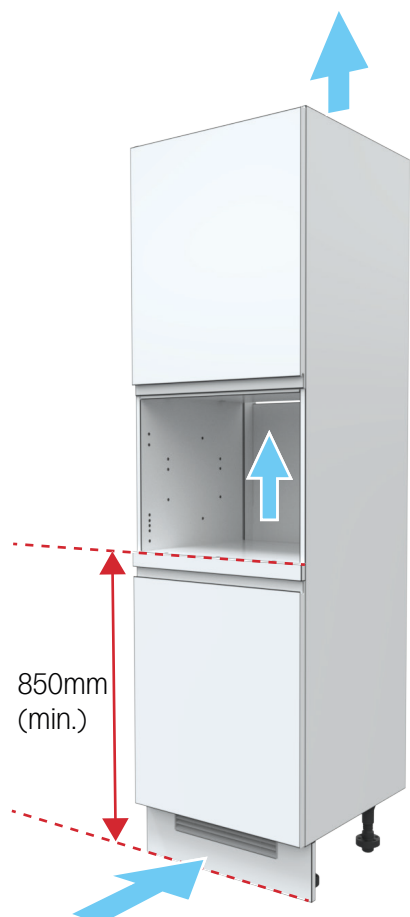

! The appliance must be installed in a tower cabinet which must be fixed to the wall.

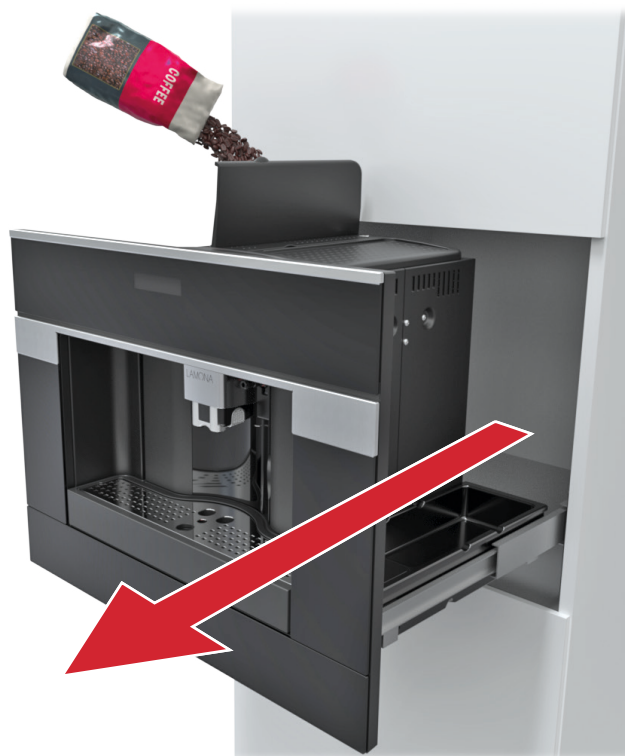

! Do not install this appliance where the normal extraction of the coffee machine on its runners is restricted.

Note: This appliance MUST NOT be used in a non-stationary location.

Dimensions and minimum clearances

External dimensions

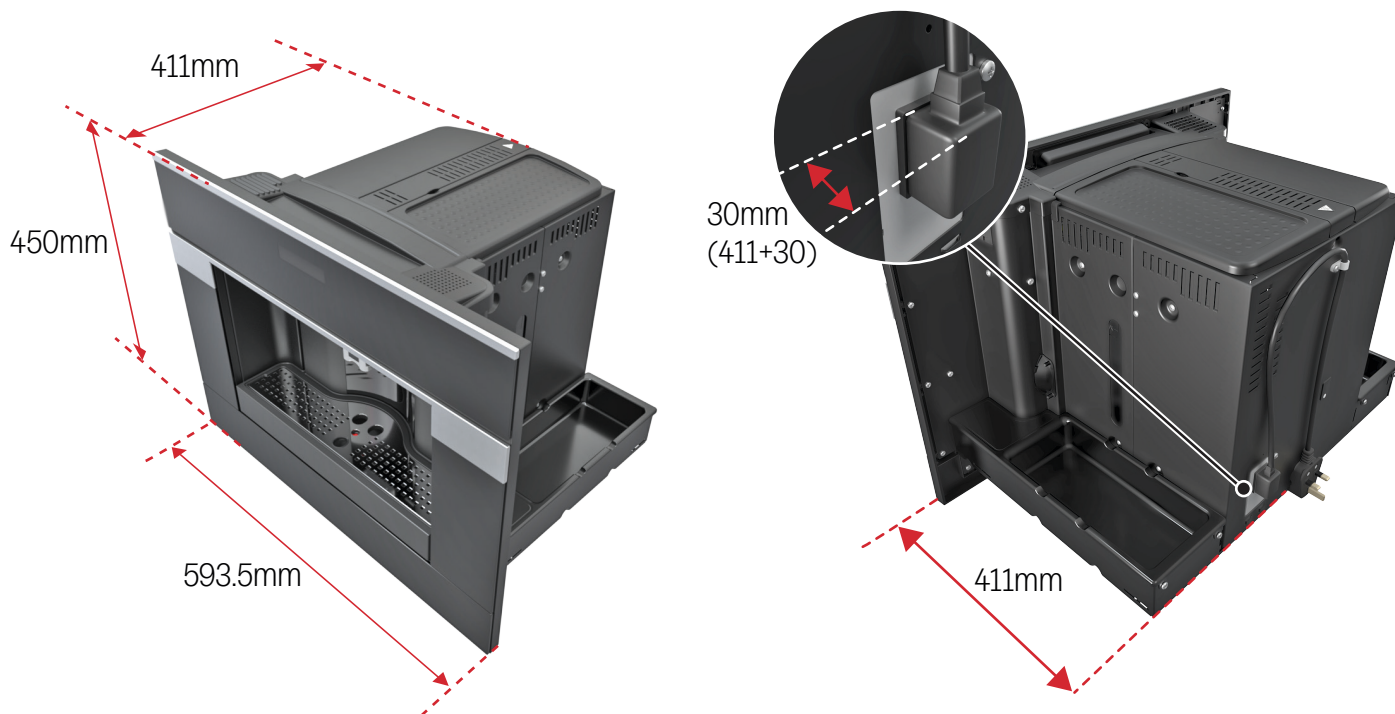

Minimum cabinet aperture

Please check these minimum distances. These are necessary for correct installation of the appliance.

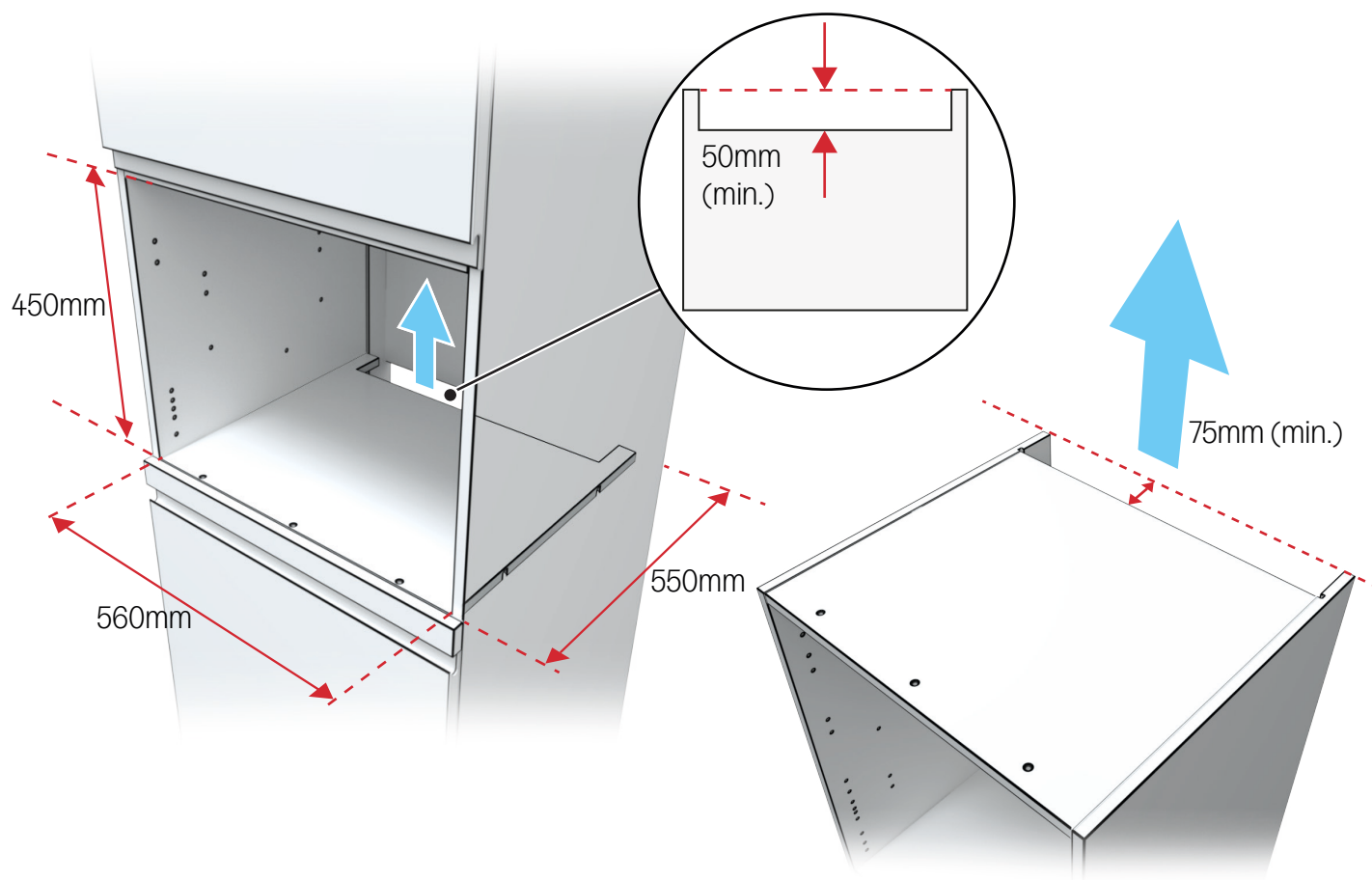

Installation

Components

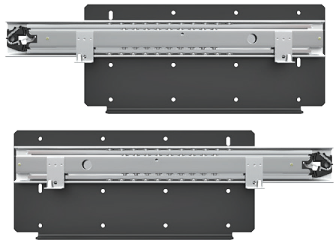

Rails x2 (LH & RH)



Plastic packers x4



1mm Spacer discs x8



Screw x4



Screw x16



Screw x1



Cable clip X1

Preparing the spacers and fixing the runners

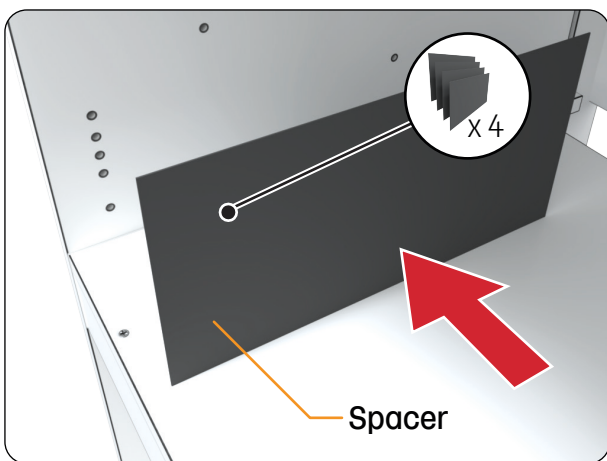

① Use the plastic spacers (2 if necessary) to adjust the cabinet aperture width if required.

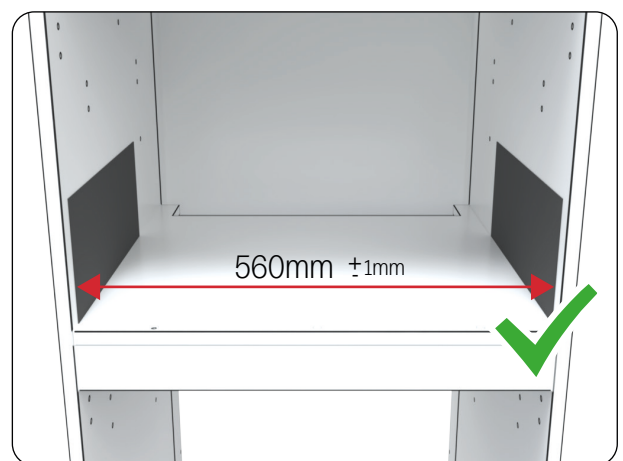

② Check for correct aperture width.

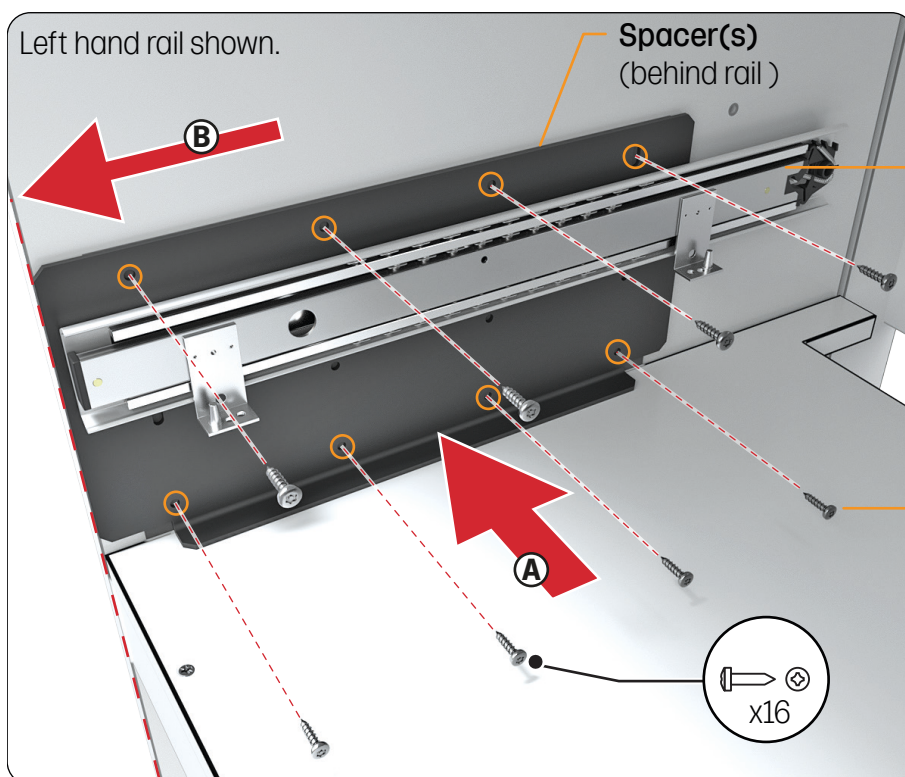

Illustrations show a generic installation. Please refer to the Howdens Kitchen Installation manual.

③ Place the rail on top of the shelf square to the inside of the cabinet (A). This will cover the spacer(s) if they have been used.

Ensure the rail assy is flush to the face of the cabinet (B).

Secure the assy firmly in place using using 8 screws.

Follow the same procedure to fix the right hand rail.

Fixing the coffee machine to the runners

- ① Extend both rails to their full extent (A).

Lower the appliance (B) onto the locating pins ensuring the pins insert correctly into the housing.

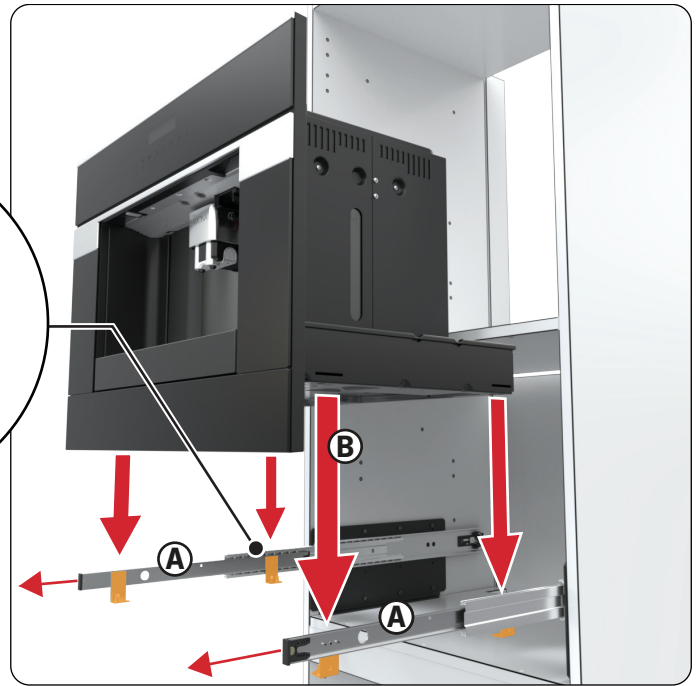
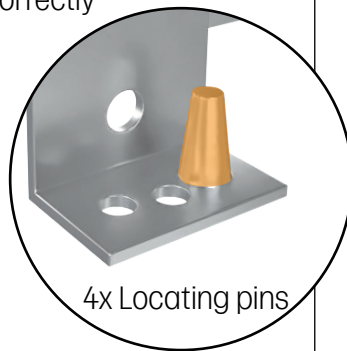

- ② If the height of the appliance requires adjusting use one or more 1mm spacer discs (x8) until the correct height is achieved.

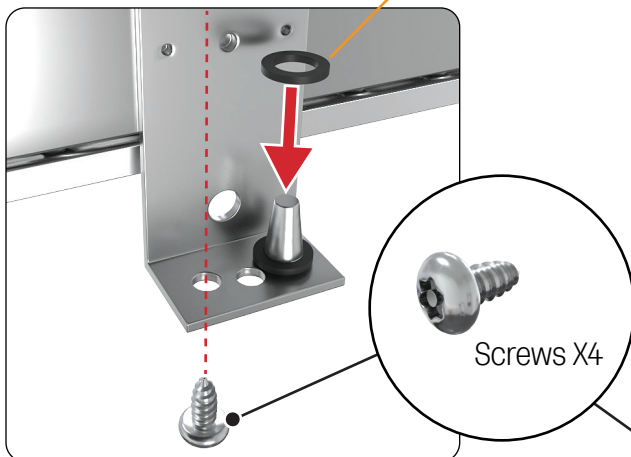

- ③ Secure with 2 screws

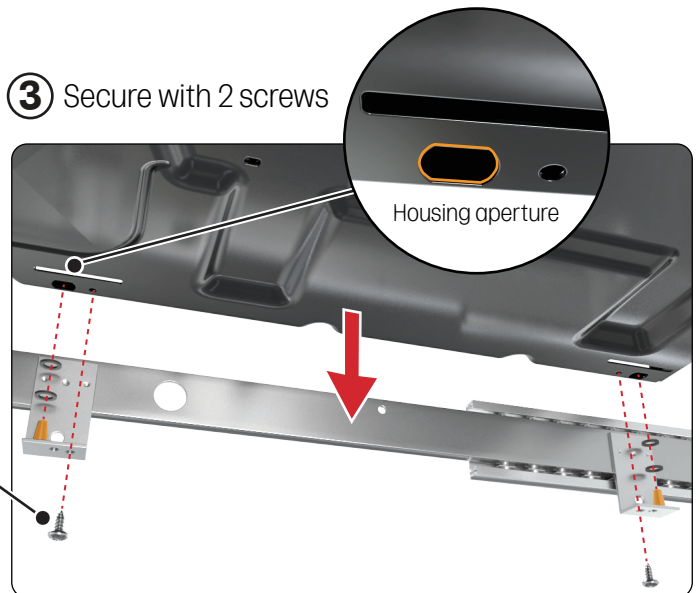

Cable management



⚠ Ensure there is enough cable to allow full extension of the appliance with out straining the power cable.

Secure the cable clip to the bottom surface of the shelf using the screw provided. Screw X1

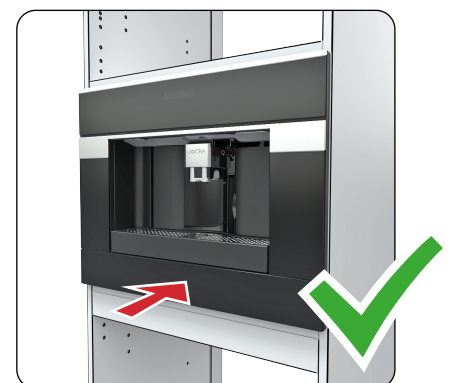

Final alignment

- Adjust adjacent appliances as necessary to achieve correct alignment.
- Add or remove 1mm spacers to the coffee machine as required.

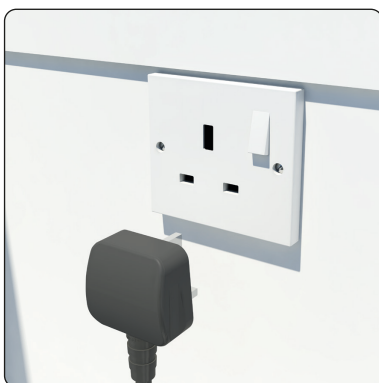
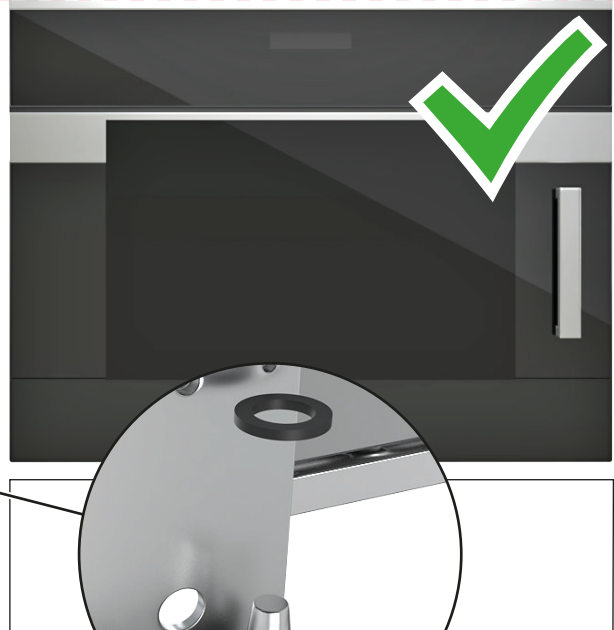
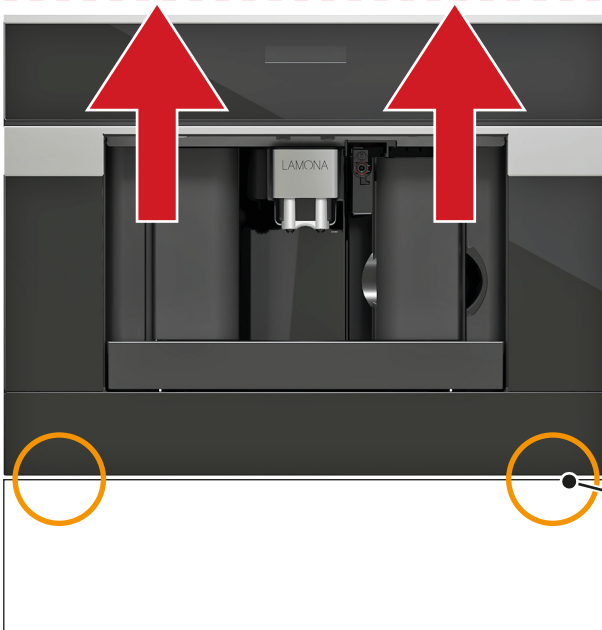
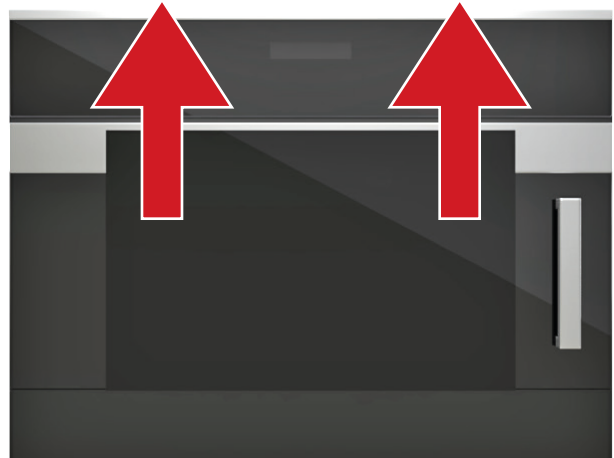
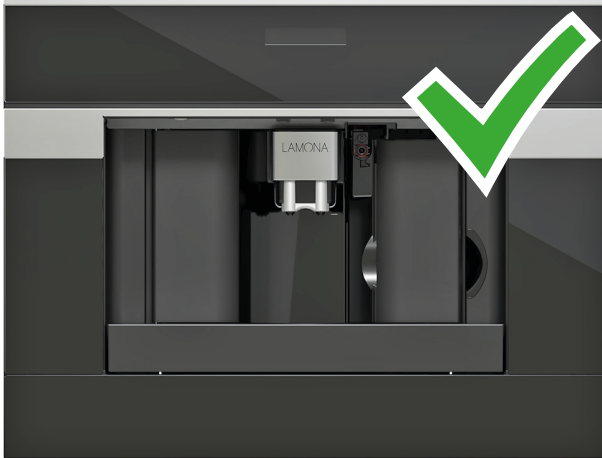
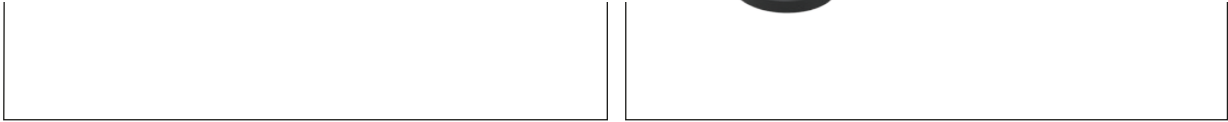

Connect the plug to a correctly earthed power socket.

The coffee machine is now installed. Please refer to the user manual for initial set-up and use.





Product serial number
(Place sticker here)

LAMONA



Product information correct at the time of publication in April 2021.
The company has a policy of continuous product development and reserves the right to change any products and specifications given in this manual. Subject to the Terms and Conditions of Trading, a copy of the Howdens Terms and Conditions is available upon request.
Copyright © 2021 Howden Joinery Ltd. All rights reserved.

Howden Joinery Ltd.
Thorpe Road, Howden, East Yorkshire. DN14 7PA England
Howdens Cuisines SAS. Z.A. du Bois Rigault Nord,
1 Rue Calmette, 62880 Vendin-le-Vieil, Cedex, France