

Do not use abrasive cleaning products as these may scratch the surface of the sink

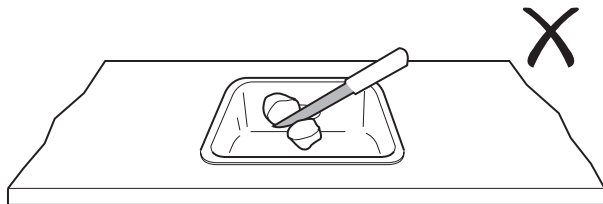

Do not cut on or drag objects across the sink

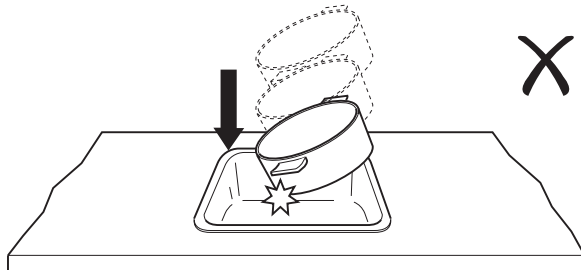

Do not drop heavy objects onto the sink

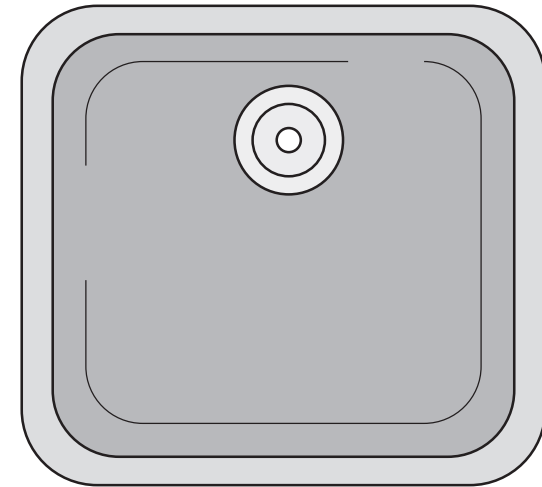

LAMONA
Exclusive to Howdens Joinery Co.

Installation

Measure and Cut

WARNING: SHARP EDGES

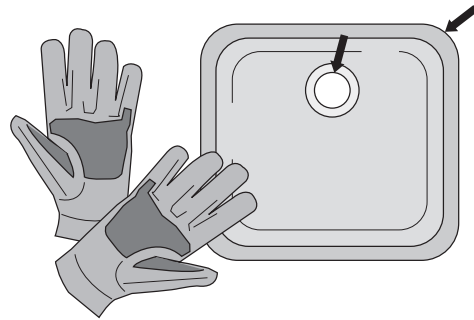

1 Use the measurements below.

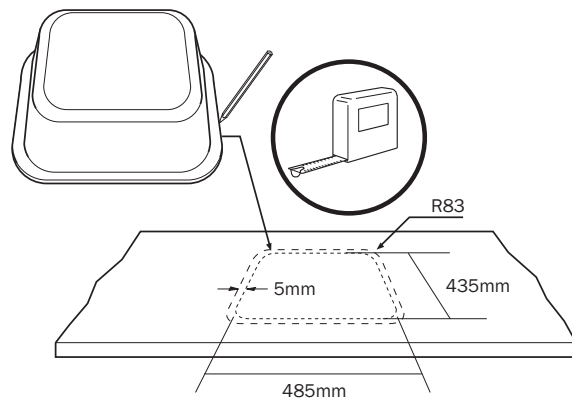

2 Cut inner line.

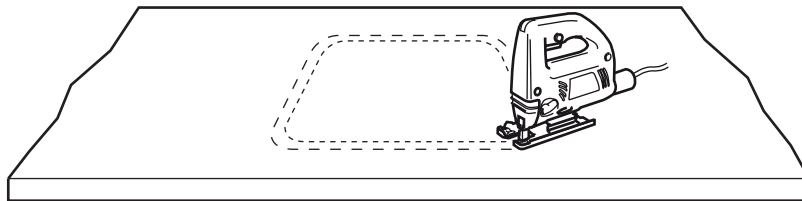

3

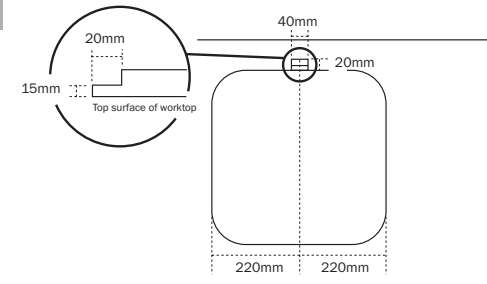

Using the dimensions shown, cut out the rebate for the overflow pipe from the underside of the worktop.

4

Fitting

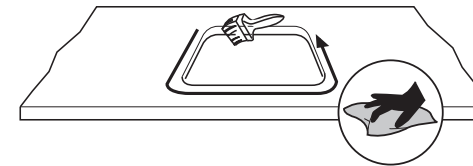

Apply sealant to the cut edges, then wipe around the cut out surface edge.

5

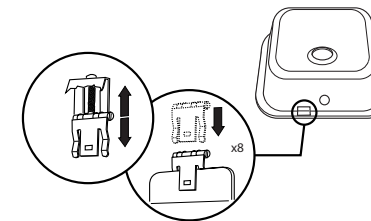

Split the two clip sections, then fit the lower part to the fixing plates on the bowl.

6

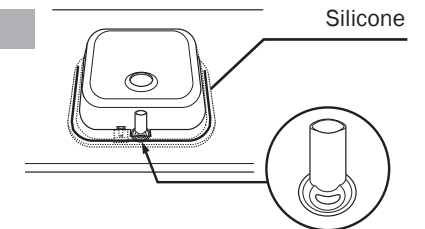

Fit the seal or for a more flush finish exclude the seal and use silicone.

Fit the bowl to the worktop making sure the sealer strip around the edge (if fitted) is correctly positioned. Fit the overflow back box.

7

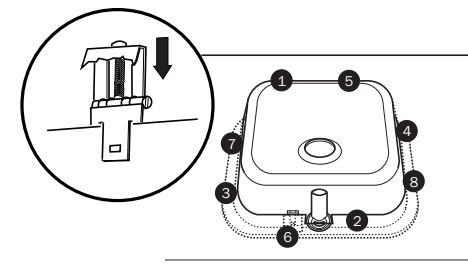

Fit the top part of the clips and secure so they bite into the underside of the worktop.

Check the sink position before fully tightening the clips.

Note: Secure clips around the bowl following the numbering order shown.

Back Edge