

Installation

Waste Kit Fitting

- 1 Fit waste (A) and overflow (B) with the extra long screws supplied with the sink.

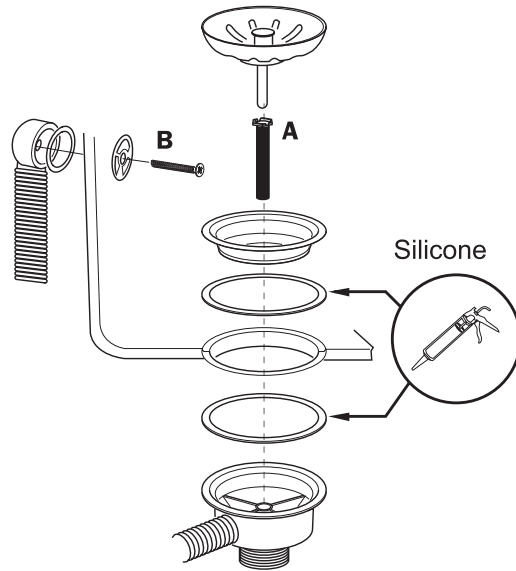

Care & Maintenance

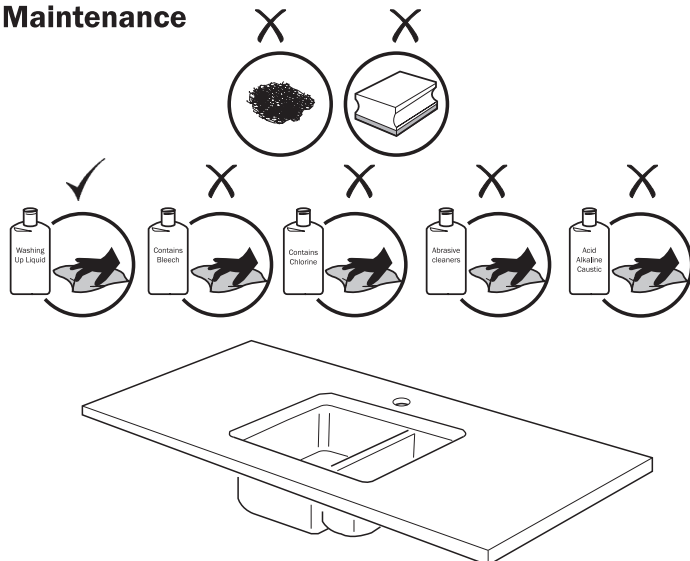

Template & Cutting

Follow these instructions to fit this sink to solid timber and chipboard (inset only) worktops. For other types of worktops please refer to the supplier's instructions and use the appropriate fittings.

- 1 Use the template supplied to make a jig, making allowances for copying ring & cutter. All dimensions +/- 1mm.

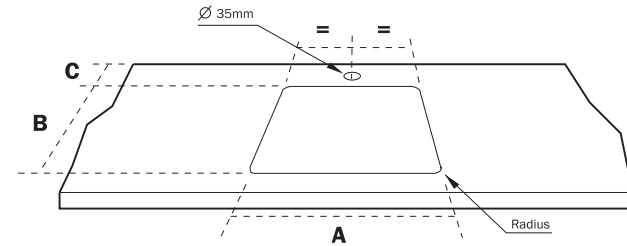

1.0 Bowl Inset	A.545mm	B.440mm	C.110mm(MAX.)
1.0 Bowl Undermount	A.470mm	B.365mm	C.120mm(MAX.)
1.5 Bowl Inset	A.535mm	B.440mm	C.110mm(MAX.)
1.5 Bowl Undermount	A.460mm	B.365mm	C.120mm(MAX.)

- 2 Clamp the jig to the worktop then router the sink cut out. For undermount sinks finish the cut out with a profile if required.

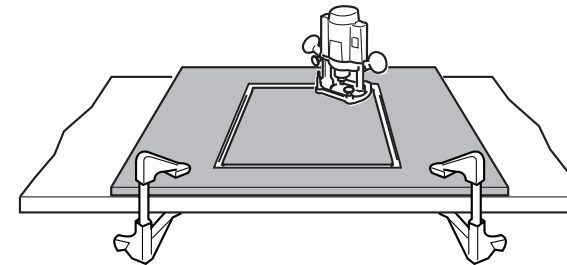

- 3 Clean around the cut-out removing any dust then seal around the cut-out using a waterproof sealant.

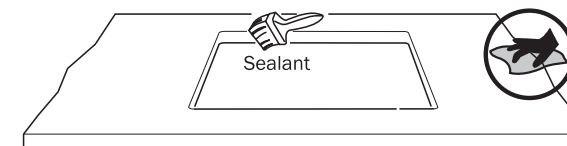

LAMONA
 Exclusive to Howdens Joinery Co.



Inset Sink Installation

- 1 The worktop may require notching on the underside for the overflow.

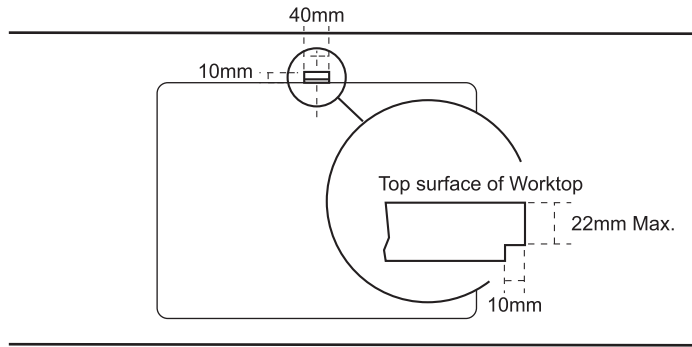

- 2 Fit sink and centralise.

Top of worktop shown

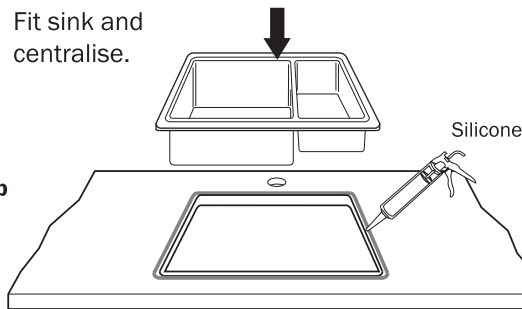

Note: Ensure both surfaces are clean and free from dust and grease before applying silicone.

Use a silicone recommended for use on sanitary ware.

- 3 Wipe away excess silicone.
Note: Leave for 24hrs before use to allow the silicone to cure.

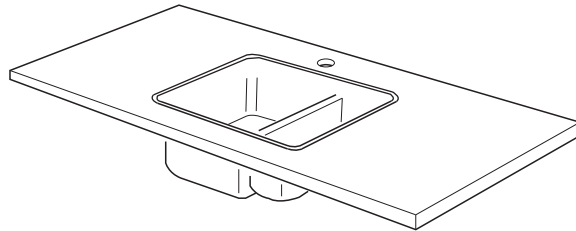

Note: Worktop should be treated in accordance with the manufacturers instructions

Undermount Sink Installation

- 1 Fit sink and centralise.

Underside of worktop shown

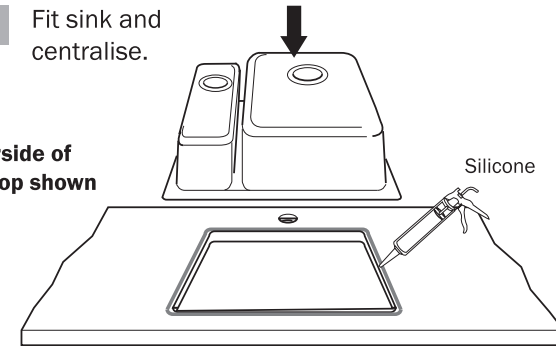

Note: Ensure both surfaces are clean and free from dust and grease before applying silicone.

Use a silicone recommended for use on sanitary ware.

- 2 Secure sink with 8 clips and screws.

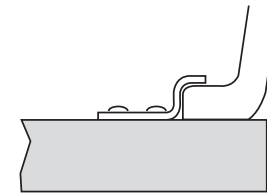

Recommended clip positions

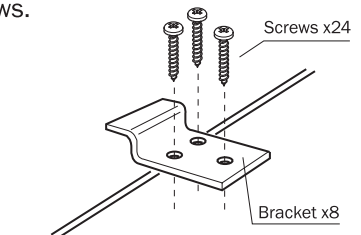
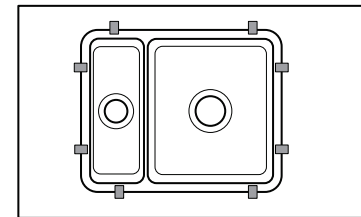

- 3 Wipe away excess silicone.
Note: Leave for 24hrs before use to allow the silicone to cure.

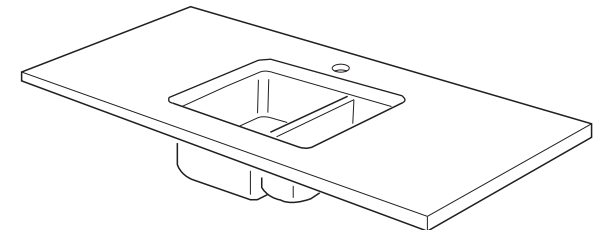

Note: Worktop should be treated in accordance with the manufacturers instructions