

Broadstone Sink

Installation & Care Information

SNK6980

Important Notes:

Ensure packaging is disposed of in a safe environmentally friendly way

For use with 600mm sink base cabinets

Door configuration - 553mm with 45mm Fascia

Note: Fascia will require cutting down depending on the worktop thickness

Overall product size: 630 x 494 x 184mm - Corner radius 15mm

Sink is suitable for open front/inset fixing application



Scan the QR code with your smart device to access a digital copy of the kitchen installation manual

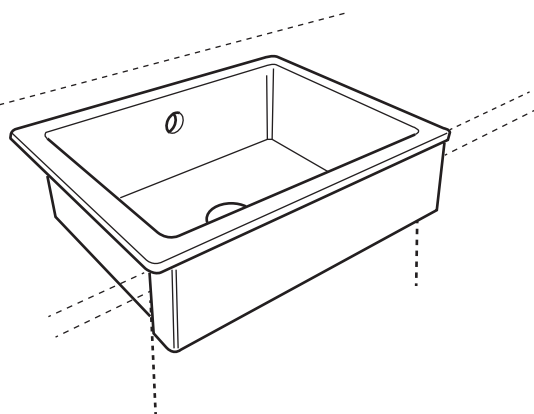
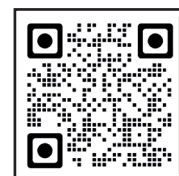

Installation Overview

1 Carefully remove cabinet rail.

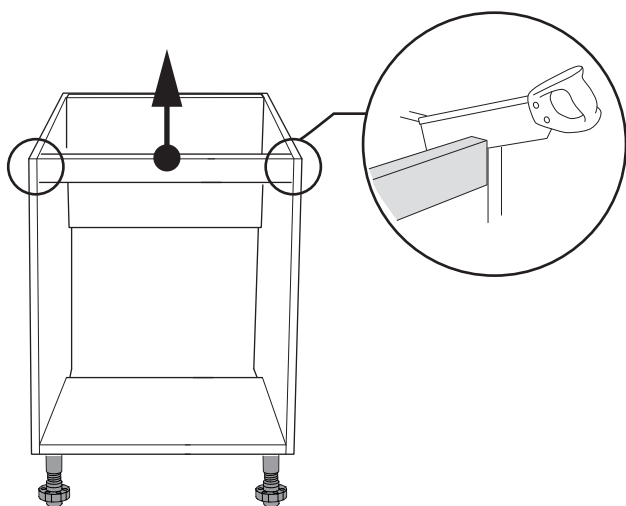

2 Re-fit cabinet rail so it sits below the sink once fitted*. **Note:** This will depend on worktop thickness.

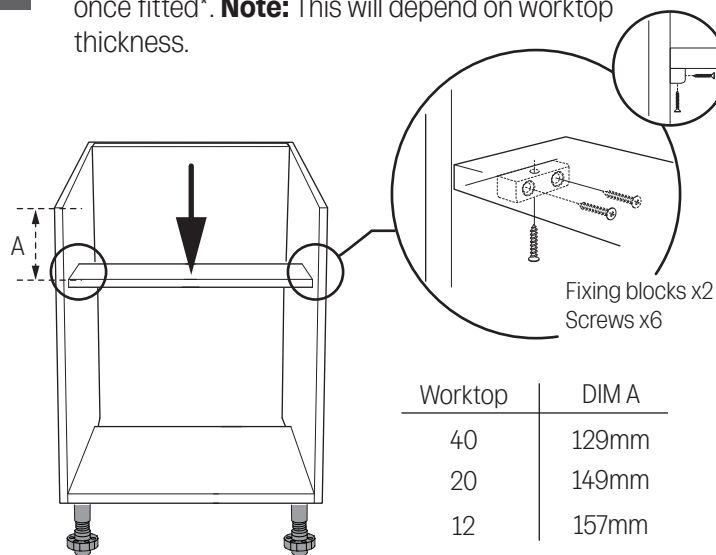

Worktop	DIM A
40	129mm
20	149mm
12	157mm

*re-fitting rail is for cabinet rigidity only and not for the sink to rest on

3 Cut the worktop for the sink aperture.

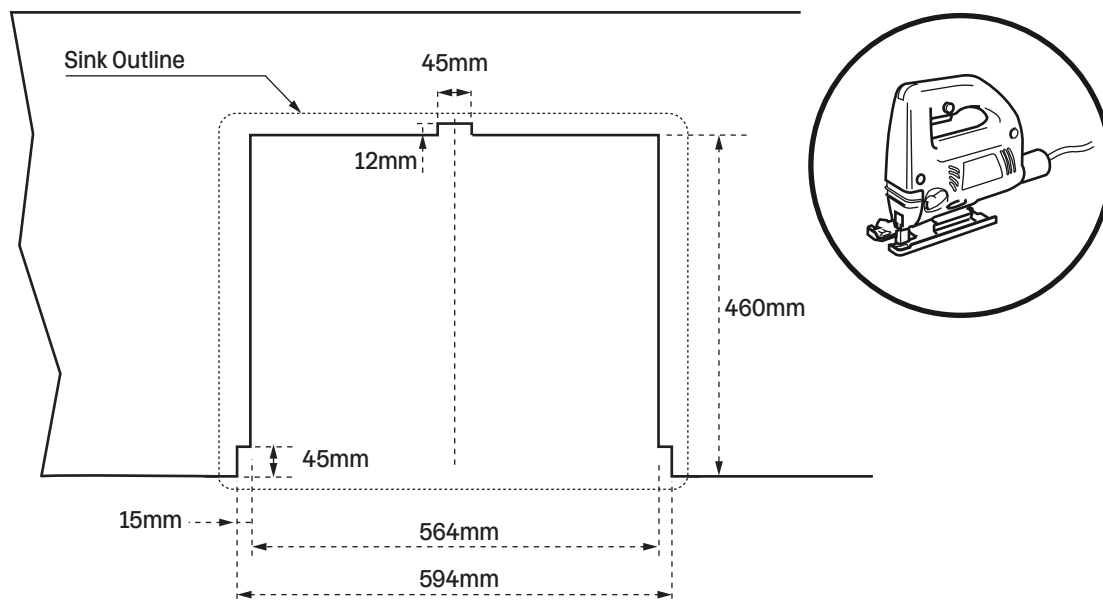

4

Fit the worktop to the cabinet, then secure the sink using silicone.

Note: Secure waste pipes before fitting sink.

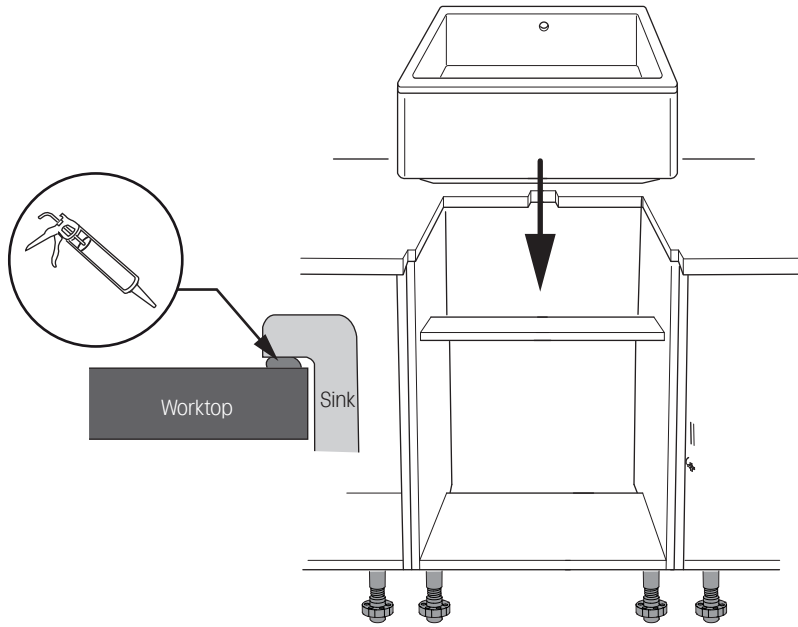

5

Fit the door (553mm) to the cabinet.

Above the door a 45mm fascia rail will be required (40mm worktop application). Note: Fascia will require cutting down for thinner worktop applications, as the sink will sit lower in the cabinet.

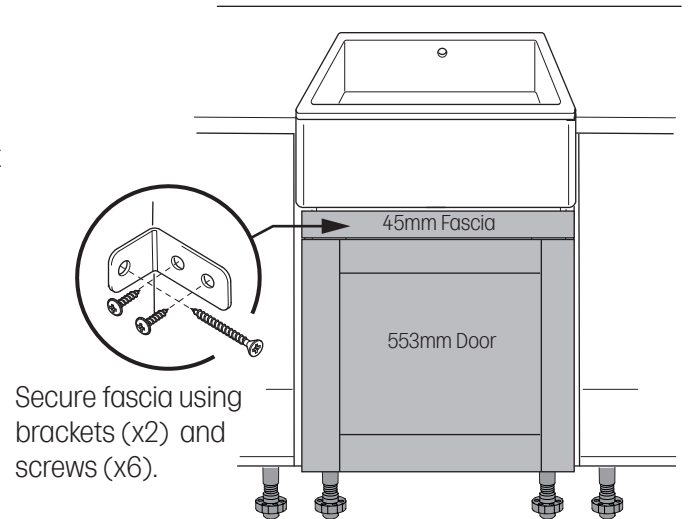

Care & Maintenance

Oil, grease and fingerprints

These are generally removed with washing up liquid and hot water but a solvent may be required (eg. White spirit or Methylated spirits). Care must be taken to use the proper safety precautions if using solvents.

Tea stains or vegetable juices

Likely to be stains that are clinging to mineral deposits, such as lime-scale, lying on the surface of the sink. See reference to mineral deposits below.

Mineral deposits and scaling

Generally caused by a build up of lime-scale, remove by soaking in a solution of vinegar (three parts hot water to one part vinegar), then scrubbing the deposit away.

Important: Always finish cleaning by rinsing your sink thoroughly with clean water to remove any residue, then dry it with a soft cloth to prevent lime-scale building up.

Care points

