

Cabinet Door Fitting

When fitting a FH Door (716mm) to the housing cabinet an alternative top hinge position may need to be drilled (see right).

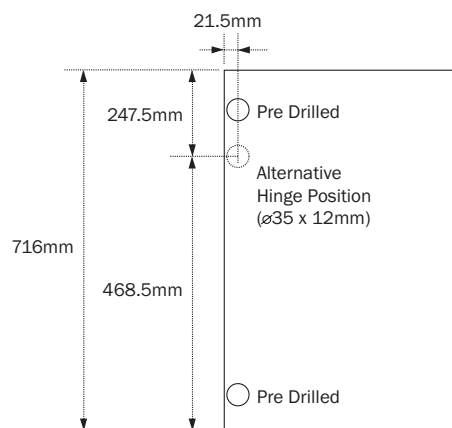

RH Hung Door Shown

Care & Maintenance

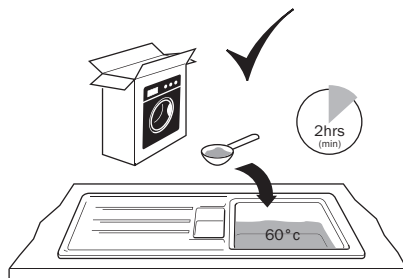
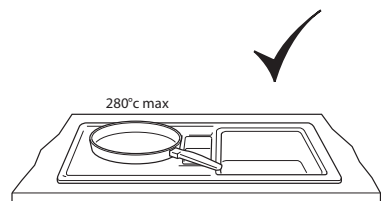
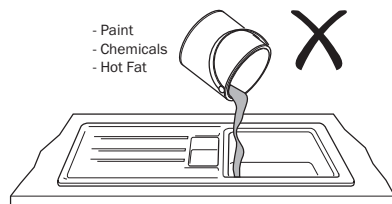
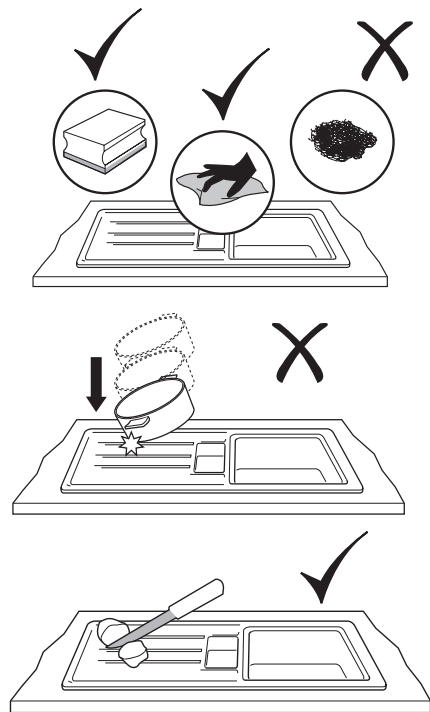

XL Single Bowl Sink (Black)
 XL Single Bowl Sink (Grey)
 Single Bowl Sink (Cream)
 XL Single Bowl Sink (White)
 1.5 Bowl Sink (Black)
 1.5 Bowl Sink (Grey)
 1.5 Bowl Sink (Cream)
 1.5 Bowl Sink (White)

SNK2114
 SNK2142
 SNK2106
 SNK2110
 SNK2153
 SNK2152
 SNK2156
 SNK2160

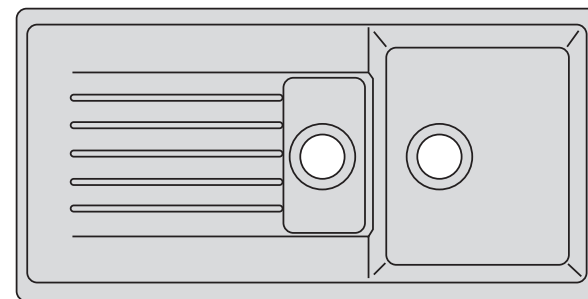
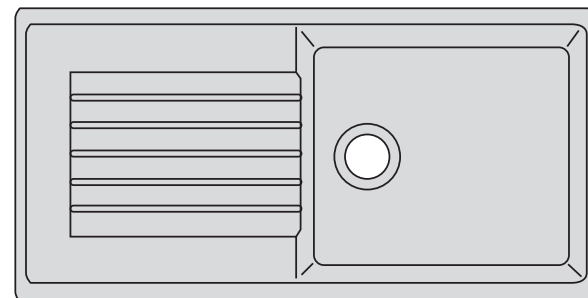
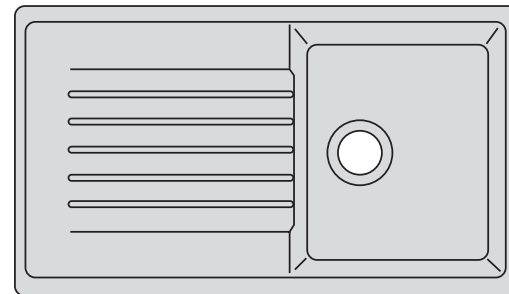

LAMONA
 Exclusive to Howdens Joinery Co.

Installation

Measure and Cut

1

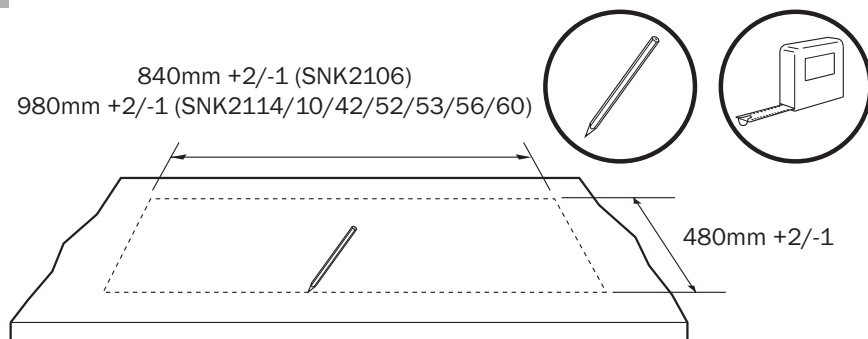

2

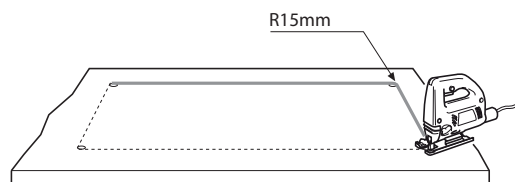

3

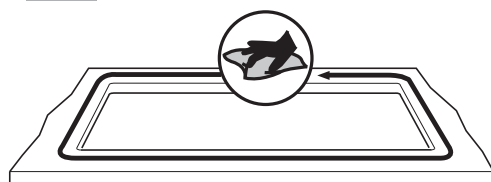

Fitting

4

RH Drainer fitting shown

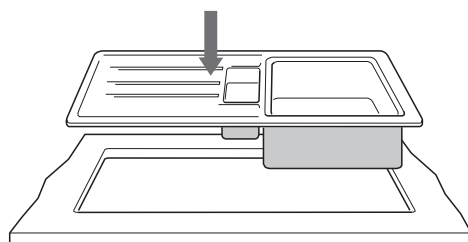

5

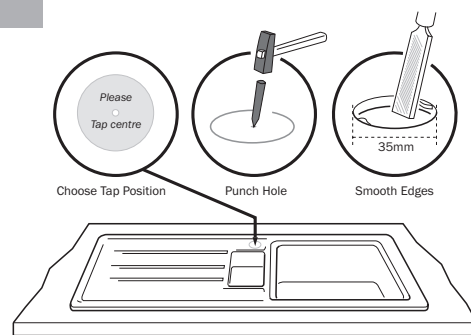

6

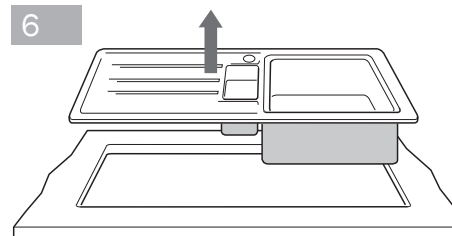

7

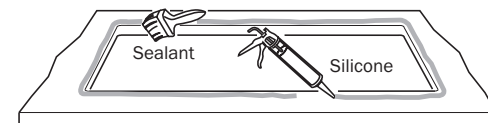

8

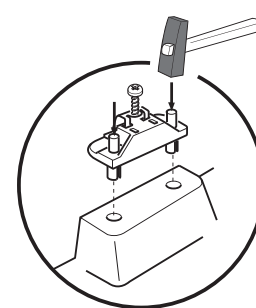

Clip locations and order of tightening once sink in position

Note: SNK2106 - Points 1, 2 & 7

SNK2114/10/42/52/53/56/60 - Points 1 to 7

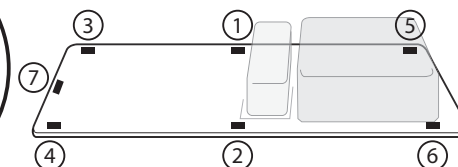

9

RH Drainer fitting shown

