

# Worktop Support Bars

## Application Information

22mm Laminate Worktops

Metal support bars should be used over unsupported spans of 22mm laminate worktops. Follow the diagrams below for where support bars are required.

**Notes:** Cut-outs for a sink or hob in the 22mm worktops must be supported by the cabinet front rail and/or support bar.

### Hi Line Base Cabinets

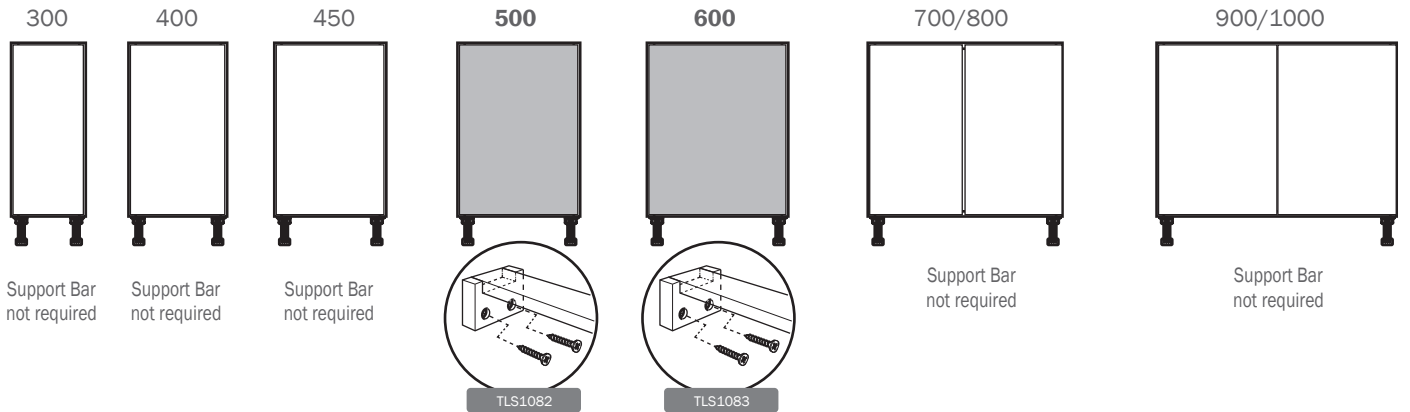

With Cut-out above

*NOTE: The 700, 800, 900 & 1000 units do not need a support bar if the front rail & centre upright of the cabinet remains in place. If this has been removed the use of a support bar (TLS1081/4/5) will be required*

### Drawer Line Base Cabinets

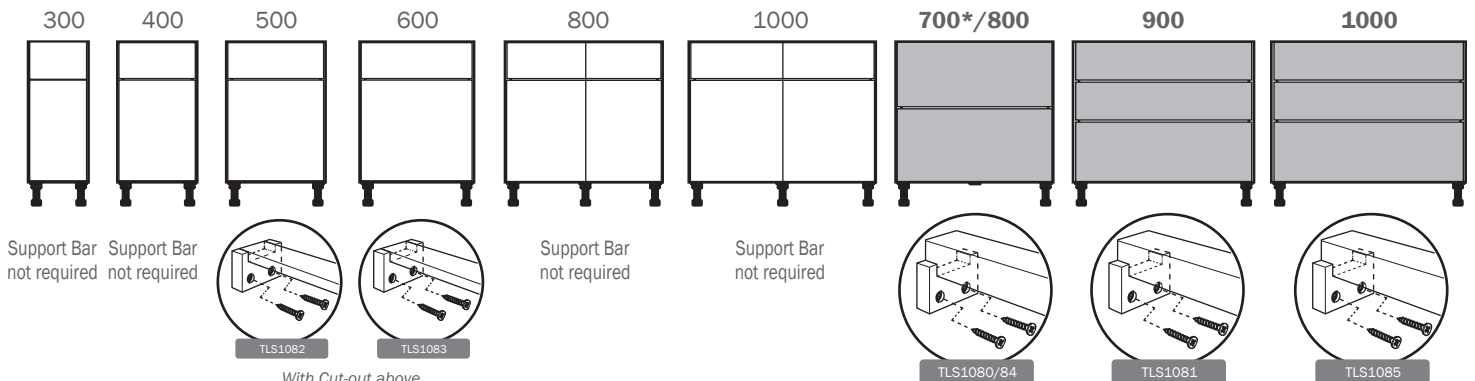

With Cut-out above

*\*The support bar TLS1084 should be cut down for use with the 700mm cabinet*

*Note: For use on large drawer units where there is no centre upright or with a cut-out above*

### Appliance

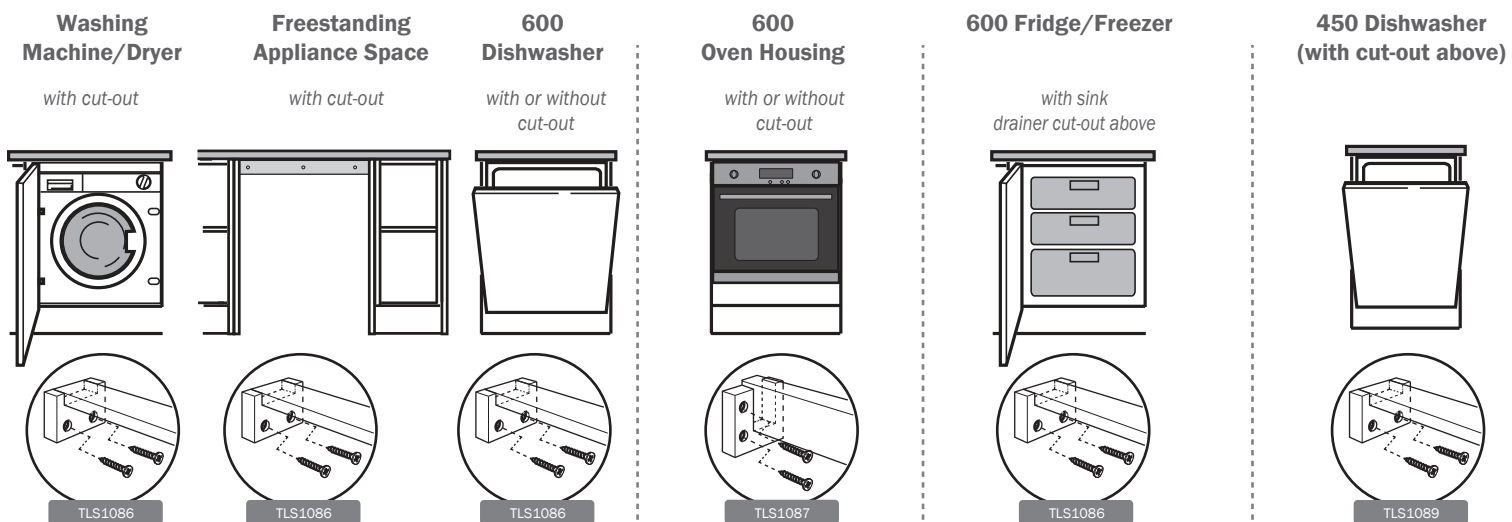

*(+18mm MFC Piece fitted to the underside of the worktop for appliance to secure into)*

# Planning Recommendations

## 22mm Laminate Worktops

When two appliances are to be positioned next to each other, decor end panels and support rails should be used for additional support. Where possible a unit should be positioned between the appliances for increased support of the worktop.

- The maximum unsupported overhang span of the worktop must never exceed 300mm
- The maximum unsupported span of the worktop must never exceed 450mm
- Cut-outs for hobs and sinks should never be closer than 60mm from the end edges of the worktop

