

# Compact Laminate Worktops

## Installation Guidelines & Care Information

CLW001

**Compact laminate worktops are easy to work with and do not require any specialist equipment for installation. Follow the section step by step guide in this leaflet for the key areas of installation.**



### QR code

Some areas of installation now have a QR code referenced against them. Scan the QR code using your smart device to access a short animation/video giving an overview of the assembly of that particular stage of installation. In addition to this, the QR code for the kitchen installation manual is shown to help with other aspects of installation.

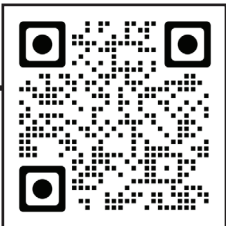

Kitchen Installation Manual

## Tools & fittings required for installation

\*IMPORTANT: Suitable extraction must be used when cutting.

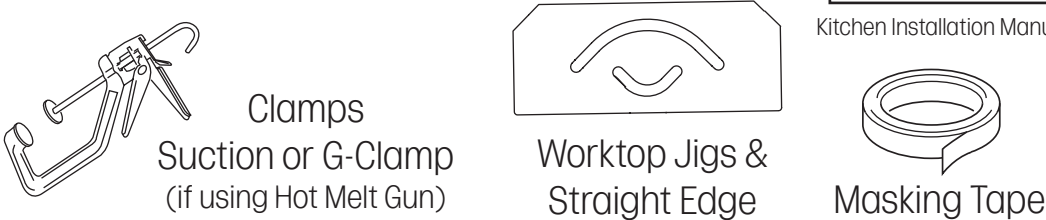
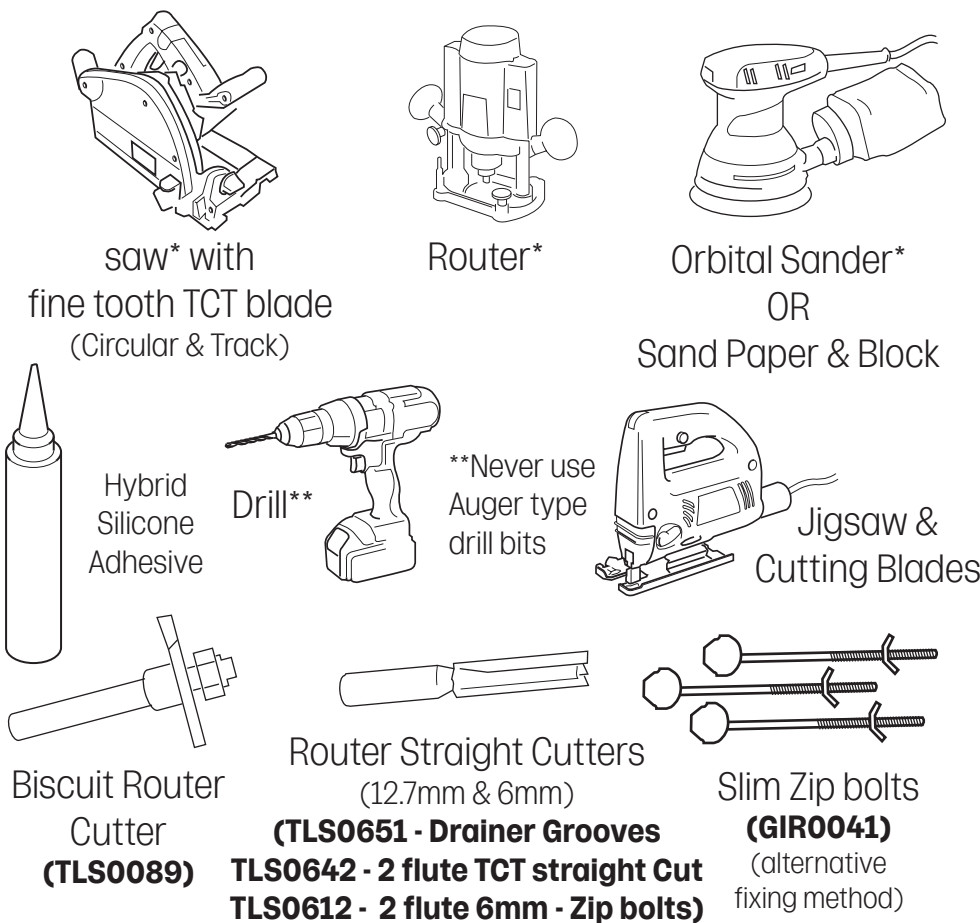

### Compact laminate fitting pack - **WHT0001/2/3/4/5/6**

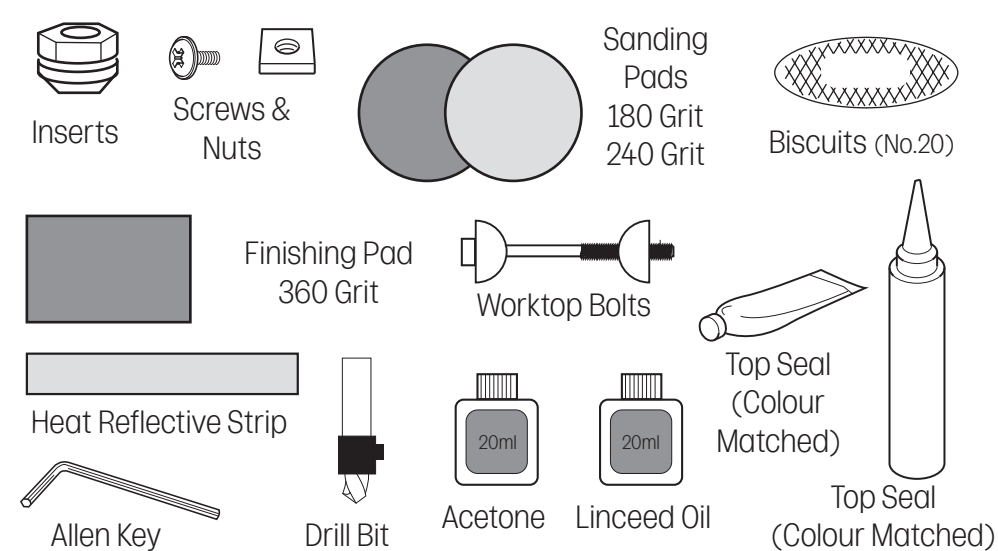

## Before you begin



We recommend that worktops are acclimatised to the room temperature before fitting. Where storage is required, ensure that your worktops are stored flat, face up and supported using bearers. Cardboard should be used between tops and an additional chipboard or MDF top board.

If you have more than one worktop that needs storing and wish to stack them, please ensure that the surfaces are clean and clear from any debris so no damage occurs. We suggest using several layers of cardboard between boards.

This is a heavy product and we recommend a two person lift. Worktops should be carried vertically along the length to avoid any damage.

Always use protective eyewear and dust mask (FFP3) when cutting worktops. Ear protection when using power tools is also recommended.

A 3mm expansion gap around the worktop should be maintained when against a wall.

Use the heat reflective strip under the worktop front edge in dishwasher applications.

Do not store or install the compact laminate in rooms where wet trades have recently been carried out.



**The surface of the worktop must never be sanded. Sanding and finishing is only applicable for the visible edges of the worktop.**

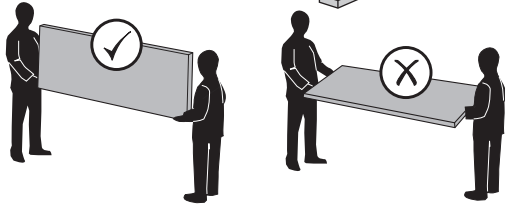
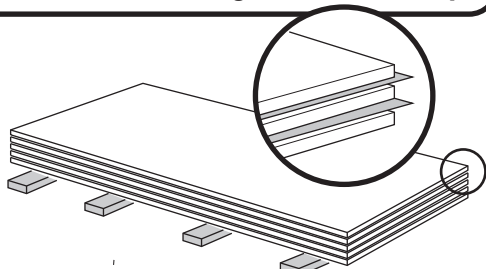

## Installation tips

Unsupported sections of worktop must not exceed 600mm.

Overhangs should not be more than 300mm.

**Note:** Worktop cut-outs should be a minimum of 300mm in from the overhung edge.

In an island application a max 300mm overhang over a 2400mm span should be adhered to.

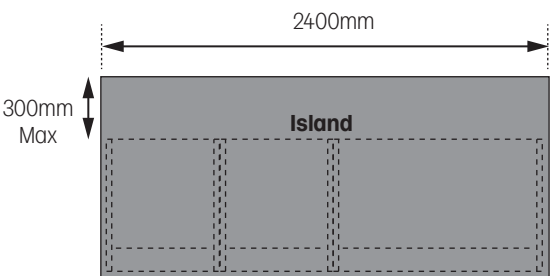
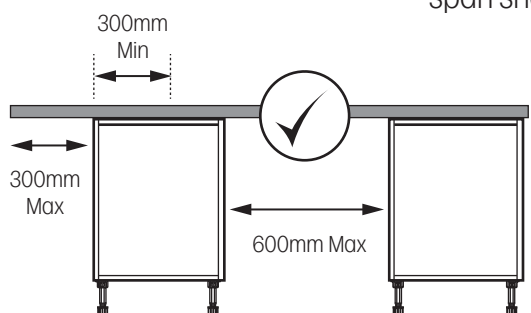

Support bars required if over 600mm

No joins in the worktops should be over unsupported spans

Always router the adjoining edge of a worktop to achieve a clean join.

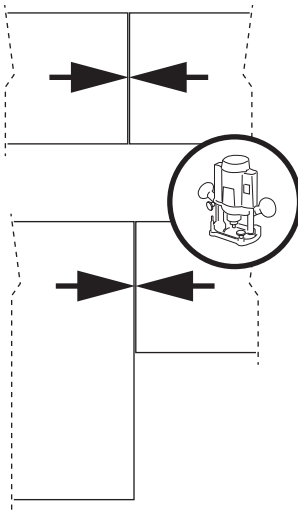

Make sure worktops are cut with sharp blades.



When drilling compact laminate, ensure a solid base is used underneath.

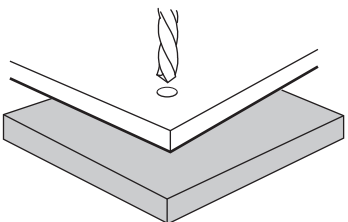

# Cutting to size



## Step 1.

Mask, measure and mark for cutting.  
**IMPORTANT:** Check measurements.

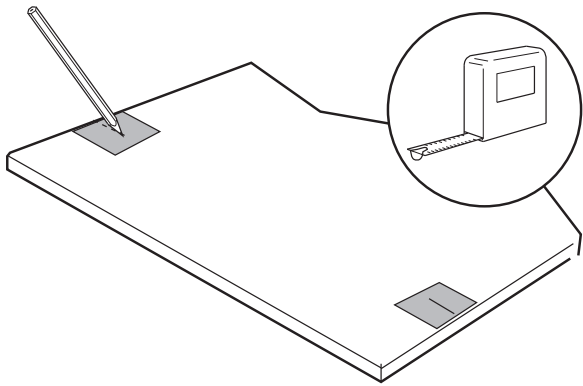

## Step 2.

Cut with track or circular saw.  
We recommend a 3 pass cut.

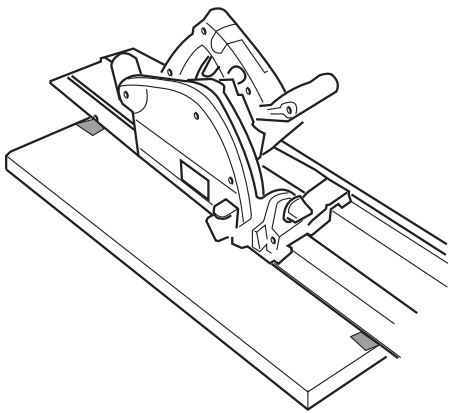

## Step 3.

Finish edge with router (final skim).

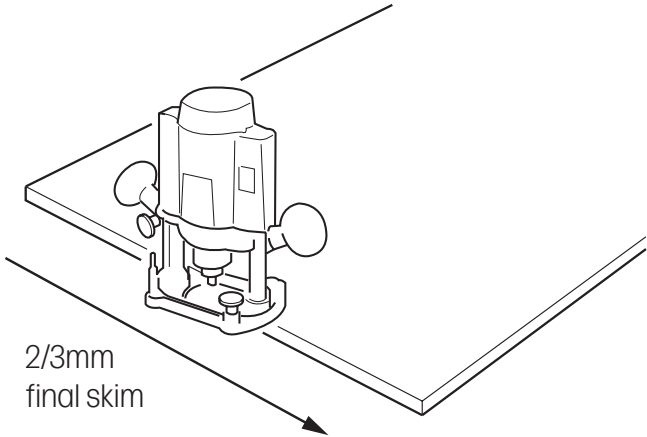

Dry fit the worktop once all pieces have been prepared, to ensure no chips or gaps can be seen between joints

# Cut - Outs



## Step 1.

Use measurements or template supplied with your product for marking onto the worktop.  
**Note:** The distance between the cut-out and adjacent worktop joint must be a minimum of 150mm and 40mm minimum from the front of the worktop.

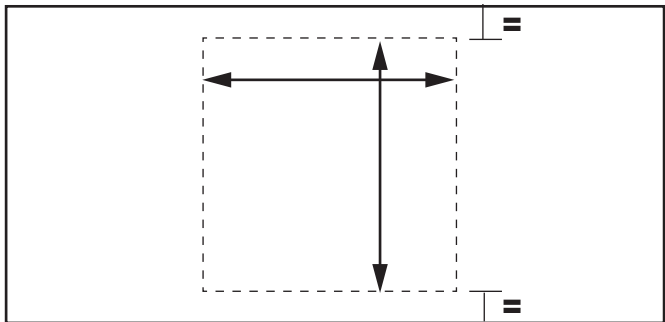

## Step 2.

Cut option 1 - cut edge not visible.  
(for hob or inset sink).  
Drill corners of the template then use circular saw & track to complete straight cuts.  
2/3 pass cut recommended.  
Use Jigsaw around corners.

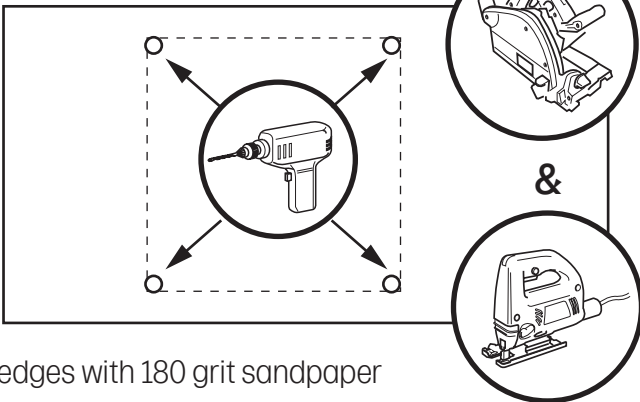

Cut option 2 - cut edge visible.  
(for undermount sink).  
Use a router & jig to complete the cut.  
A 2/3 pass cut recommended.  
SEE DRILLING FOR INSERTS SECTION.

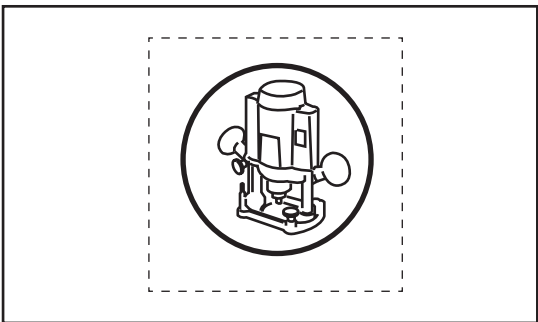

Note: Remove any splintered edges with 180 grit sandpaper



Once the cut-out has been made, follow the finishing information for visible cut edges.  
Instructions supplied with your hob and sink cut-outs should be followed.

# Joining

**Important:** Use masking tape to protect the top edge of the worktop where joining.

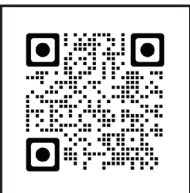

**A butt joint or masons mitre joint can be used to join the worktops**  
For a masons mitre joint we recommend a 10mm inset using a jig - Follow the instructions supplied with the jig for positioning and cutting information.

## Step 1.

Use a router to apply biscuit cut slots in the edges of the worktops. These should be positioned 4mm from the top edge and evenly spaced.

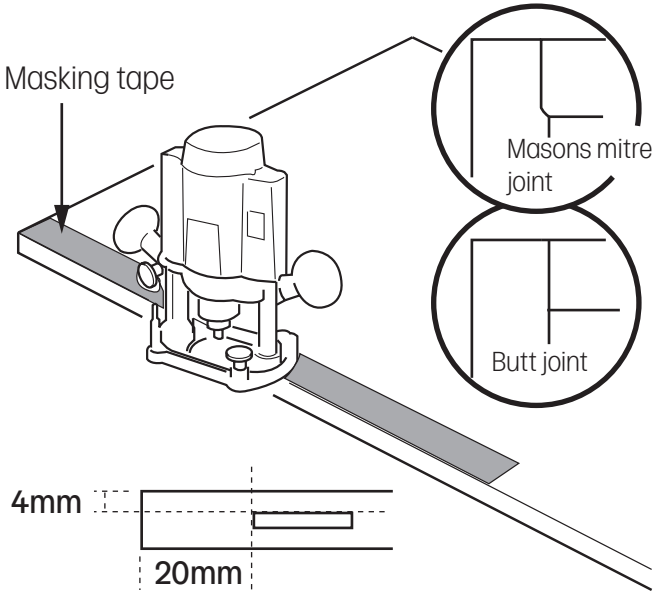

## Step 2.

**Prepare all tops (including any cut-outs).**  
Dry fit to ensure tops align.  
Apply top seal adhesive to the biscuit grooves and along the edge. Fit biscuits in position and join worktops together.

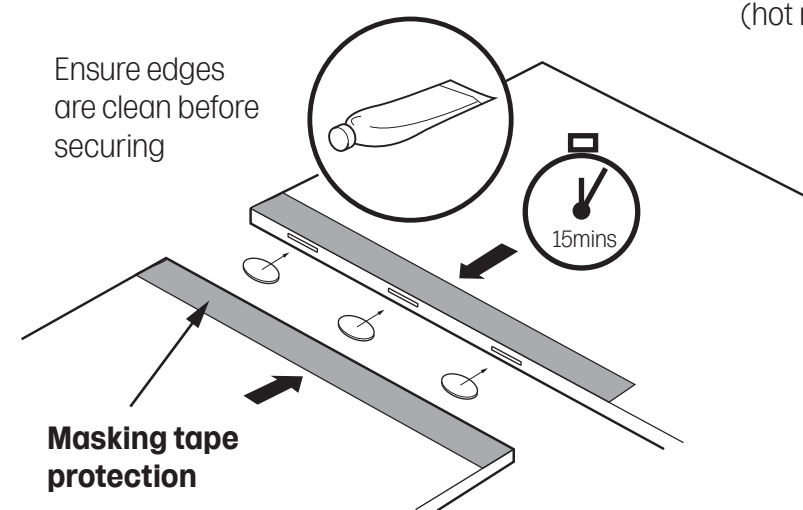

Quick application of the adhesive is essential as it will set within 15mins. Follow instructions on adhesive.

## Step 3.

Fit worktops together and clamp ensuring they're aligned. Remove excess adhesive immediately. Worktop bolts (supplied) can also be used to clamp tops together from the underside.  
**Note:** Suction clamps or wooden blocks (hot melt glued to the top & clamped) can be used.

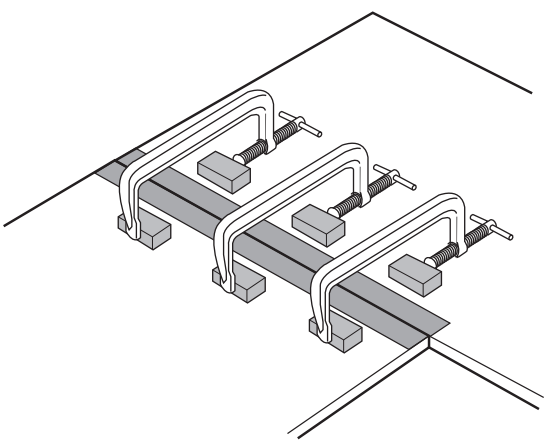

**Once adhesive has set, remove clamps and masking tape then wipe joint.**



**IMPORTANT:** Remove any excess adhesive from the joint immediately.  
Go across the joint with a ruler to ensure a smooth joint. In a run, any joints should be positioned over end panels.

# Joining (alternative fixing method)

Secure a standard worktop jig to the worktop and router the ends using a 30mm guide bush & a 6mm Router cutter (depth of 8mm)  
Use the ultra slim zip bolts (**GIR0041**), or the bolts supplied in the fittings pack, to secure the worktops together .  
**IMPORTANT:** If using the GIR0041 zip bolts, pack the jig 30mm from the front of the worktop using a spacer rail (RKC0072). Secure using clamps.  
We recommend x3 bolts and x2 biscuits are used per join.  
**Note:** Apply buiscit cut slots as per step 1 of joining section.  
Secure the worktop together using the torx driver bit to tighten.

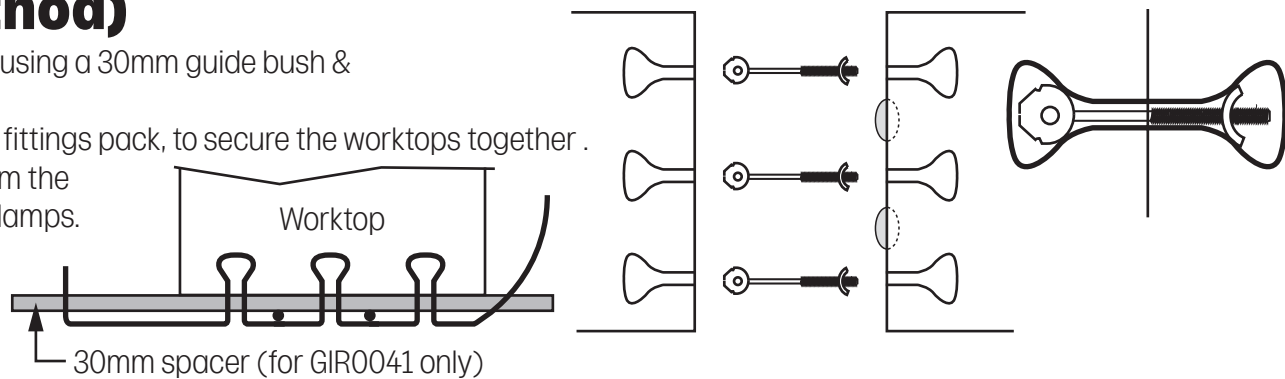

# Drainer grooves



**Always process drainer grooves after a radius profile has been applied to the inner edge of the sink/hob cut-out.**

Secure a drainer groove jig (**TLS0669**) to the worktop using clamps.  
Use a router to machine the grooves.

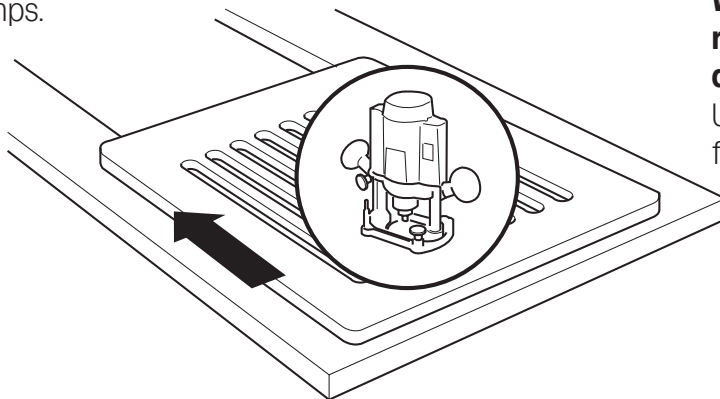
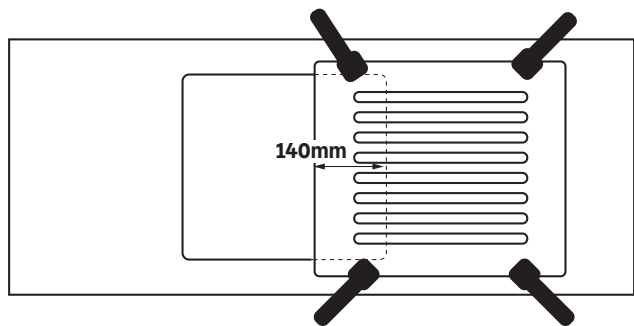

**Note: Smooth use of the router will minimise hand sanding when finishing. We recommend 2/3 passes keeping the router moving at a moderate pace to avoid burning.**  
Use a drainer groove sanding block for finishing the grooves (see finishing).



**Note:** Move jig line to 140mm to achieve a 300mm drainer groove. Longer drainer grooves can be achieved by modifying the jig.



**Note: Drainer grooves must be finished. Follow the finishing instructions below. We recommend 1 coat of linseed oil (supplied) in the grooves.**

# Finishing Edges

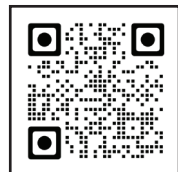

**NOTE: ALL VISIBLE EDGES REQUIRE FINISHING**

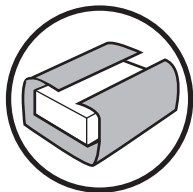

A sanding block can be used to achieve a similar finish using the same grit sand papers. This process will take longer.  
**Note:** This method will be required for finishing drainer grooves.



**The surface of the worktop must never be sanded. Sanding and finishing is only applicable for the visible edges of the worktop.**

Use a sander or sanding block to finish the edge of the laminate. Use the sanding pads in order shown below to achieve a final finished edge.  
Always wipe the surface edge clean with a damp cloth between each pass to remove any surface contamination.

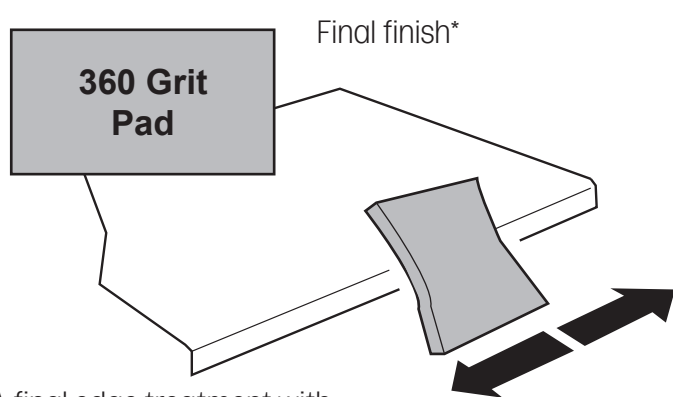
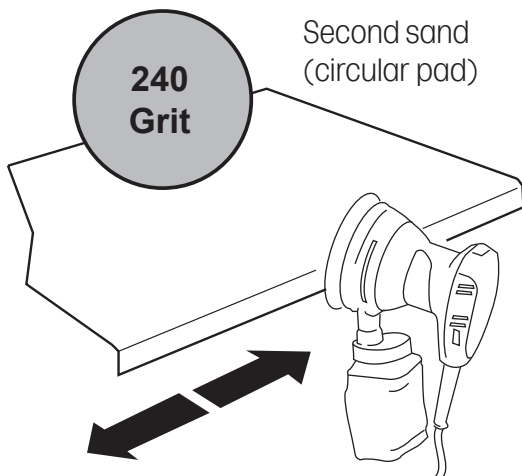
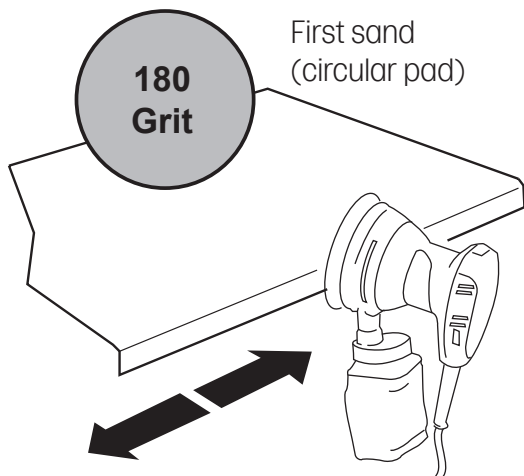

\*A final edge treatment with linseed oil (supplied) or wax (not supplied) will further enhance the worktop

**Note:** 'Ease' the edge of the worktop using the sanding pad to remove the sharpness of the edge as required.

# Securing worktops

Solid laminate worktops should be fixed to base cabinets using sealant on all top edges of the base cabinet which are in contact with the worktop. Screws are not suitable for securing these surfaces in place due to their thickness.  
**Note:** Apply the sealant 10mm away from the front edge of the cabinet.

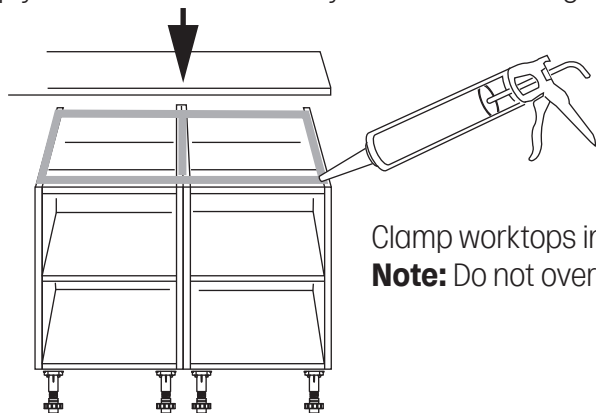

Clamp worktops in position.  
**Note:** Do not over-tighten clamps.

# Drilling for inserts

Drill for inserts into the underside of the top, ensuring a minimum of 3mm of the material remains (hole depth of 9mm).  
Use drill bit and inserts supplied in the fittings pack.  
**TAKE CARE NOT TO DRILL THROUGH WORKTOP.**



Use the inserts for undermount sink installation.  
**Note:** Belfast and ceramic sinks will require additional support. A cradle should also be used to support the sink. See the kitchen installation manual for more details.

# Edge Profiling

The illustrations below show examples of profiles that can be achieved using router cutter **TLS0671**. Other profiles can be achieved using different cutters.  
**Note:** We recommend a trial piece is used to ensure the style/cut is correct.



Top chamfer 45°



Top/bottom 2mm

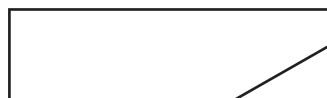

Underside chamfer



# Compact Laminate Care & Maintenance



**Please leave this information with the end consumer to ensure the worktop is cared for correctly**

Compact laminate worktops require only a wipe down with a mild detergent and water. Rinse with warm water and gently buff the surface. A melamine cleaning sponge can also be used.

**Note:** Using linseed oil is a great form of protection for the worktop edge and drainer grooves and only need be applied at installation. This oil is to seal the core and minimise staining risk.



**The surface of the worktop must never be sanded.  
Sanding and finishing is only applicable for the visible edges of the worktop.**

## Staining

- Compact laminate worktops have a solid surface, resistant to stains, mould, mildew and bacterial growth.
- Wipe spills immediately using a damp cloth, especially liquids such as tea, coffee, blackcurrent and red wine.
- Do not leave standing water on surface.
- Should any staining occur, use a mild detergent and water to remove.
- Stubborn stains can be removed using a mix of domestic bleach and warm water.

**Note:** Ensure gloves are worn when using domestic cleaners.

- Light core (white/Grey) compact laminate drainer grooves are prone to showing strong household stains.

- Linseed oil should be applied after installation (1 coat) to seal the core.
- Products such as tea, coffee and red wine should be wiped away immediately.
- Should staining occur in the grooves, follow cleaning advice above.

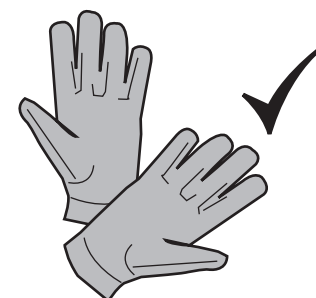

**IMPORTANT:** Acidic or abrasive cleaners **MUST NOT** be used.  
Avoid excessive scrubbing.

- If staining occurs in the drainer grooves, use a mild detergent (non-abrasive cream cleaner) and water to remove. For more stubborn marks, a 360 grit pad can be used. Standing water should be wiped off within 6 hours from drainer grooves to prevent water marks.
- Ensure water is not left to sit on the surface of the worktop, underneath items such as drainer boards, chopping boards, pans or worktop appliances.

## Scuffs and scratches

- Darker colours are more susceptible to excessive marking and general wear and tear than lighter colours.
- Cutting should never be done directly onto the worktop surface.

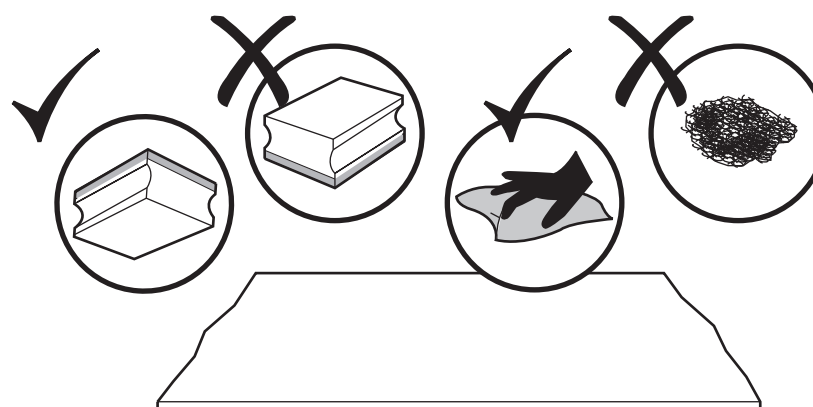
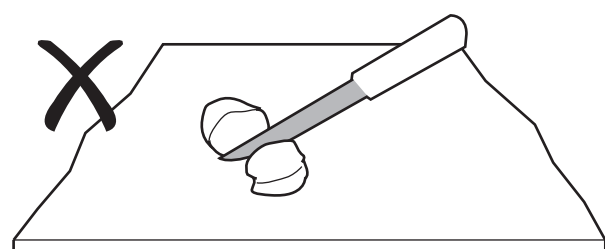

## Resistant to heat

- Never place hot items directly onto the worktop. We recommend the use of trivets or heat pads.

