

26 Worktops

cutting and fitting

IMPORTANT NOTE - Refer to the below information only for the installation of laminate worktops. If installing solid timber or solid surface worktops please refer to the separate cutting and installation instructions provided.



NOTE: Before fitting the worktop, drill through the part drilled holes in the front rail of the carcasses with a 5mm drill bit.

Using a fine toothed saw, measure and cut the worktop to required size. If you are creating a mitre joint ensure that the male part of the worktop is correctly sized to accommodate the inset into the female part. Before cutting the worktop, stick a length of masking tape over the line and score the surface – this method helps prevent chipping. When a sawn edge is visible it may require planing smooth before applying pre-glued edge banding.

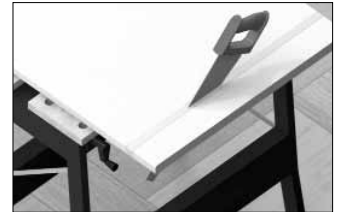
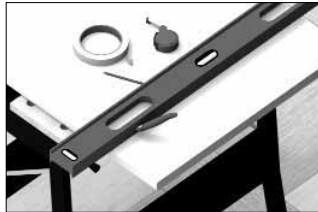

Right-hand female joint shown

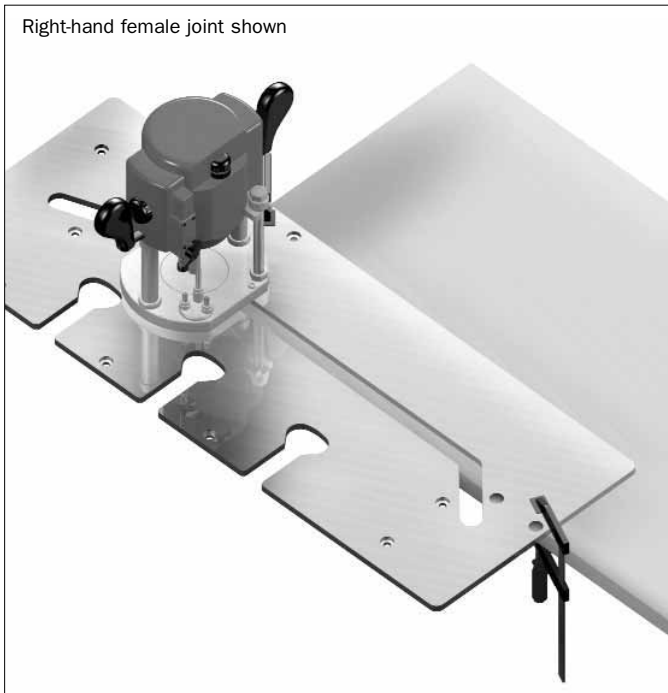

Right-hand male joint shown



If the corners are being joined at 90° with a mitre joint, identify which ends of the worktops are to be 'male' and 'female'. Following the instructions provided with your worktop jig, use a router to create the necessary joints and joining bolt pockets. Illustrations show the creation of a right hand corner joint, reverse worktop to create left hand corner joint.

For joining at angles other than 90° please refer to the instructions provided with your worktop jig.

Bolt slots, right-hand female shown

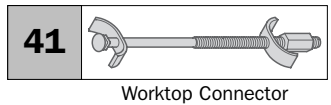
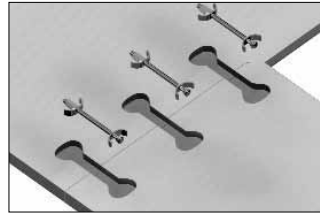
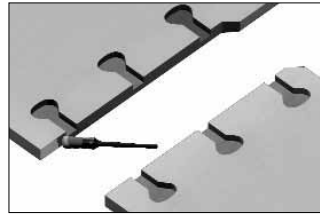
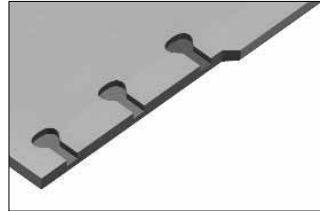
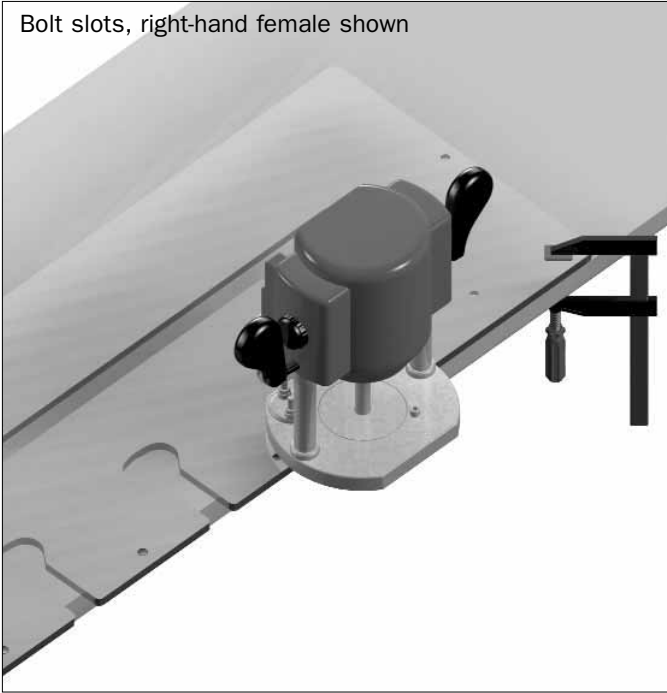

Once all cutting is complete, bring worktops into position and join together using worktop connector bolts, tightening as required. Once the worktop is in correct position (41), secure it to the cabinets by using 40mm autopilot screws (3) through the pre-drilled holes in the front rails. Then use csk screws (33) to secure the worktop to the rear of the carcass through the previously fitted worktop fixing brackets.

Finish any exposed cut edges by applying pre-glued worktop edging using an iron, with a piece of paper between to protect the edging. Apply worktop jointing compound to the mitre joint to create a virtually invisible joint.

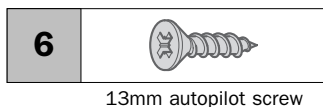
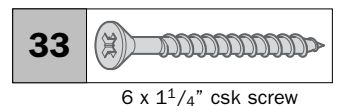
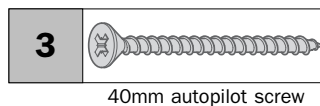
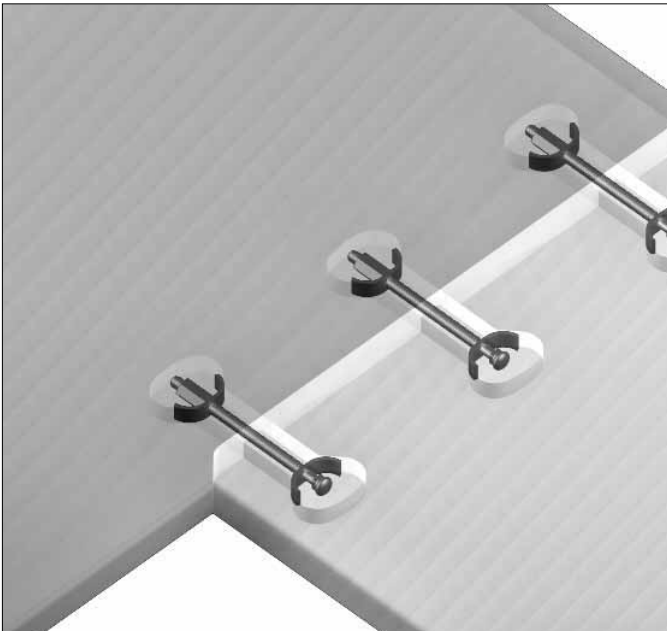

If corners are being joined at 90° using filler strips, decide upon the location of the filler, cut to size and attach using 13mm autopilot screws (6). With filler connected and worktop in place, secure the worktops onto the cabinets as described in the point above.

NOTE: On certain decor cabinets with top shelves, 2 40mm autopilot screws (3) are supplied to fix the cabinet to the worktop. Drill through the decor cabinet only and bradawl the worktop before fixing securely with the 2 screws.

27 Worktops

fitting backboard



Cut backboard to required lengths and mitre joints where appropriate. Apply a suitable adhesive to the rear and underside of each cut section of backboard, following adhesive manufacturers instructions, fit and allow the adhesive to dry.

Use silicone sealant or the appropriate jointing compound for your worktop to fill and seal all joints. Use appropriate sealing strip or edging strip to finish any exposed edges.

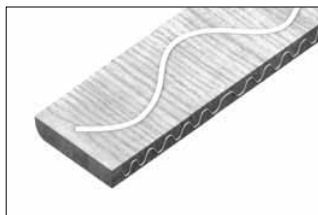
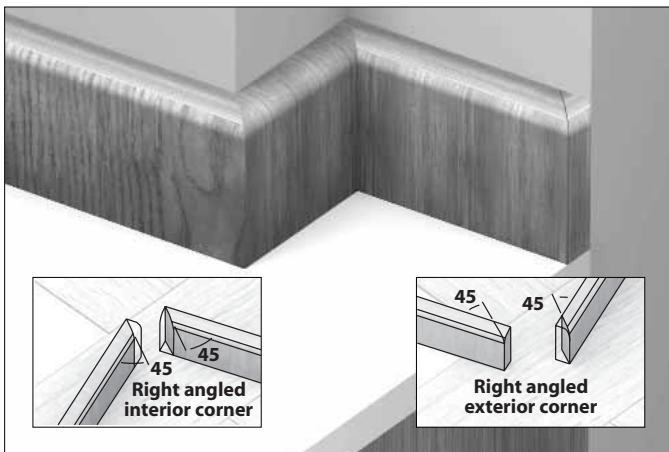
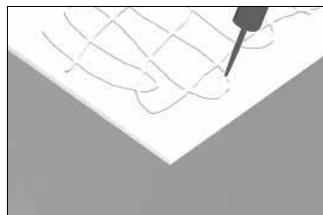

Cut upstands to required length and mitre joints where appropriate. Apply suitable adhesive to the rear and underside of each cut section of upstand, follow adhesive manufacturers' instructions, fit and allow to dry.

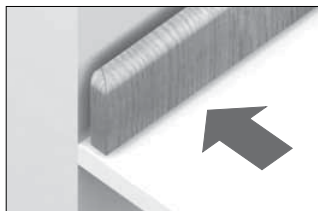

28 Worktops

fitting sink unit



We recommend that your sink is positioned in the worktop before the worktop is secured. Fit the sink to the worktop following the manufacturers instructions.

Where a hole has been cut for an inset sink or hob. Sand raw edges down and seal with a waterproof varnish or PVA.

