

At 20 minutes



After 30 minutes



The legal validity of this report can only be claimed on presentation of the complete report.

After 36 minutes



After 40 minutes



The legal validity of this report can only be claimed on presentation of the complete report.

Description of construction (refers to Figures 1 to 4 of the appendix)

Leaf - doorset A

		Species/type	Dimensions (mm)	Density (kg/m ³)	Moisture (% w/w)	Key to figures
Stiles and muntin*		Oak veneered particleboard** 2No layers 12mm exposed face, 30mm unexposed face	120 wide x 44 thick with a 24.2 wide x 10.5 deep rebate to accept the panel	600*	12	1
Rails*	Top	Oak veneered particleboard** 2No layers 12mm exposed face, 30mm unexposed face	117 wide x 44 thick with a 24.2 wide x 10.5 deep rebate to accept the panel	600*	12	2
	Middle	Oak veneered particleboard** 2No layers 12mm exposed face, 30mm unexposed face	160 wide x 44 thick with a 24.2 wide x 10.5 deep rebate to accept the panel	600*	12	3
	Bottom	Oak veneered particleboard** 2No layers 12mm exposed face, 30mm unexposed face	185 wide x 44 thick with a 24.2 wide x 10.5 deep rebate to accept the panel	600*	12	4
Panel*		Oak veneered particleboard**	30 thick reduced to 24 thick at fielded areas	600*	10	5
Panel beadings*		Oak	17.5 high x 18 wide	550*	-	6
Beading fixings		Headless steel pins	20 long located at 25mm from corners at 100mm centres	-	-	7
Adhesive*	Lipping	Durabond PA117	-	-	-	-
	Veneer	Durabond PA 1015(PB)	-	-	-	-
	Layered particle board	Urea formaldehyde glue	-	-	-	-
Lippings* - all edges		Oak	16 thick-vertical edges 10 thick-horizontal edges	550*	10	8
Joinery junctions		Timber dowel (see figure 1 for locations)	14Ø x 95 long	-	-	9

* Stated by client, not checked by laboratory

** Details held on file by CIFL

The legal validity of this report can only be claimed on presentation of the complete report.

Leaf - doorset B

		Species/type	Dimensions (mm)	Density (kg/m ³)	Moisture (% w/w)	Key to figures
Stiles*		Oak veneered particleboard** 2No layers 12mm exposed face, 30mm unexposed face	120 wide x 44 thick grooved to accept the core	600*	11.5	10
Rails*	Top	Oak veneered particleboard** 2No layers 12mm exposed face, 30mm unexposed face	117 wide x 44 thick grooved to accept the core	600*	10	11
	Bottom	Oak veneered particleboard** 2No layers 12mm exposed face, 30mm unexposed face	185 wide x 44 thick grooved to accept the core	600*	10	12
Core*		Comprised - 2No layers particle board** 12mm exposed face, 30mm unexposed face	5No 107 wide x 44 thick (see figure 1)	600*	10.5	13
Core inserts*		Oak	20 wide x 44 deep with 10 wide x 5 deep groove on each face	550*	-	14
Adhesive*	Lipping	Durabond PA117	-	-	-	-
	Veneer	Durabond PA1015(PB)	-	-	-	-
	Layered particle board	Urea formaldehyde glue	-	-	-	-
Lippings* - all edges		Oak	16 thick-vertical edges 10 thick-horizontal edges	550*	11	15
Joinery junctions		Timber dowel (see figure 1 for locations)	14Ø x 95 long	-	-	9

* Stated density, not checked by laboratory

** Details held on file by CIFL

The legal validity of this report can only be claimed on presentation of the complete report.

Door frame – both doorsets

	Species/type	Dimensions (mm)	Density (kg/m ³)	Moisture (% w/w)	Key to figures
Head & jambs	European redwood	32 thick x 70 deep	510**	10-11	16
Head to jamb jointing detail	Mortise and tenon – screwed	-	-	-	-
Stops – planted (pinned)	European redwood	12 deep x 20 wide	510**	11.5	17
Frame to supporting construction fire stopping detail	Mann McGowan Fabrications Ltd Pyromas intumescent acrylic mastic	Nominally 5-10mm wide x 10-15 deep	-	-	-
Frame to supporting construction fixing detail	3No steel wood screws per jamb	80 long	-	-	-
Architrave	European redwood	18 thick	510**	-	-
Threshold	Non combustible	-	-	-	-

* Stated density not checked by laboratory

** Nominal density

Intumescent materials – both doorsets

	Make/type	Size (mm)	Location	Key to figures	
Door edges	None fitted	-	-	-	
Frame reveal	Head and jambs	Intumescent Seals Ltd Therm – A – Seal	15 x 4	Centrally fitted in the frame reveal	18
Around hinges	Fully interrupted	-	Hinge blade fully interrupts seal on frame jamb	-	
Under hinge blade	None fitted	-	-	-	
Encasing latch body	None fitted	-	-	-	
Under latch forend	None fitted	-	-	-	
Around latch keep	Fully interrupted	-	-	-	
Under latch keep	None fitted	-	-	-	
Panel perimeter – doorset A only	Mann McGowan Fabrications Ltd Pyromas 'A' intumescent mastic	1-2 thick	Fitted around the perimeter of the panels	19	

The legal validity of this report can only be claimed on presentation of the complete report.

Hardware – both doorsets

	Make/type	Size (mm)	Location	Key to figures
Hinges	Royde and Tucker Hi-Load 105 lift off type hinges	100 x 35 (blade size)	Fitted 150mm, 925mm and 1702mm from the head of the leaf	20
Closer	Dorma (UK) Ltd TS71 overhead type closer	230 x 68 (footprint size)	Fitted on the exposed face as per the manufacturers instructions	21
Latch	Eurospec tubular mortise latch	57 x 26 (forend size)	Fitted 1035 from the head of the leaf	22
Furniture	Aluminium lever type handle	100 x 38 (footprint size)	Fitted appropriate to the latch	23

The legal validity of this report can only be claimed on presentation of the complete report.



Appendix - figures 1 to 4

The legal validity of this report can only be claimed on presentation of the complete report.

Doorset A

Doorset B

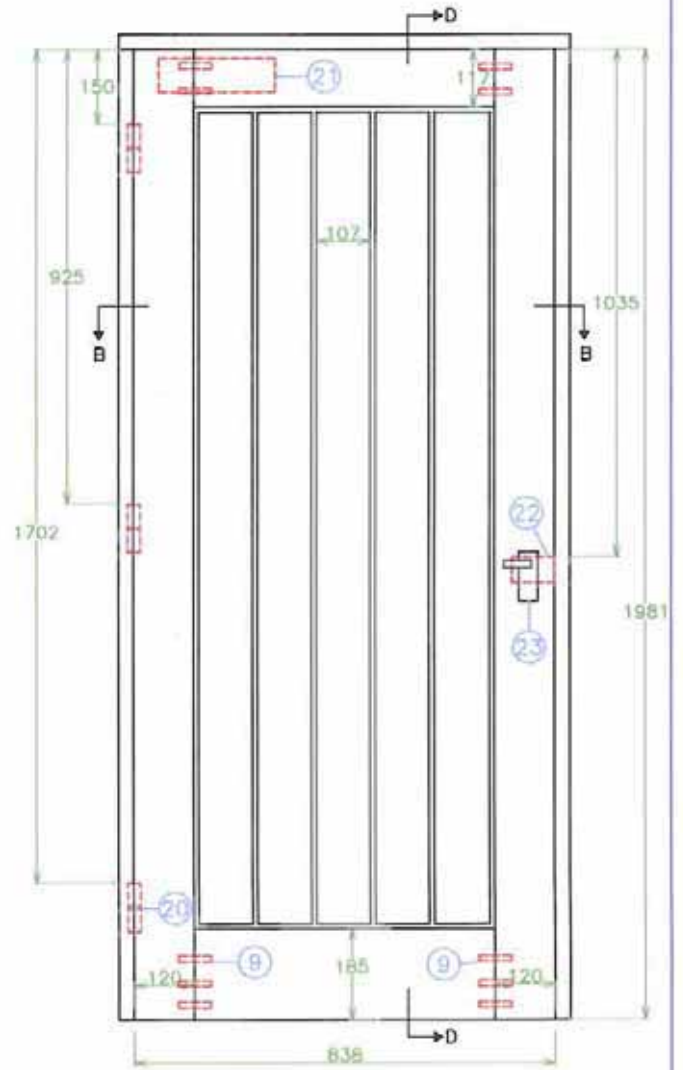
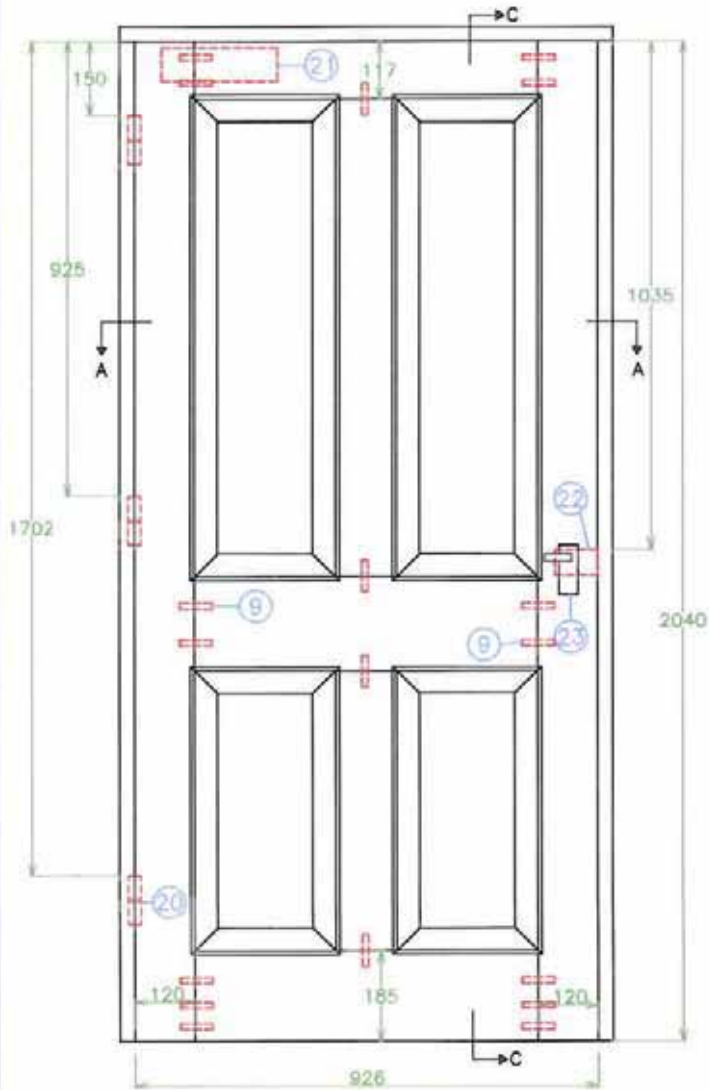

Chiltern House, Stocking Lane, Hughenden Valley
 High Wycombe, Buckinghamshire, HP14 4ND, UK.
 Tel: +44 (0)1494 569800 Fax: +44 (0)1494 564895

Title: Unexposed face elevation showing hardware positions
 (All dimensions in mm)

Date Drawn 25/11/08	Drawn By ARD	Scale NTS
Project No. Chilt/RF08156		Appendix

Section A-A

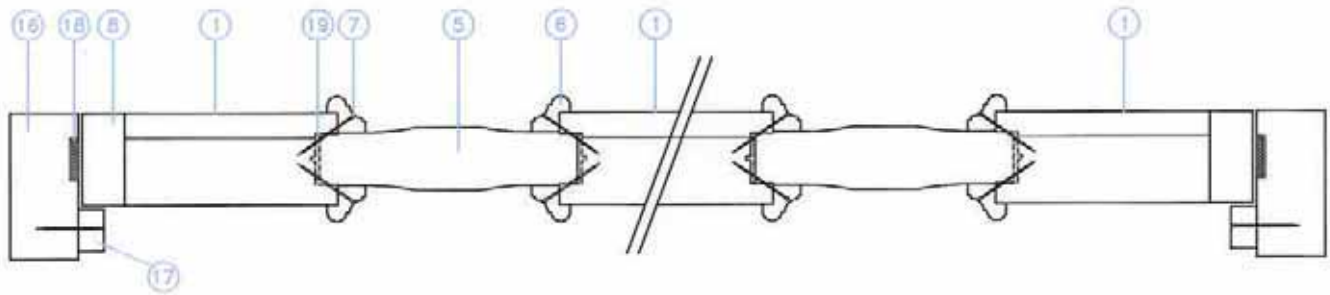

Section B-B

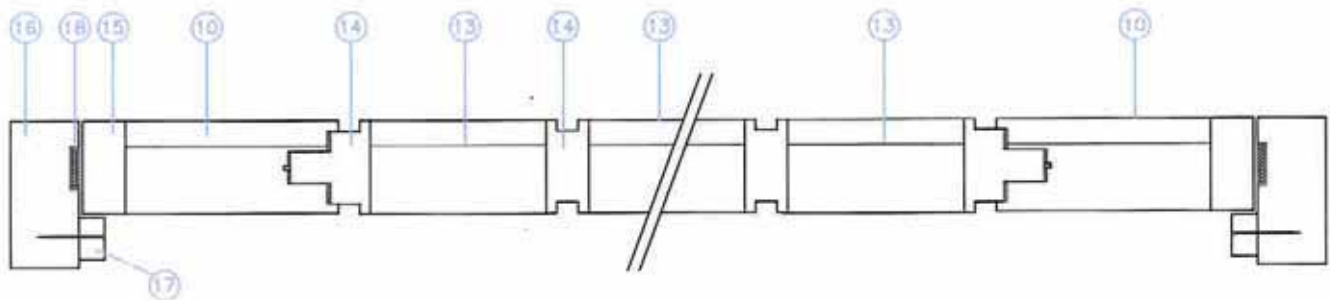

Chiltern House, Stacking Lane, Hughenden Valley
 High Wycombe, Buckinghamshire, HP14 4ND, UK.
 Tel: +44 (0)1494 569800 Fax: +44 (0)1494 564895

Title		
Horizontal cross sections (All dimensions in mm)		
Date Drawn	Drawn By	Scale
25/11/08	ARD	NTS
Project No.		Appendix
Chilt/RF08156		

Section C-C

Section D-D

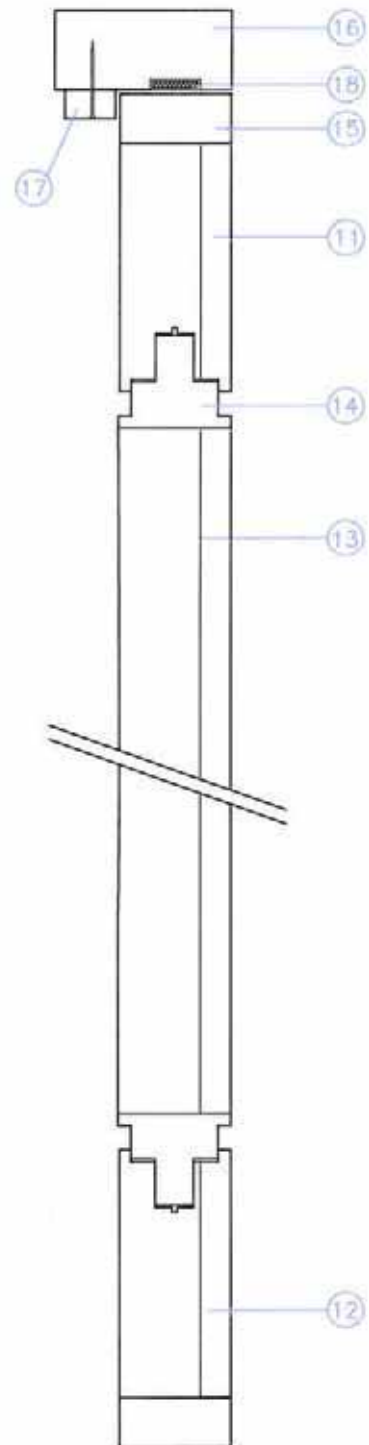
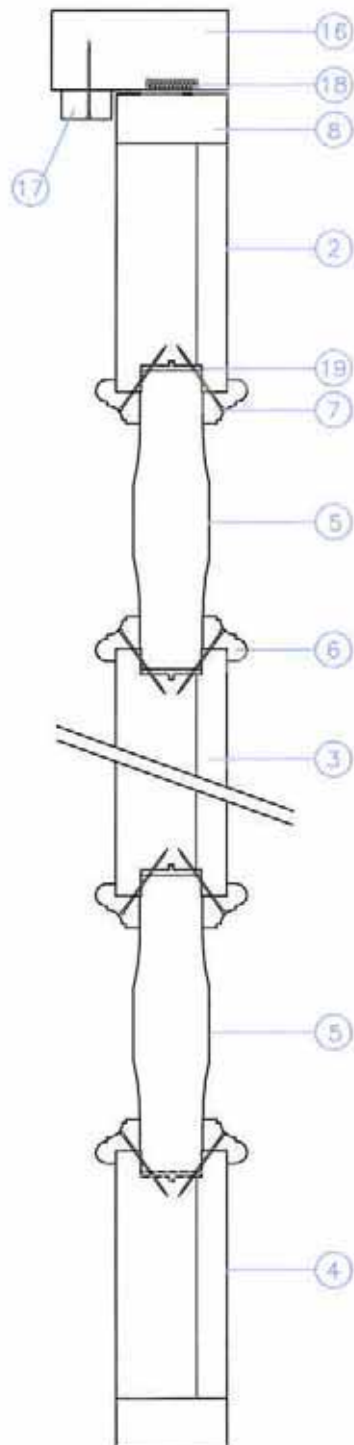

Chiltern House, Stocking Lane, Hughenden Valley
 High Wycombe, Buckinghamshire, HP14 4ND, UK.
 Tel: +44 (0)1494 569800 Fax: +44 (0)1494 564895

Title

Vertical cross section

Date Drawn
 25/11/08

Drawn By
 ARD

Scale
 NTS

Project No.
 Chilt/RF08156

Appendix

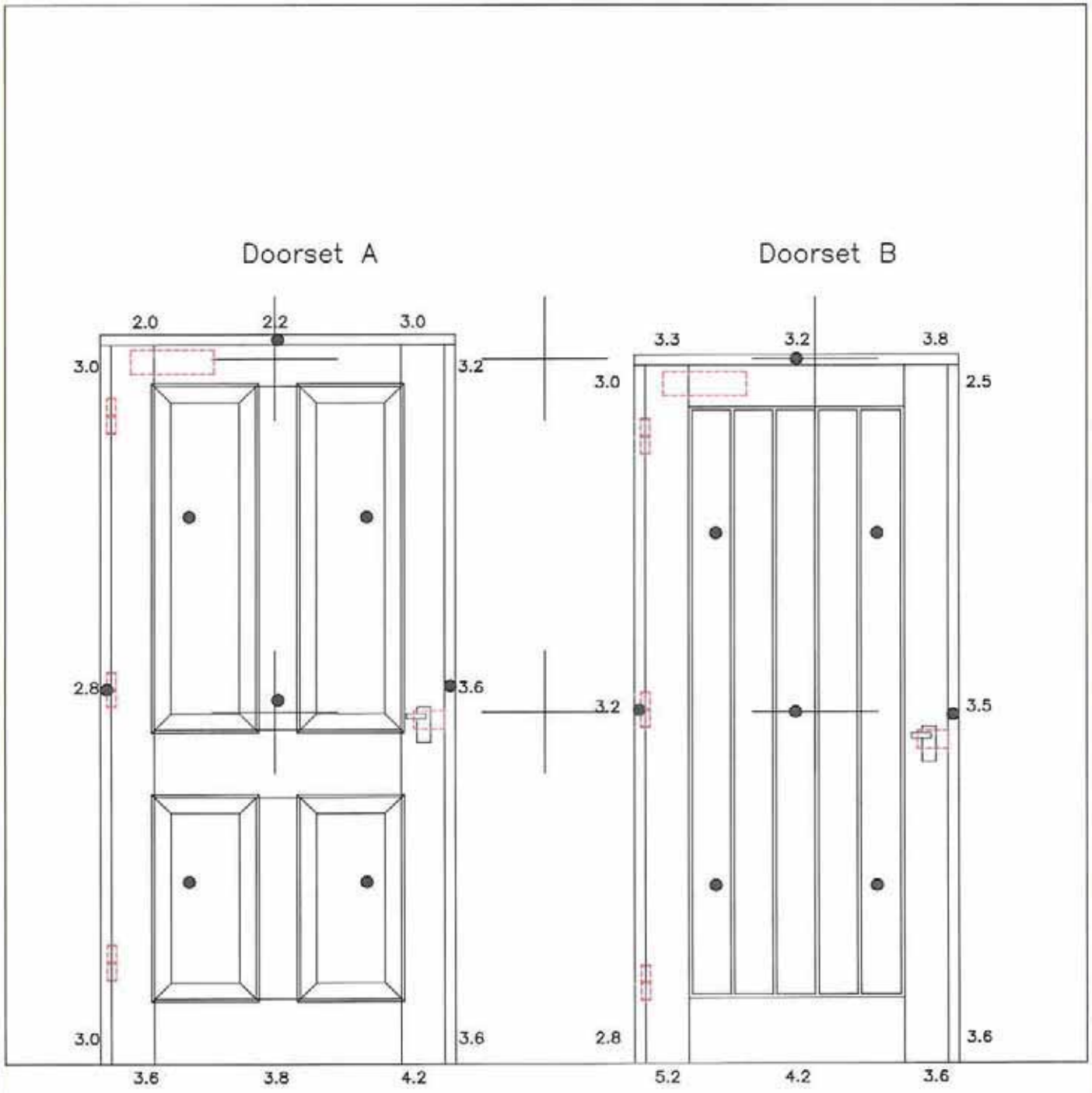

+ : Furnace Thermocouples
 • : Unexposed Face Thermocouples

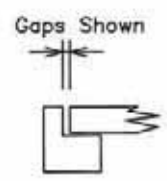

Viewed From Unexposed Face



Chiltern House, Stocking Lane, Hughenden Valley
 High Wycombe, Buckinghamshire, HP14 4ND, UK.
 Tel: +44 (0)1494 569800 Fax: +44 (0)1494 564895

Title Thermocouple positions and door gaps (All dimensions in mm)		
Date Drawn 25/11/08	Drawn By ARD	Scale NTS
Project No. Chilt/RF08156		Appendix