

Introduction

This leaflet gives a general overview of the materials and assembly method for constructing the internal storage elements of the sliding doors. **Size applications and method of panel assembly can vary due to specific requirements, however this leaflet shows what can be achieved using the components identified.**

Application and Assembly Example

The illustration below shows a typical example of what can be achieved detailing panel sizes and component positioning.

Note: Panels should be cut to size and measured according to your installation requirements. Please check dimensions before cutting panels to avoid issues during assembly.

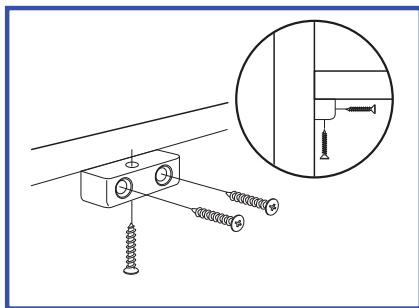
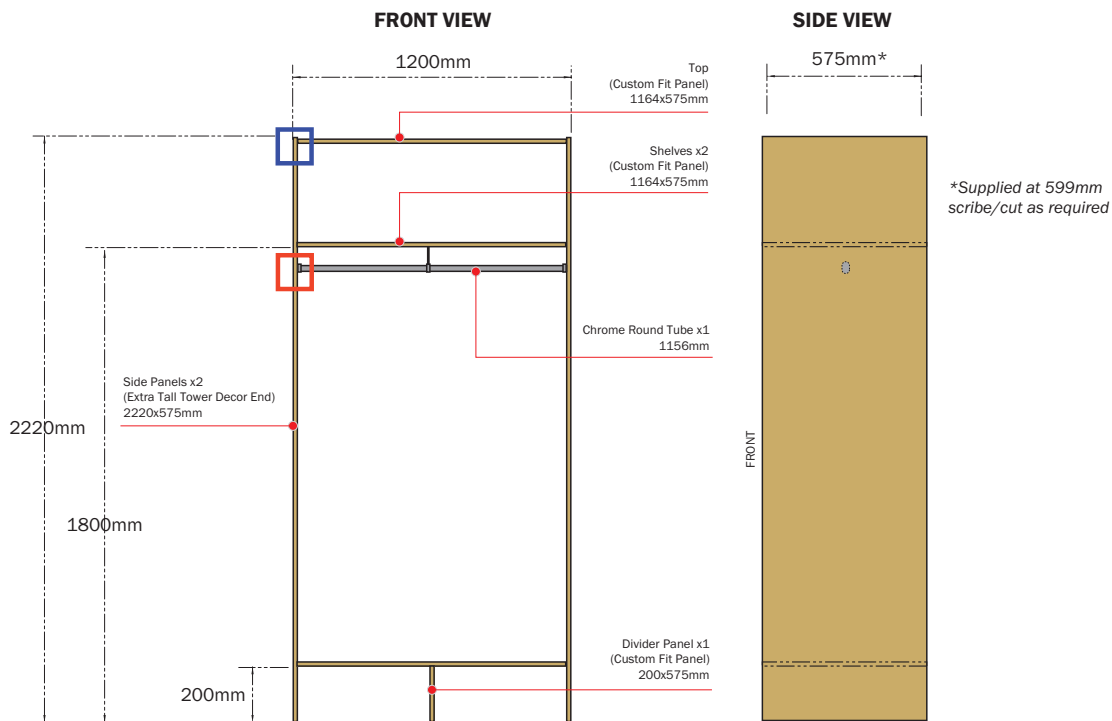

Panel Fixing

Panels should be secured together using KD blocks and screws.

Note: For a 'hidden fixing' look, use assembly screws through a panel and into the adjoining decor end panel edge.

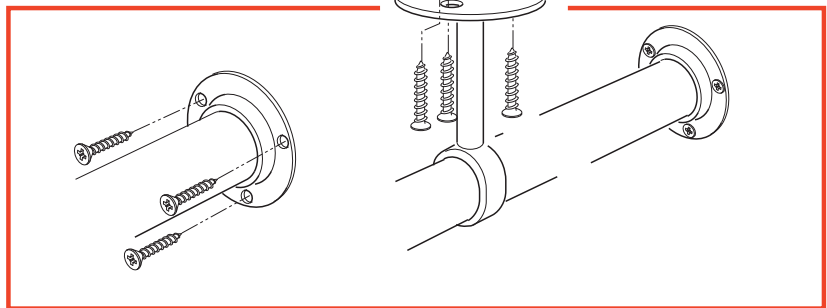

Rail Fixing

Using the dimensions above, cut the round tube to size. Fit the sockets to each end and secure to the side panels, using the screws supplied.

Note: Before securing both the sockets, place the centre bracket onto the tube so it can be secured once both end sockets are fixed in position. The height of the rail is determined by the height of the centre bracket.

Components & Fittings Required*

*The components listed are a general overview for the installation example shown. Other permutations can be achieved depending on your internal storage requirements.

Follow the leaflets supplied with the sliding doors and the kitchen installation manual for door and drawer fixing

Extra Tall Tower Decor End x2
Custom Fit Panel x2
Chrome Round End Socket x2
Chrome Round Tube x1
Chrome Round Centre Bracket x1

Range specific
Range specific
GIR0052
GIR0040
GIR0051

KD Blocks
Assembly screws - 30mm

Sliding doors and track (2 doors)
The example shown in this leaflet uses:

Product as required

Mirror Door White Edge (610mm) x2
White Track Set (1200mm) x1

GIR2011
GIR2036

Installation Example



Shelving above the hanging rail using custom fit panel



Hanging rail created using chrome round tube, centre bracket and end sockets



Mirror door design

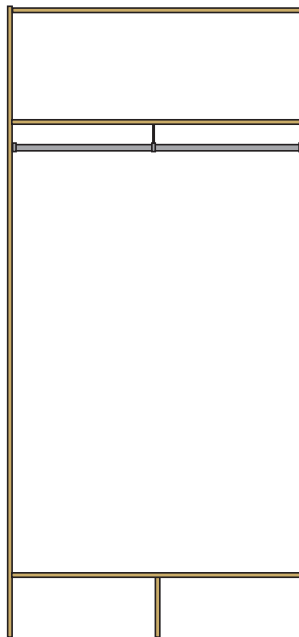

Double doors with full length hanging options



Bottom shelf and lower compartments ideal for shoe storage



Other shelving options can be created using custom fit panels