

Door Pair Maker Fitting Instructions

Follow the step by step guide for fitting a door pair maker

Part Location Diagram

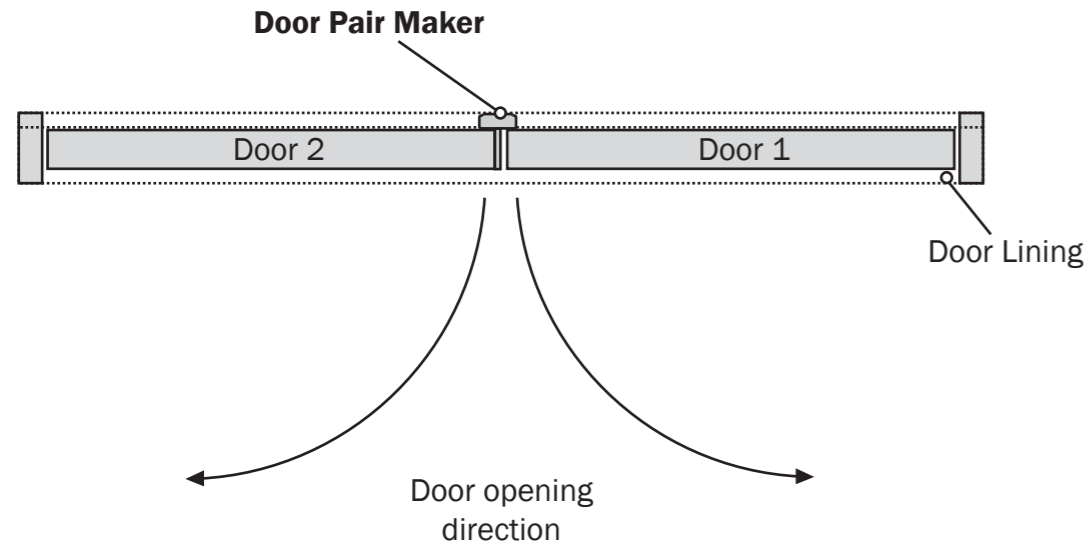

The gap between the doors should be a continuous 12mm in order for the door pair maker to be fitted.

The door pair maker may require trimming depending on the height of the door. If doors are binding once the door pair maker is fitted, plane a small amount from the side of the adjoining door.

1

Position the door pair maker to the lining. Mark the face of the pair maker to the underside of the door lining using a pencil, then cut out a 'notch' on the pair maker to suit the lining.

Note: Cutting out a 'notch' section is required for the door to close onto the lining to act as a stop.

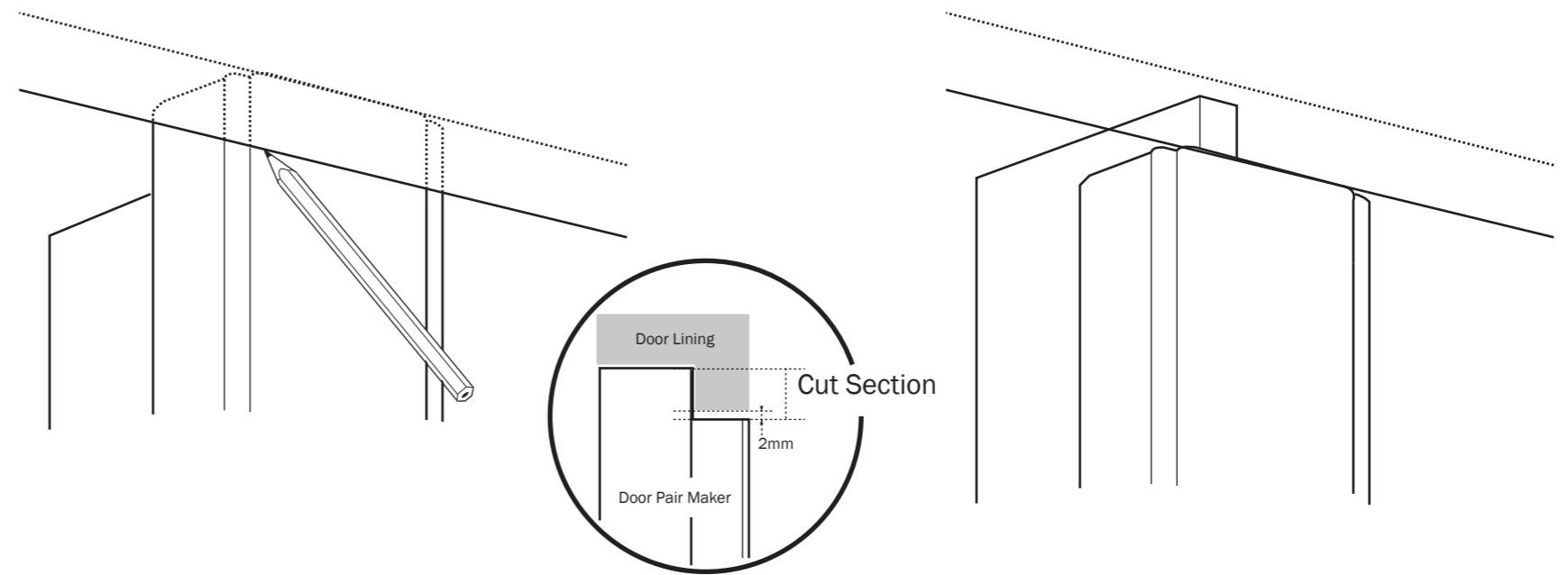

2

Fit the door pair maker to the side of the door using glue and screws or glue and pins to secure.

Note: Make sure the door pair maker is aligned correctly to the side of the door.

