

Important Notes:

Ensure packaging is disposed of in a safe environmentally friendly way

Remove packaging and place panels in the room intended for panelling 48hrs before installation

Ensure walls are clean and smooth with any loose wall paper or paint removed

We recommend panels are cut as required during the installation process to ensure an accurate fit. Always start in a corner or by a door opening.

Panelling can be finished in paint, stain or varnish following the manufacturers guidelines. Lightly sand as required

Panelling is splashproof but must not be submerged or subjected to constant running water

Howdens Joinery supply Traditional & Contemporary Skirting, Architrave & Dado to use with wall panelling

Note: Some Skirting, Architrave & Dado rails may require additional modification before fitting due to the thin or rounded profile design. Please refer to chart overleaf

Installation

- 1 Mark the height of the panel from the lowest point. Place the first panel against the wall and ensure square.

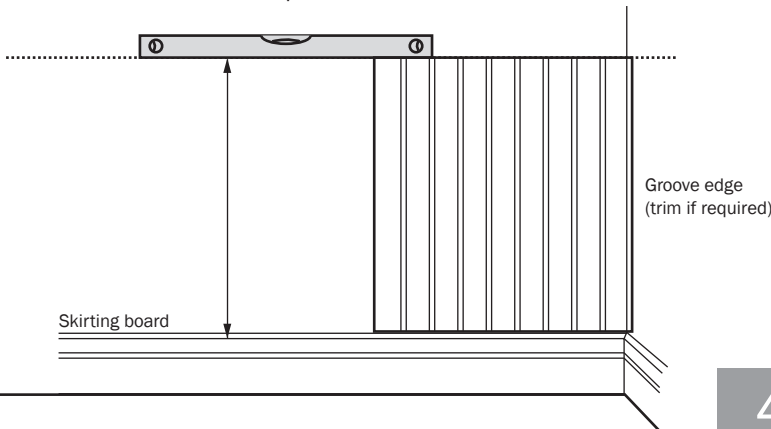

- 2 Apply adhesive to the back of the panel and peel backing from adhesive strip.

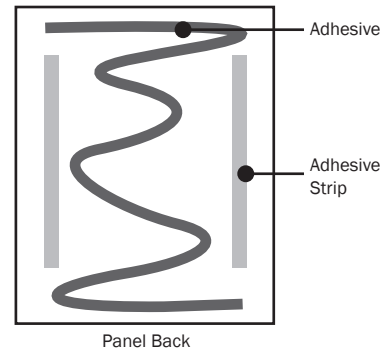

- 3 Position and join the panels together preparing each panel as required. Press firmly to the wall. **Note:** Ensure tongue & groove are fully located.

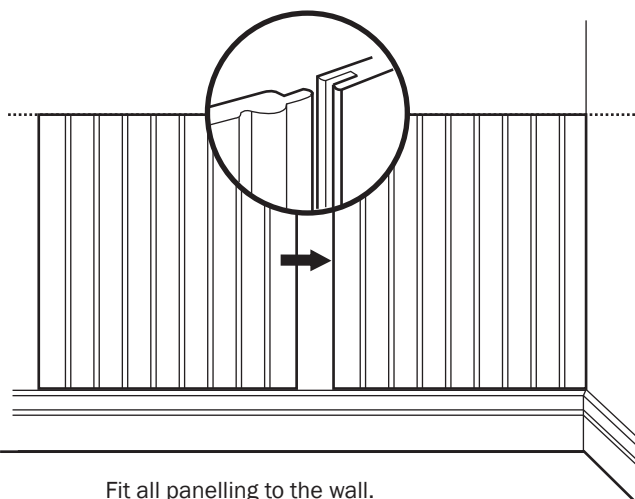

- 4 Once base panelling is fitted, place architrave/dado rail onto the top edge & use adhesive to secure. Mitre corners as required. **Note:** Architrave/dado rails can also be applied direct onto the panelling if required. However, this will mean the rail may sit proud of the architrave if running into a door frame as shown below.

Example of Dado rail fitting, where profiles would require blending

Example of Dado rail fitting onto panelling, sitting proud of the door frame

Architrave/Dado mitred before fitting

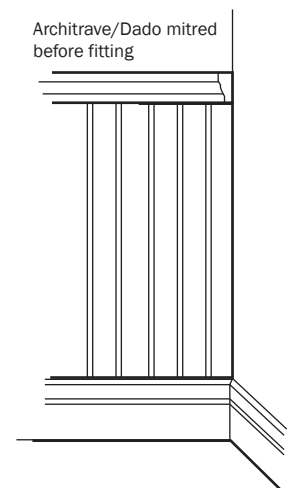
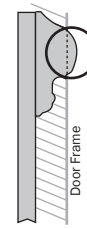
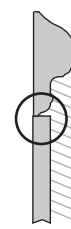
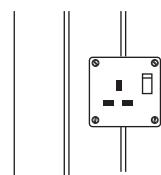

Cut panelling around plug sockets measuring the appropriate hole. Face plates should be removed and surface mounted.

Note: Electrical supply should be turned off before removing face plate.

Howdens Skirting, Architrave & Dado Rail compatibility guide

SKU	DESCRIPTION	DIMENSIONS	FITTING INFORMATION
MOD0501	PRIMED MDF CHAMFERED SKIRTING	4200 x 95 x 14.5	Extra work would be required to blend the profiles together*
MOD0502	PRIMED MDF TORUS SKIRTING	4200 x 120 x 18	✓
MOD0503	PRIMED MDF TORUS SKIRTING	4200 x 170 x 18	✓
MOD0504	PRIMED MDF OGEE SKIRTING	4200 x 120 x 18	Extra work would be required to blend the profiles together*
MOD0505	PRIMED MDF OGEE SKIRTING	4200 x 70 x 18	Extra work would be required to blend the profiles together*
MOD0506	PRIMED MDF CHAMFERED ARCHITRAVE	4200 x 45 x 14.5	Extra work would be required to blend the profiles together*
MOD0507	PRIMED MDF OGEE ARCHITRAVE	4200 x 70 x 18	Extra work would be required to blend the profiles together*
MOD0508	PRIMED MDF TORUS SKIRTING	4200 x 70 x 18	✓
MOD0509	PRIMED MDF DADO RAIL	4200 x 58 x 18	Extra work would be required to blend the profiles together*
MOD0510	PRIMED MDF PENCIL ROUND SKIRTING	4200 x 95 x 14.5	Extra work would be required to blend the profiles together*
MOD0511	PRIMED MDF PENCIL ROUND ARCHITRAVE	4200 x 45 x 14.5	Extra work would be required to blend the profiles together*
MOD0520	PRIMED MDF PLAIN SQUARE SKIRTING	4200 x 94 x 14.5	✓
MOD0521	PRIMED MDF PLAIN SQUARE ARCHITRAVE	4200 x 44 x 14.5	✓
MOD0525	PRIMED MDF PLAIN SQUARE SKIRTING	4200 x 94 x 12	✓
MOD0526	PRIMED MDF PLAIN SQUARE ARCHITRAVE	4200 x 44 x 12	✓
MOD0536	PRIMED MDF BURFORD CONTEMPORARY SKIRTING	4200 x 69 x 14.5	✓
MOD0537	PRIMED MDF BURFORD CONTEMPORARY ARCHITRAVE	4200 x 119 x 14.5	✓
MOD0600	OAK VENEERED SKIRTING	4200 X 120 x 18	Extra work would be required to blend the profiles together*
MOD0601	OAK VENEERED ARCHITRAVE	4200 X 70 x 18	Extra work would be required to blend the profiles together*
MOD0532	OAK VENEERED BURFORD CONTEMPORARY SKIRTING	4200 x 69 x 14.5	✓
MOD0533	OAK VENEERED BURFORD CONTEMPORARY ARCHITRAVE	4200 x 119 x 14.5	✓
MOD0530	OAK VENEERED BURFORD TRADITIONAL SKIRTING	4200 x 119 x 14.5	Extra work would be required to blend the profiles together*
MOD0531	OAK VENEERED BURFORD TRADITIONAL ARCHITRAVE	4200 x 69 x 14.5	Extra work would be required to blend the profiles together*
MOD0534	BURFORD PRIMED MDF TRADITIONAL SKIRTING	4200 x 119 x 14.5	Extra work would be required to blend the profiles together*
MOD0535	BURFORD PRIMED MDF TRADITIONAL ARCHITRAVE	4200 x 69 x 14.5	Extra work would be required to blend the profiles together*
MOD0403	SOFTWOOD TORUS SKIRTING	4200 x 120 x 18	✓
MOD0404	SOFTWOOD TORUS SKIRTING	4200 x 170 x 18	✓
MOD0405	SOFTWOOD TORUS ARCHITRAVE	2100 x 71 x 18mm	✓

*Some profiles cannot finish flush with the panelling if fitted directly onto the top due to the thin edge. Using these profiles may mean that extra work would be required to blend the profiles together. This could result in the appearance not being as visually acceptable as a flush profile to the MDF Panelling and adjoining architrave.