

# SmartLatch passage and privacy instructions for non-fire doors

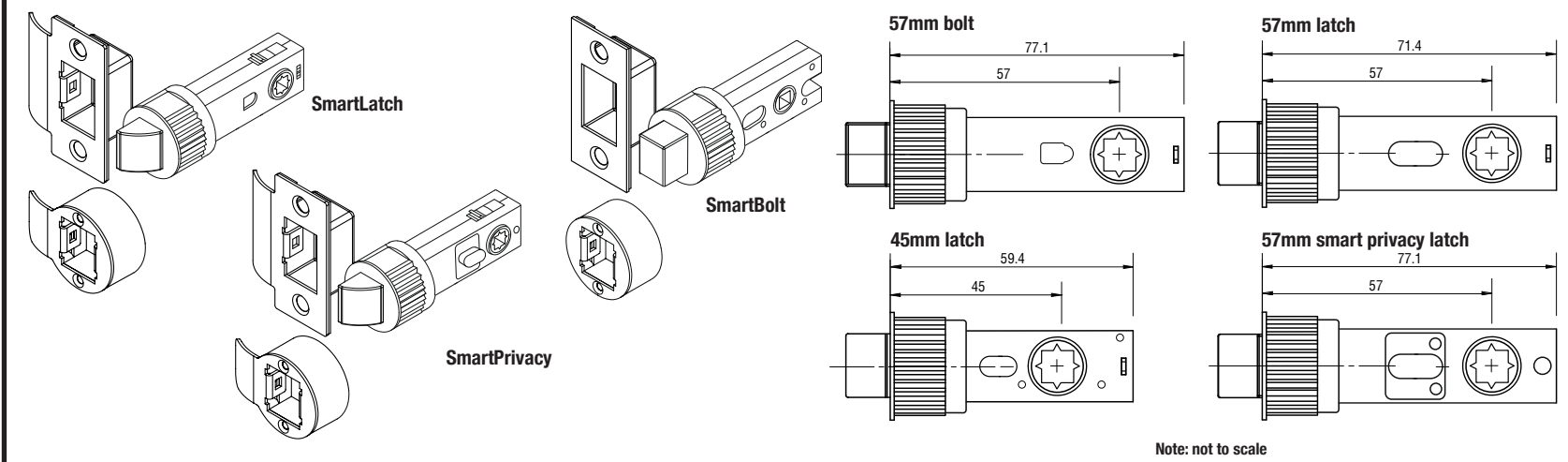

ASSA ABLOY

JIGTECH™

Schema range handle fitting instructions for non-fire doors



▶ SCAN ME

0845 223 2124

uniononline.co.uk

**1**

- Measure the desired height of the latch and draw a horizontal line on the door edge using a set square.
- Select the backset of the latch (45mm or 57mm).
- Line the JIGTECH jig up with the horizontal line you made earlier and fasten the jig onto the door using the thumbturn, ensuring the jig is touch tight. **DO NOT** over tighten the jig.
- The latch/bolt should not be installed higher than 1100mm from the centre of the lock to the finished level of the surrounding floor.

**2**

- Using the 44mm arbor and holesaw, drill through the face of the door from the guide side until the drill tip exits the timber on the opposing side. Switch sides and use the exit point as the guide to continue drilling (by applying low pressure) and remove the core. **DO NOT** place too much pressure on the drill.

**3**

- Using the 25mm arbor and holesaw, drill the latch/bolt hole through the centre of the door edge and remove the core and any debris.
- Remove the jig and any sawdust from the door.

**4**

- Place the keep locator (JTA5103) inside the 25mm hole with the stainless steel tip facing the frame. Close the door shut and using a screwdriver, push the keep locator into the frame to create a centre mark.
- Using the mark made by the keep locator, position the 32mm spade bit (JTA5003) and drill a 17mm deep hole.

**5**

- Insert the metal dust box into the 32mm hole, ensuring the diagonal pre-drilled holes are horizontal. Using the fixing screws provided, secure the dust box to the frame.
- Position the strike plate over the vertical screw holes and mark where the lip needs to be cut out of the frame to ensure they are flush and remove the excess wood.
- Fit the strike plate using the remaining screws provided.

**6**

- Insert the JIGTECH metal spacer that is supplied with the latch/bolt into the 44mm hole on the face of the door with the Jigtech logo at the top.
- **Ensure the latch bolt is facing the correct direction.**
- If fitting a SmartPrivacy latch, ensure the threaded button is on the internal side of the door.
- Insert the latch/bolt into the 25mm hole on the door edge, using a latch tapper (included in the Jigtech PRO kit (JTP6000) or bought separately (JTA5103) - place around the latch/bolt and tap in until secure, taking

**care to avoid hitting the latch bolt.**

- If the latch feels too tight, enlarge the hole by reinserting the 25mm holesaw to remove a small amount of wood. Alternatively, a light rub with sandpaper on the inside edge will allow the latch/bolt to sit more flush within the door.
- **PLEASE NOTE: There is a risk of the door splitting if the hole drilled for the latch/bolt is too small.**

**Don't forget to remove the red insert from the jig**

**Ensure all holes are drilled straight and square**

**Important! Do not hammer the latch into position**

## Schema handle fitting instructions - passage only

- 1** • Each Schema handle pair is supplied with one handle pre-assembled with screws and spindle, for ease of fitting.

- To begin installation, the handle without screws needs to be removed from the spindle by undoing the grub screw on the underside. The lever, rose and metal base can then be removed from the spindle.

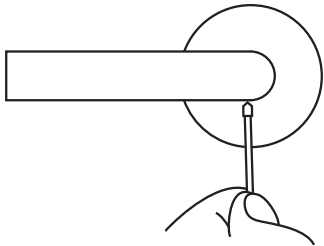

- 2** • Next, take the pre-assembled handle and fit to the door, by pushing the spindle into the latch follower located in the centre of the metal spacer, until the lever is flush with the door face. The sleeves will locate into the top and bottom holes of the spacer.

- Ensure the large split in the spindle is located on the underside of the lever.

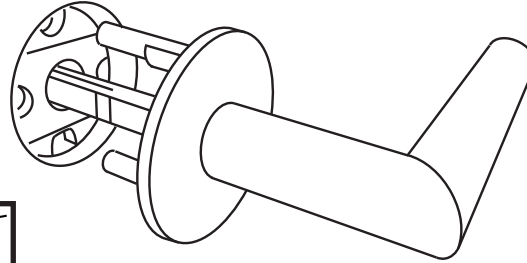
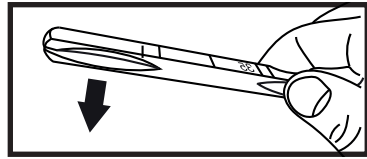

- 3** • Position the remaining metal base onto the exposed side of the spindle, ensuring the spindle is equal on either side of the door.

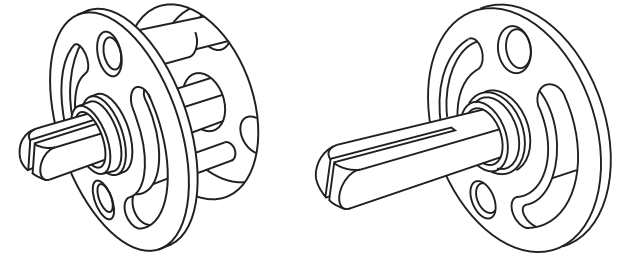

**PLEASE NOTE: The base components are handed and therefore it is important that they are fitted in the correct orientation, as shown below.**

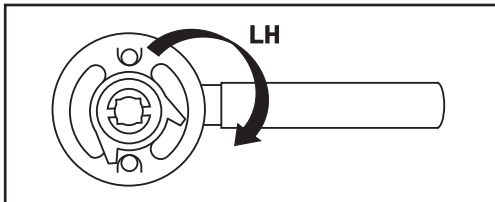
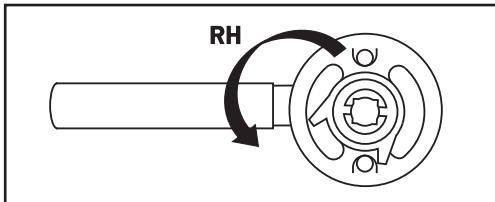

- 4** • Using the screws provided, secure the metal base in place.

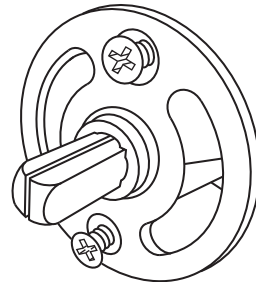

- 5** • Attach the cover rose, by pressing firmly in place, ensuring the notch is on the underside.

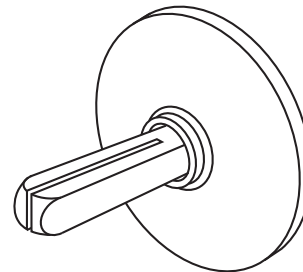

- 6** • Slide the lever onto the spindle and fix in place by tightening the grub screw located on the underside of the lever.

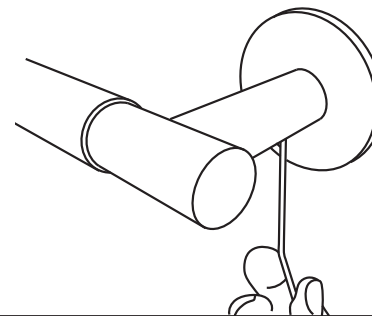

**PLEASE NOTE: SmartBolt can only be used with the bathroom turn & release.**

