

- Cuts down fitting time from 25 to 5 minutes
- 100% accurate – no chiselling for different roses/handles
- Reduced number of tools needed – 2 hole saw sizes, pozidrive bit + tools provided

THE NEW JIGTECH SYSTEM:



JIGTECH FITTING INSTRUCTION MANUAL

Only compatible with Jigtech tubular latches and door furniture.
 FITS IN UNDER 5 MINUTES. 100% ACCURATE.
 PRECISION FITTING EVERY TIME.



Ensure door is hung and wedged securely.



Measure and mark the door handle height. 1.0 metre from floor level is typical.



Adjust the backset to suit tubular latch specification – 45mm or 57mm. Remove the reducing sleeve for Jigtech latches.
 Align the jig with the height mark. Clamp the jig to the door securely without over tightening.

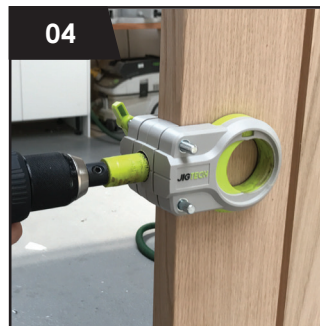

Fit the 25mm hole saw and arbor. Ensuring the drill is level, bore out the latch hole.



Fit the 44mm hole saw and arbor. Ensuring the drill is level, drill through the guide side of the jig.
 Withdraw the holesaw to clear debris during drilling. Once the drill tip exits the door on the opposite face remove the jig.
TIP: reset the jig by clearing debris from the threads and winding it back to the fully closed position.

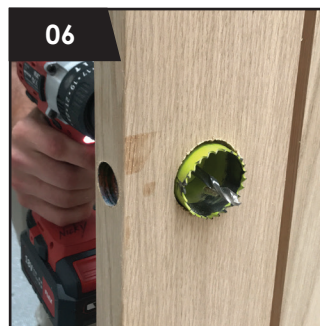

With the jig removed, ensuring the drill is level, drill through from the opposite side using the exit hole as a guide. Then clear the debris from the bore holes.

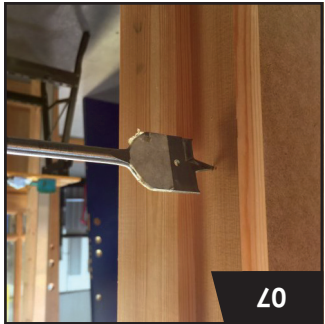

Using the 32mm Spade bit, place the point in the mark on the frame. Drill out the frame to the depth indicated on the spade bit.



Clear the debris from the hole.



Check the socket fits into the hole, and allows 1mm depth for the striking plate to be fitted.

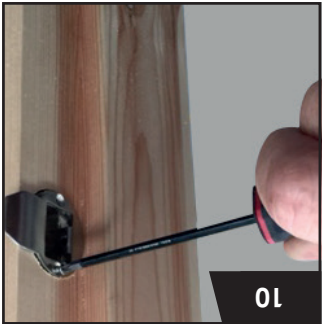

Secure the socket in place with the screws provided. Use pilot holes for hardwoods to prevent screws snapping.



Mark and chisel out for the striking plate lip. Fit the striking plate. Close the door and adjust the anti rattle plates and strike lip to ensure smooth closing action.



Place the spacer in the handle bore hole. Check for correct handling. Insert the latch in the latch bore hole. Take care to insert the latch with the bolt in the vertical position using a small piece of wood to protect the latch and door, cover the latch bolt and tap the keep into the door, until the face plate is flush with the door. *Take care not to use excessive force to drive the latch in. If in doubt, re drill the latch bore with the 25mm holesaw to increase the hole diameter to prevent timber splitting.*

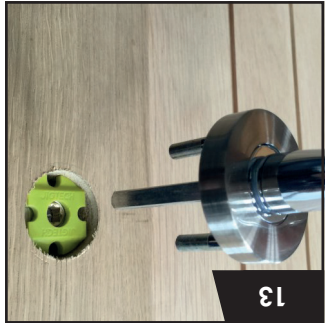

Select the lever side with the spindle fixed. The spindle is set for 35mm door thickness at the factory. Adjust with the hex key provided.

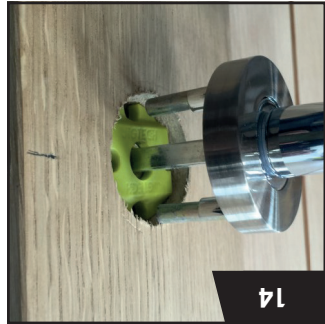

Align the spindle with the sleeves follower and slide the spacer through the spacer.



Connect the remaining handle by pushing the sleeves together securely. Fit the 2 machine screws until tight.



Secondary fix the handle with the grub screw. Tighten into the spindle.



Fit the cover rose in place. Secure with the grub screw provided.