

**Important Notes:**

- Part letter identification is shown for service part purposes
- Ensure packaging is disposed of in a safe environmentally friendly way

## Assembly

**IMPORTANT:** Ensure the cabinet is level, plumb and secured to the wall before installing this product.

**1** Using the template supplied spike runner fixing positions.

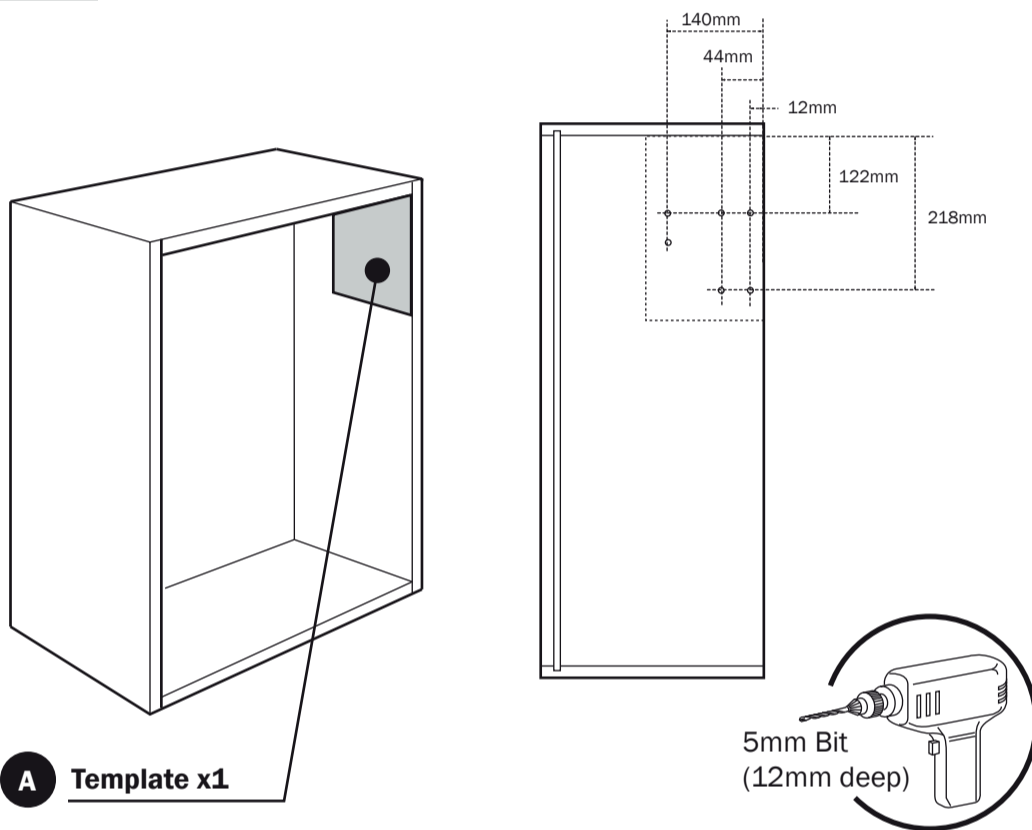

**2** **B** RH Support Arm x1

**C** LH Support Arm x1

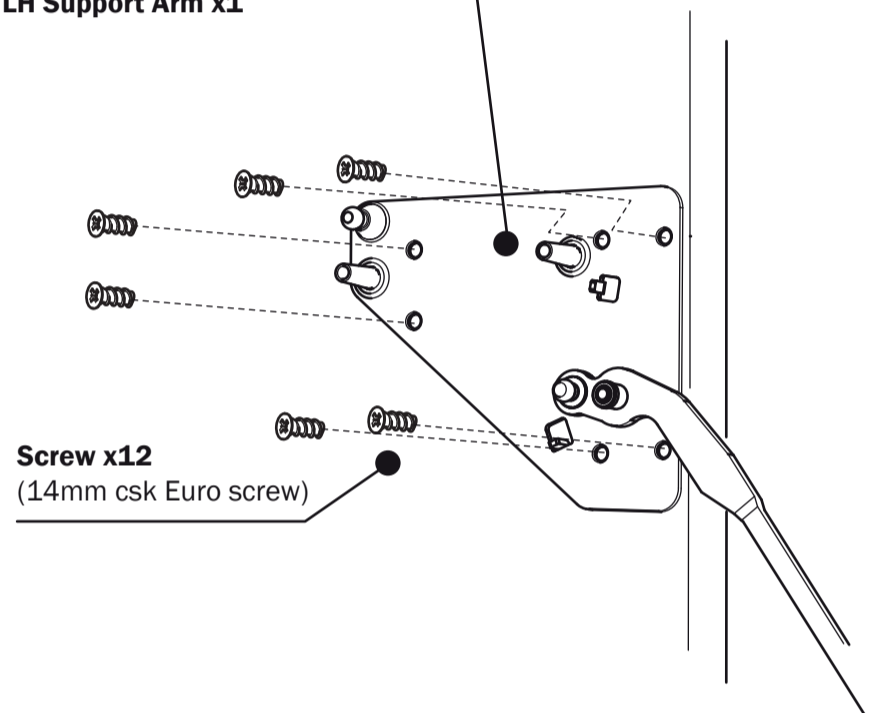

**3** Lift the support arm & press piston onto the bracket pins.

**D** Smove x2

**D** Piston x2

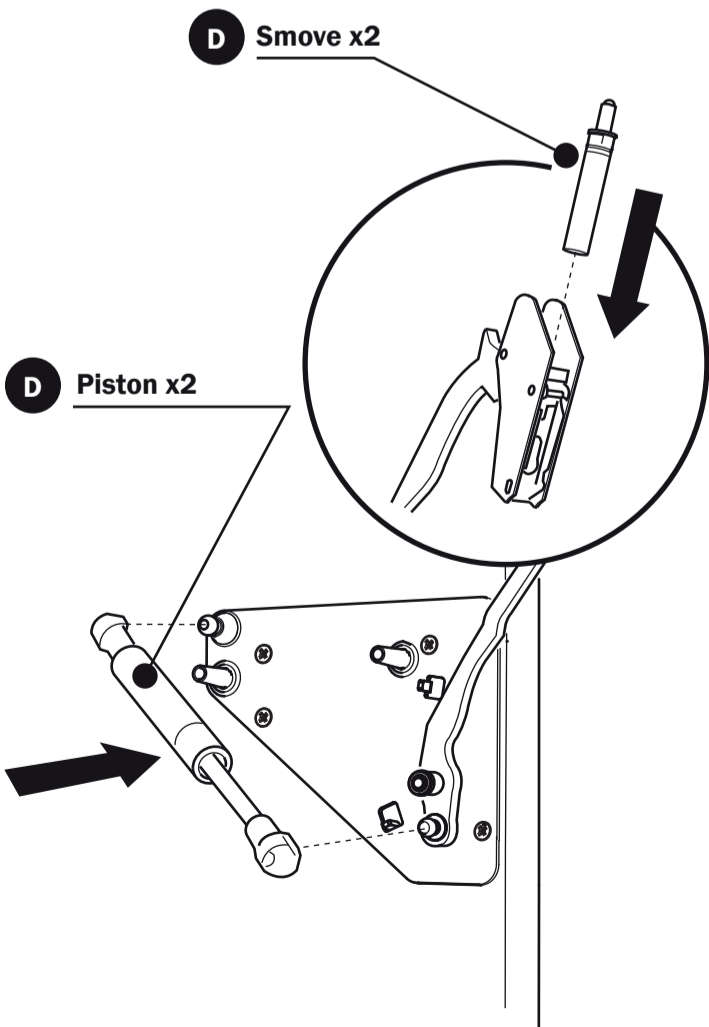

**4** Lay the doors face down and secure hinges. **Note:** The joining hinge hole locations will need to be drilled in the top door.

Screw x4 (4x16mm csk)

Hinge Arm x2

Screw x8 (4x16mm csk)

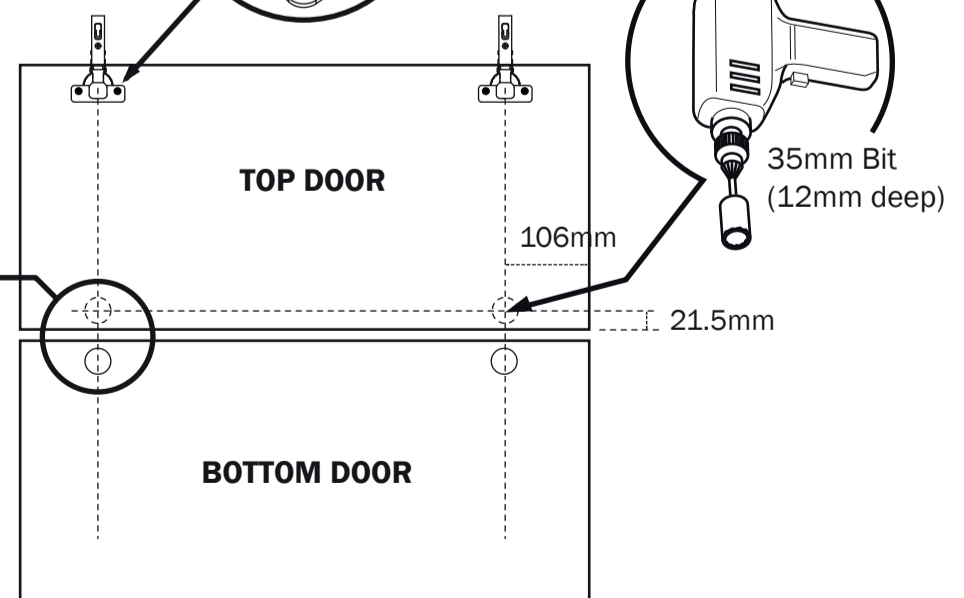
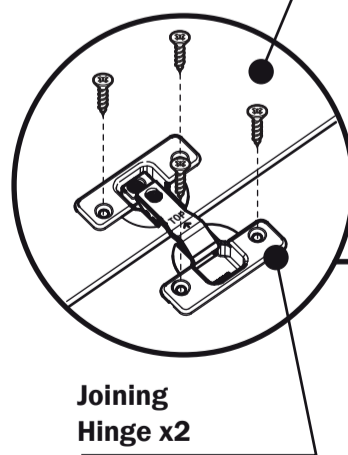

# Assembly

5

Fit the door and cabinet plates.  
**Note:** The plates are very similar in design. Make sure the correct plates are used.

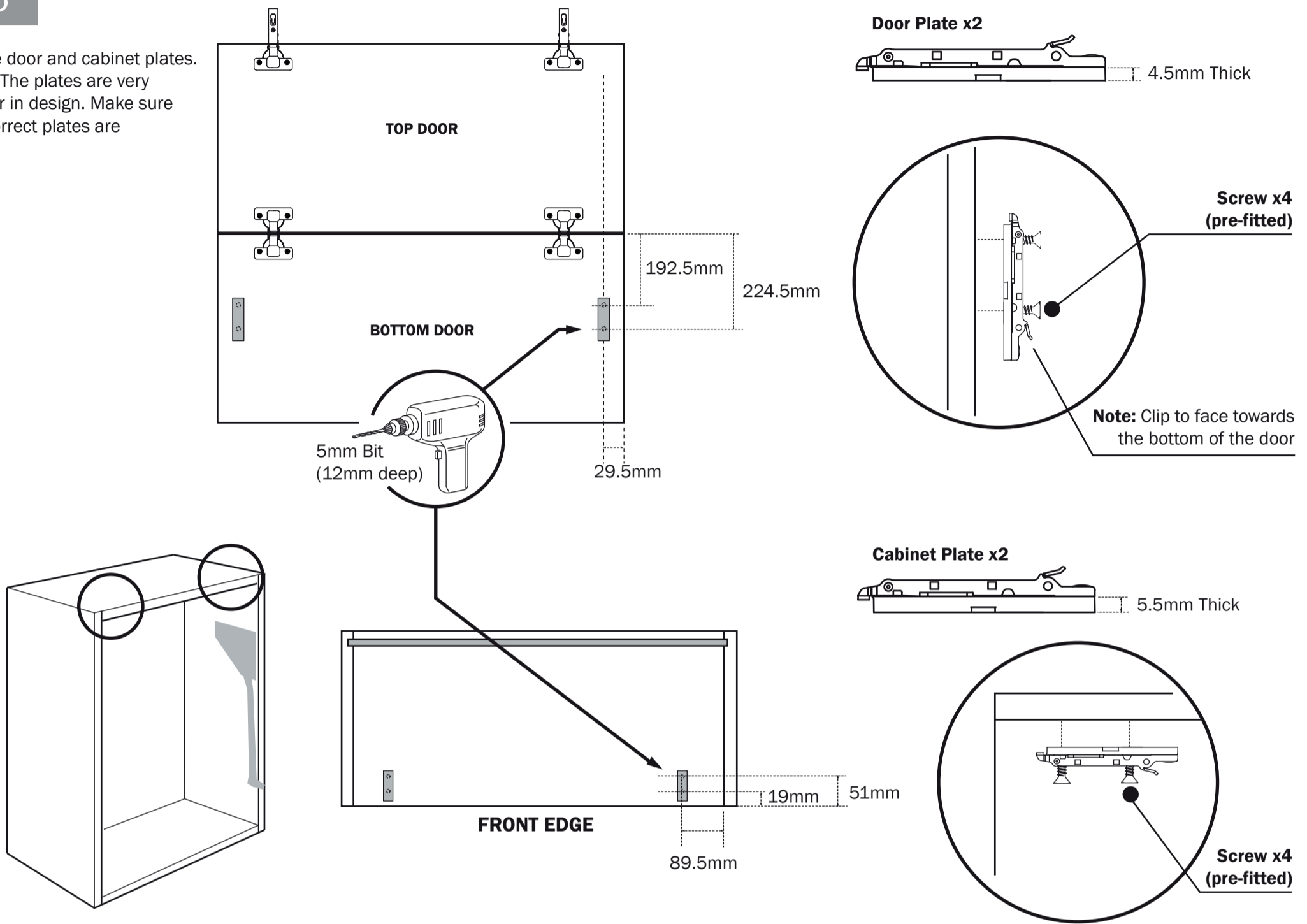

6

Fit the door assembly to the unit aligning the hinge and bracket arms with plates. Clip into place.

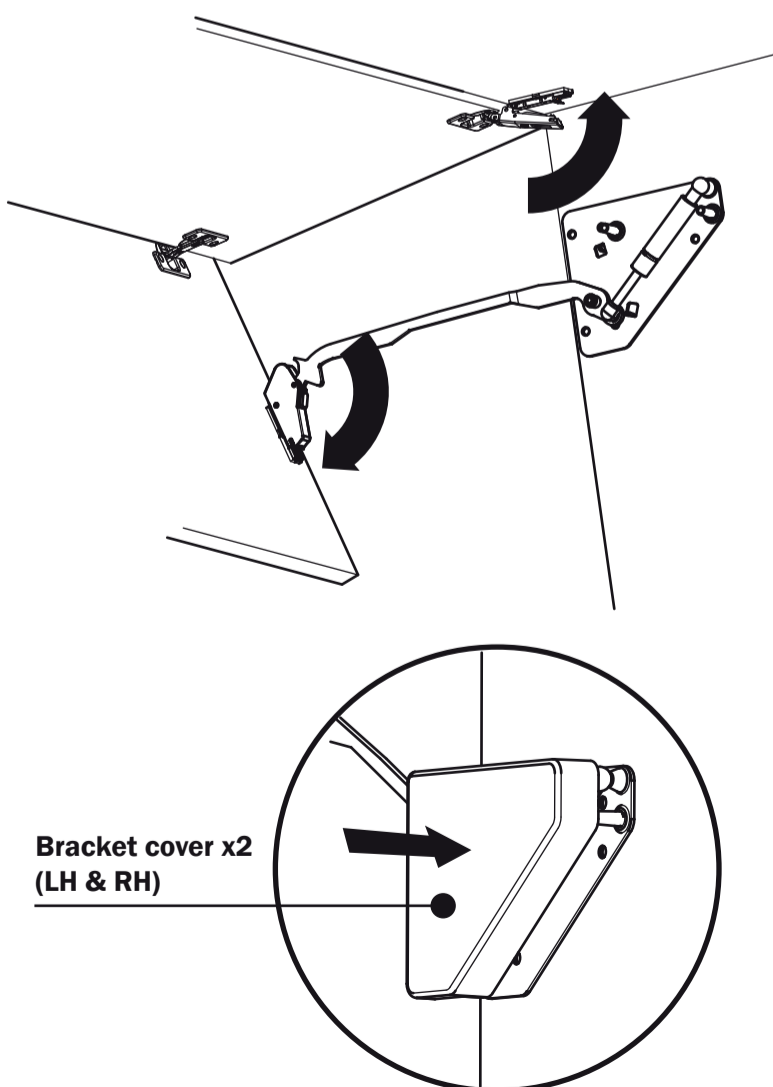

7

If using the lowest height shelf position, this will need to be raised by 20mm.

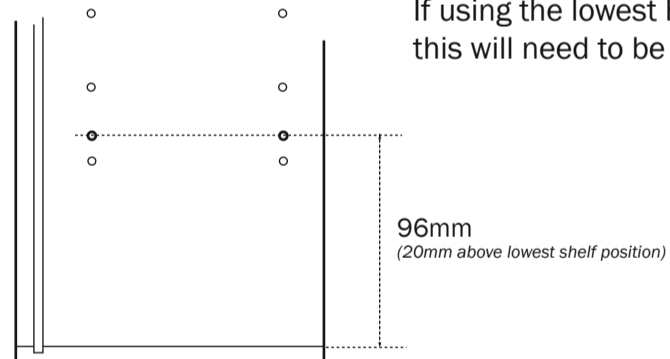

## Adjustment

Up/Down

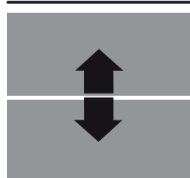

Left/Right

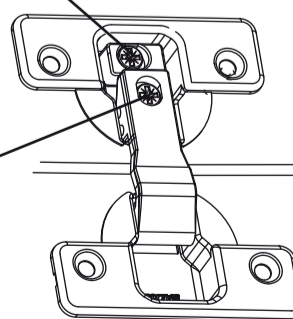
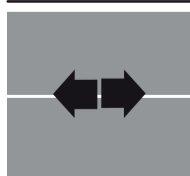

Up/Down

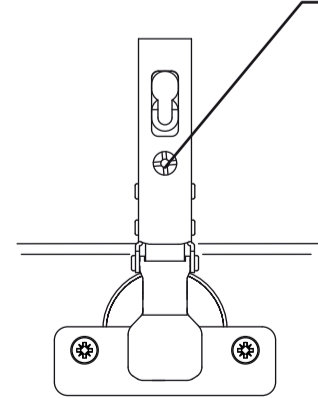

**Note:** To remove the top hinge and support arm from the plates, push the clip down on the plate to release as shown.

