

Care and Maintenance

Single Bowl Sink
1.5 Bowl Sink

SNK2100
SNK2150

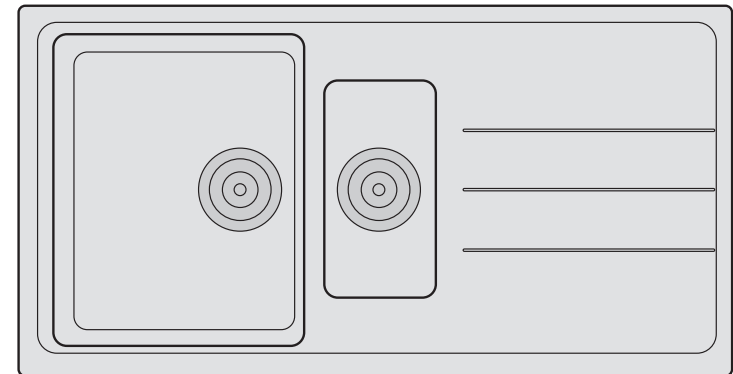
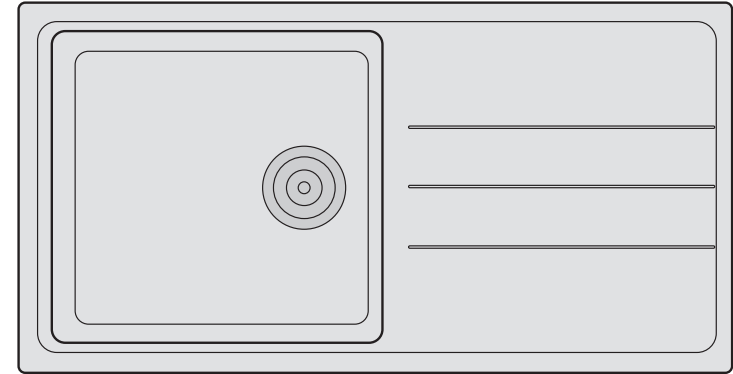
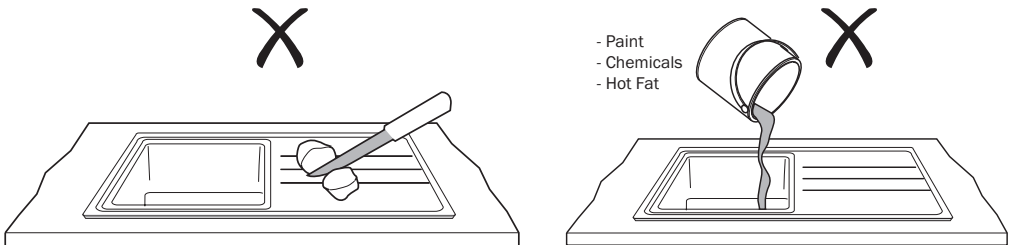
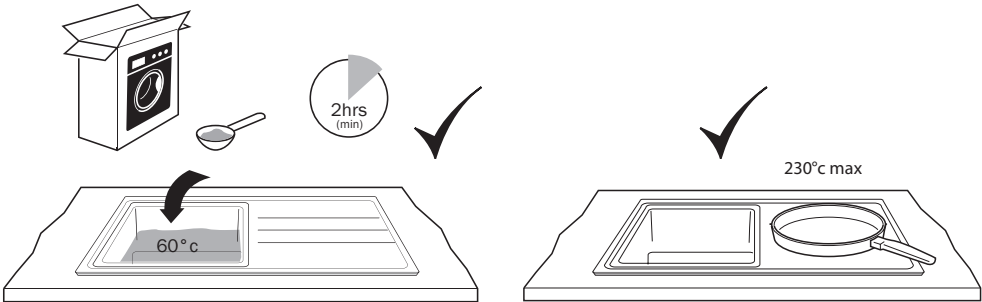
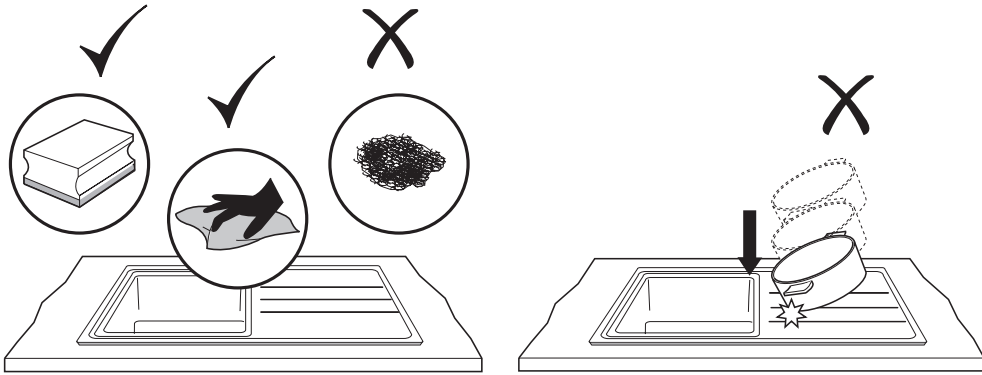

LAMONA
Exclusive to Howdens Joinery Co.

Installation

Measure and Cut

WARNING: SHARP EDGES

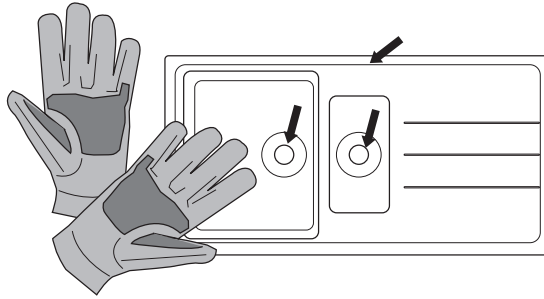

- 1 Lay the sink face down and draw around the edge. Use the measurements below as a guide.

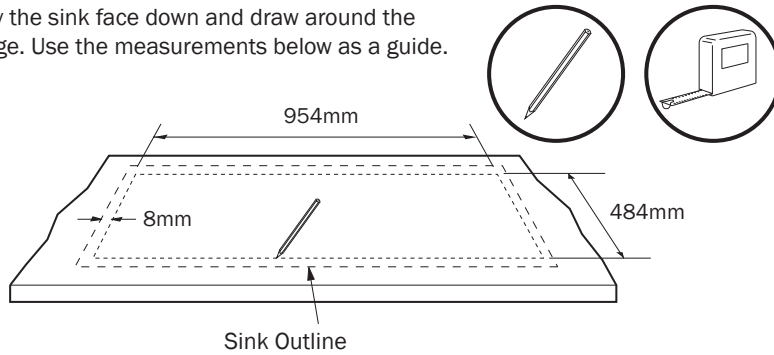

- 2 Cut around the inner line

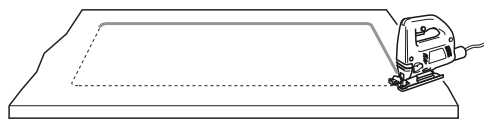

- 3

Wipe Clean

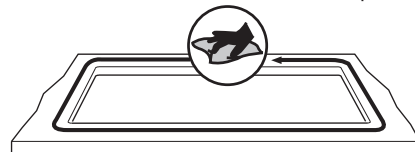

Fitting

- 4

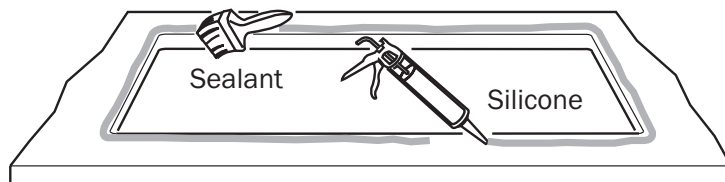

Sink Fitting

- 5

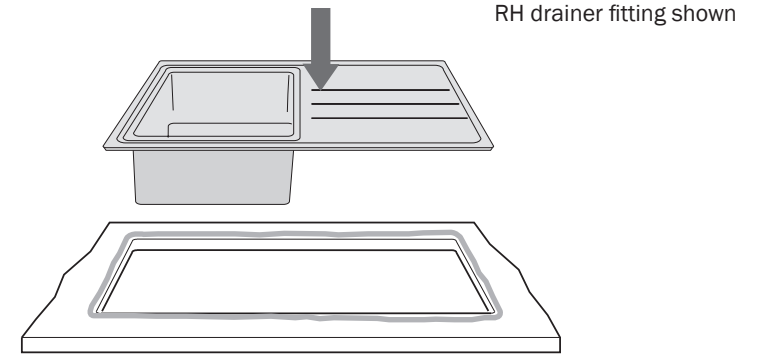

- 6

Fit brackets to the sink using the screws provided.

Clip locations and order of tightening with sink in position

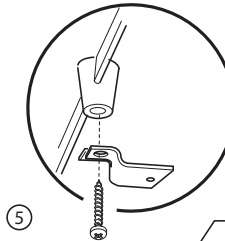
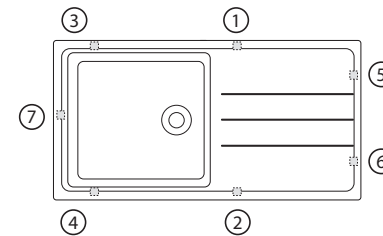

Wipe away excess silicone

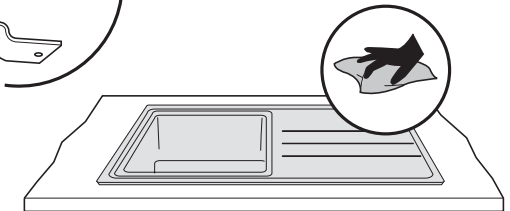

Note: Once tightened, brackets can be secured up into the underside of the worktop. Screws are not supplied.